

The best preparation!

Take the following points into account before you order a screen.

1. How will the screen be installed?

You can choose:

- ☐ **A** Outside mount - mounting on the wall (see page 3)
- ☐ **B** Inside mount - mounting in the window frame (see page 4)

2. How do I measure the correct order width of the screen?

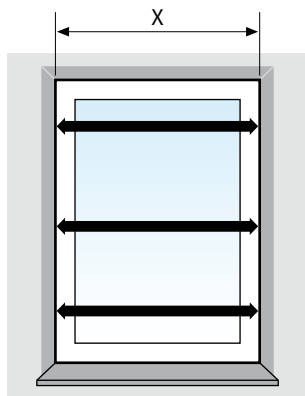

Measure the width (X) between the walls in mm.
To be sure, do this at least at three places; the wall can be skewed.

A Outside mount

V550 XS / S / M / L:

Order width (W) = the largest measured width (X) + 92 mm

V599/V599R/V599 XL:

Order width (W) = the largest measured width (X) + 80 mm

V540/V599 L:

Order width (W) = the largest measured width (X) + 94 mm

B Inside mount

Order width (W) = the smallest measured width (X) - 5 mm

3. How do I measure the correct order height of the screen?

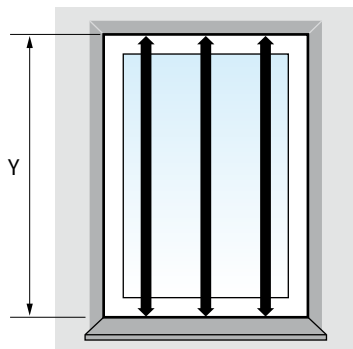

Measure the height (Y) from top to the bottom of the windowsill in mm. To be sure, do this at least at three places.

A Outside mount

V550 XS with lower beam 'S':

Order height (H) = the largest measured height (Y) + 138 mm

V550 S with lower beam 'S':

Order height (H) = the largest measured height (Y) + 148 mm

V550 M with lower beam 'S':

Order height (H) = the largest measured height (Y) + 158 mm

V550 L with lower beam 'S':

Order height (H) = the largest measured height (Y) + 178 mm

WARNING!

Starting from a screen width or screen height 3000 [mm], Verano® advises to use lower beam 'L'.

V550 XS with lower beam 'L':

Order height (H) = the largest measured height (Y) + 157 mm

V550 S with lower beam 'L':

Order height (H) = the largest measured height (Y) + 167 mm

V550 M with lower beam 'L':

Order height (H) = the largest measured height (Y) + 177 mm

V550 L with lower beam 'L':

Order height (H) = the largest measured height (Y) + 197 mm

V540:

Order height (H) = the largest measured height (Y) + 160 mm

V599/V599R:

Order height (H) = the largest measured height (Y) + 166 mm

V599 L:

Order height (H) = the largest measured height (Y) + 195 mm

V599 XL:

Order height (H) = the largest measured height (Y) + 236 mm

B Inside mount

Order height (H) = the smallest measured height (Y)

4. Choose the controlling side; left or right?

Stand in front of the window frame on the outside. Determine if you want to control the screen on the left or right side.

Important!

Also attentively read the attention points on page 9 and 10 to see if they apply to you.

A Outside mount

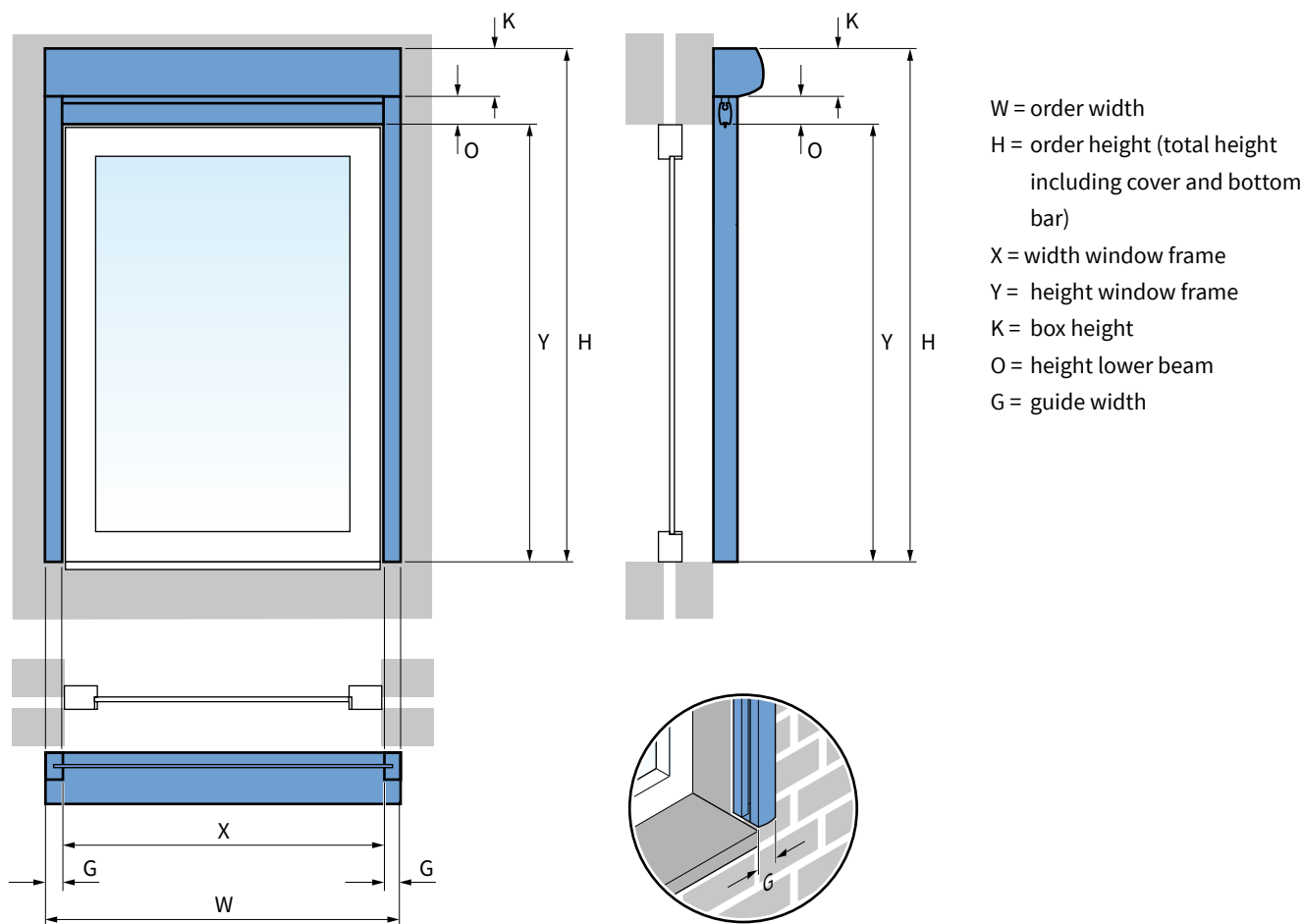

When mounted outside, the screen cover and guides are mounted on the wall.

Width

To determine the correct width of the screen, you take the largest measured width (X) (see page 1) plus two times the width of the guide (G) plus 10 mm.

$$\text{Order width (W)} = X + (2 \times G + 10)$$

Height

Take the largest measured height (Y) (see page 2).

You need the total height of the screen for the ordering size. This is the height (Y) of the window frame plus the height of the screen cover (K) and lower beam (O) plus 20 mm.

$$\text{Order height (H)} = Y + (K + O + 20)$$

Ritzscreen® V540:	$K + O = 95 + 45 + 20 = 160 \text{ mm}$
Ritzscreen® V599/V599R:	$K + O = 101 + 45 + 20 = 166 \text{ mm}$
Ritzscreen® V599 L:	$K + O = 130 + 45 + 20 = 195 \text{ mm}$
Ritzscreen® V599 XL:	$K + O = 151 + 65 + 20 = 236 \text{ mm}$

You can find the specific measurements in the specifications on page 5 and 8.

V550 with lower beam 'S'

V550 XS:	$K + O = 85 + 33 + 20 = 138 \text{ mm}$
V550 S:	$K + O = 95 + 33 + 20 = 148 \text{ mm}$
V550 M:	$K + O = 105 + 33 + 20 = 158 \text{ mm}$
V550 L:	$K + O = 125 + 33 + 20 = 178 \text{ mm}$

V550 with lower beam 'L'

V550 XS:	$K + O = 85 + 52 + 20 = 157 \text{ mm}$
V550 S:	$K + O = 95 + 52 + 20 = 167 \text{ mm}$
V550 M:	$K + O = 105 + 52 + 20 = 177 \text{ mm}$
V550 L:	$K + O = 125 + 52 + 20 = 197 \text{ mm}$

B Inside mount

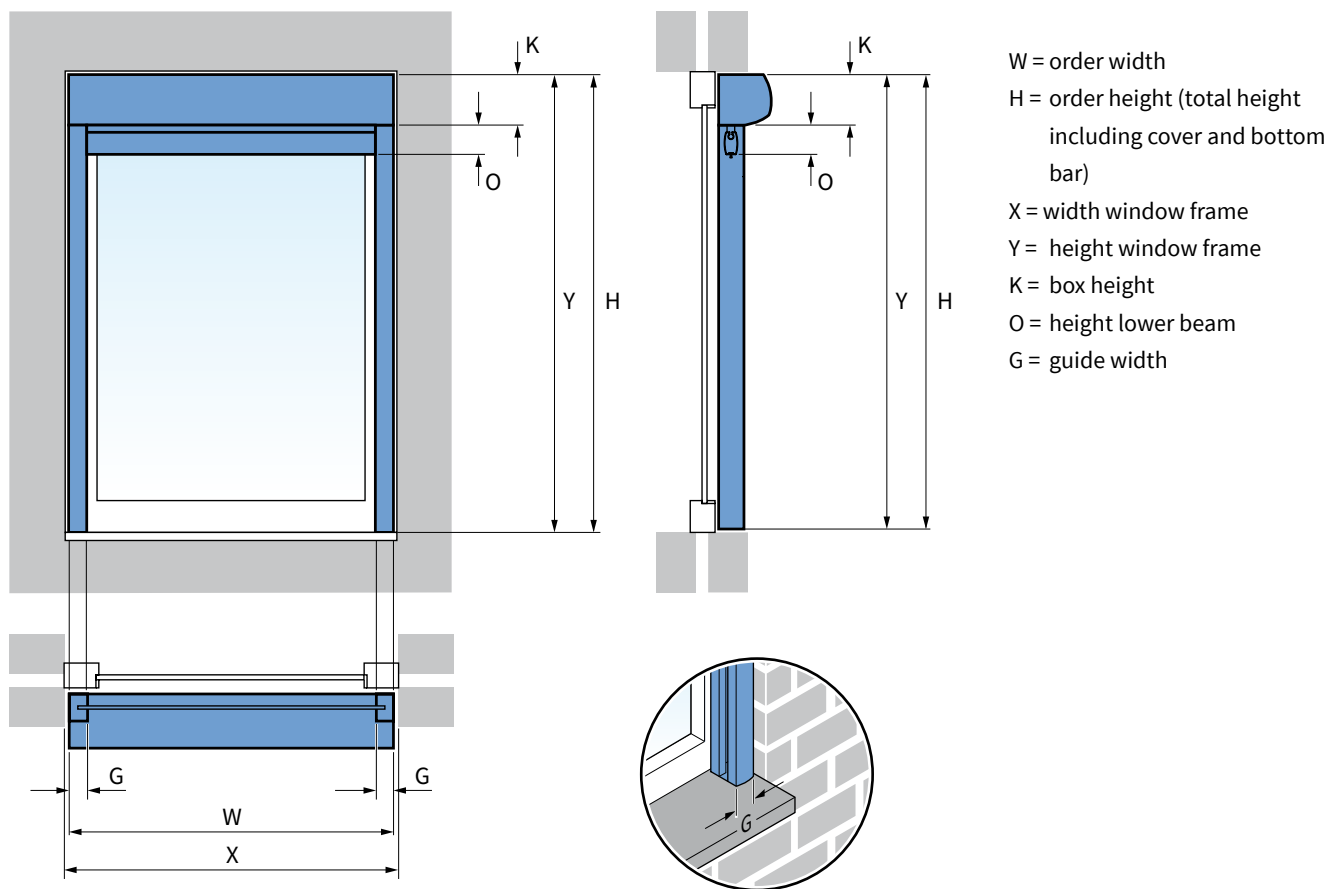

When mounted inside, the screen cover and guides are placed in the window frame. The guides will be mounted on the wall.

Width

To determine the correct width of the screen, take the smallest measured width (X) (see page 1) minus 5 mm horizontal adjustment for mounting.

Order width (W) = X - 5 mm

Height

Take the smallest height (Y) (see page 2). This is the total height of the window frame including cover (K) and lower beam (O).

Order height (H) = Y

Attention! Inside mount is not possible when you have patio windows and/or doors.

Specifications Ritzscreens®

Ritzscreen® V540

Measurements in mm

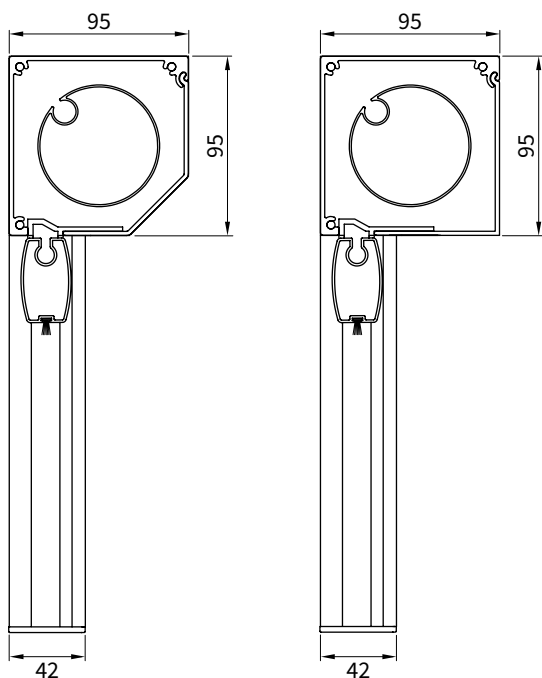

section cover (K), lower beam (O) and guide (G)

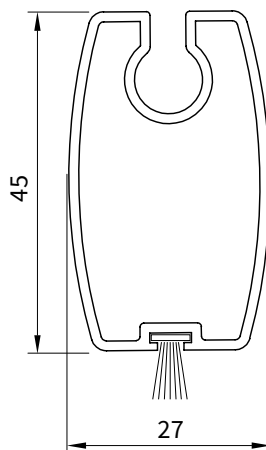

section lower beam (O)

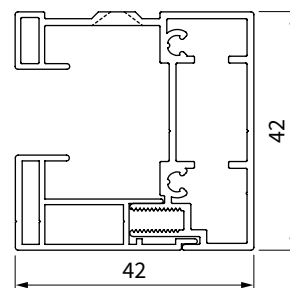

section guide (G) right

Maximum ordering size V540 = 3000 mm

Attention! The Ritzscreen® V540 is delivered with guides provided with predrilled mounting holes in the back profile. Only use flat counter-sunk screws.

Ritzscreen® V599

Ritzscreen® V599R

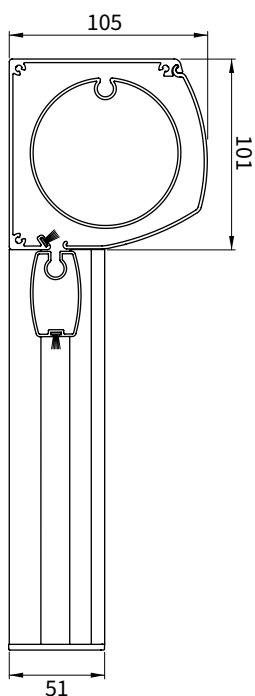

section cover (K), lower beam (O) and guide (G)

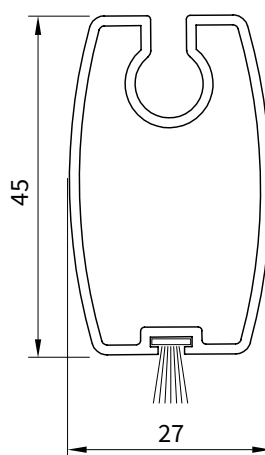
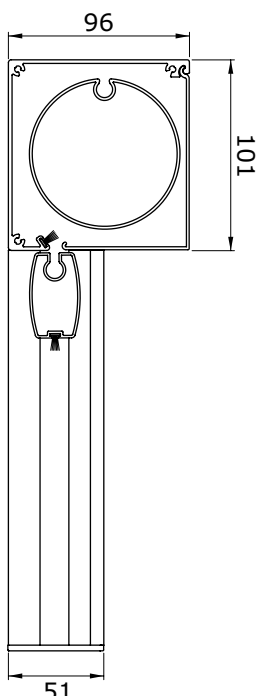

section lower beam (O)

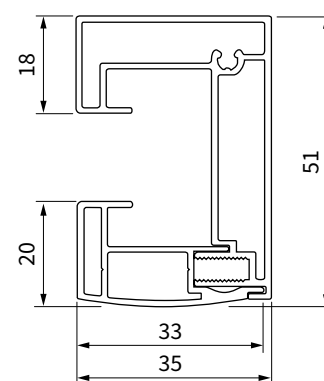

section guide (G) right

maximum ordering height V599 = 3500 mm

maximum ordering height V599R = 3100 mm

Specifications Ritzscreens®

Measurements in mm

Ritzscreen® V550 XS

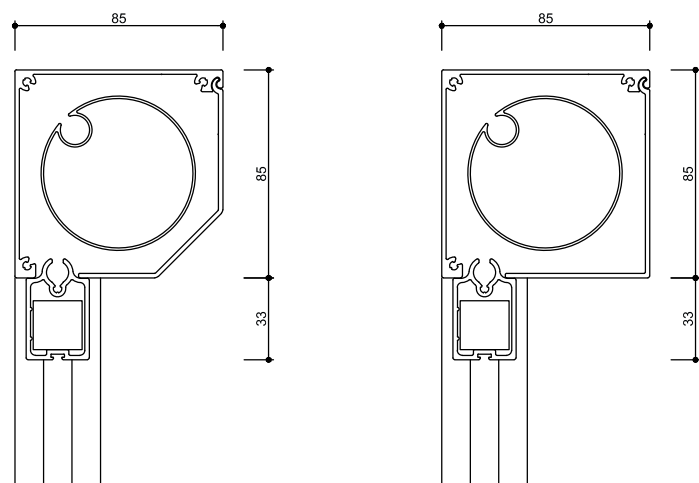

section cover (K), lower beam (O) and guide (G)

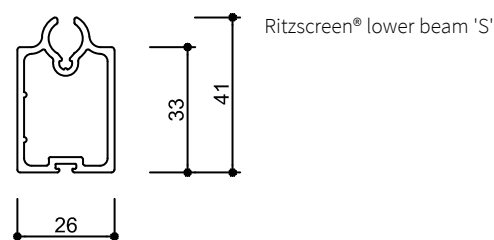

Ritzscreen® lower beam 'S'

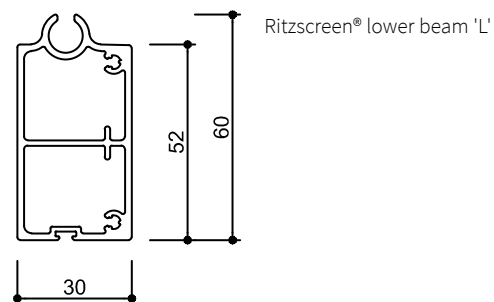

Ritzscreen® lower beam 'L'

Ritzscreen® V550 S

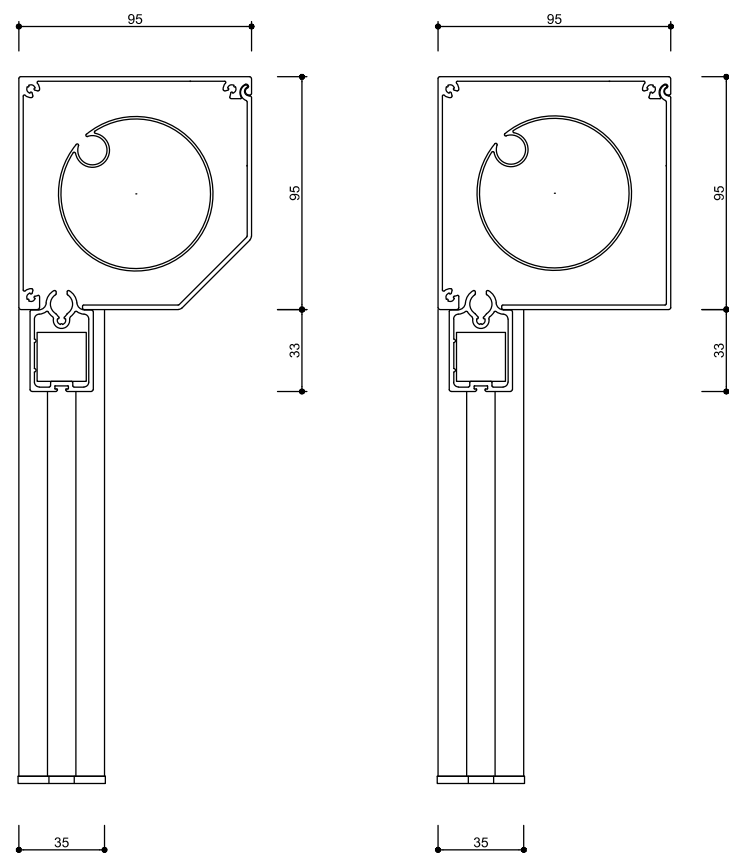

section cover (K), lower beam (O) and guide (G)

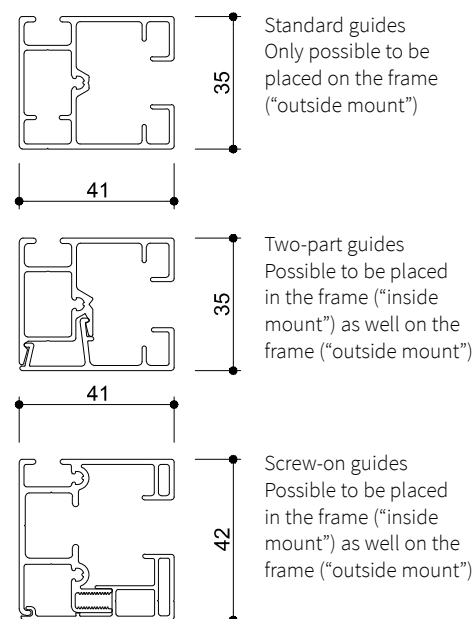

Standard guides
Only possible to be placed on the frame ("outside mount")

Two-part guides
Possible to be placed in the frame ("inside mount") as well on the frame ("outside mount")

Screw-on guides
Possible to be placed in the frame ("inside mount") as well on the frame ("outside mount")

maximum ordering height V550 XS = 1900 mm

maximum ordering height V550 S = 3000 mm

maximum ordering height V550 M = 3500 mm

maximum ordering height V550 L = 5000 mm

Specifications Ritzscreens®

Measurements in mm

Ritzscreen® V550 M

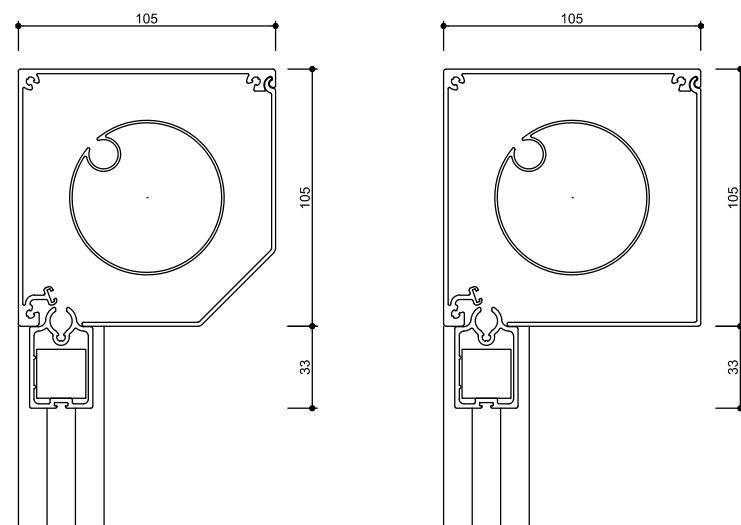

section cover (K), lower beam (O) and guide (G)

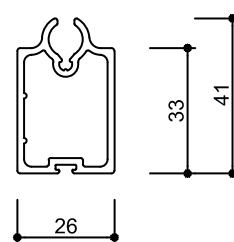

Ritzscreen® lower beam 'S'

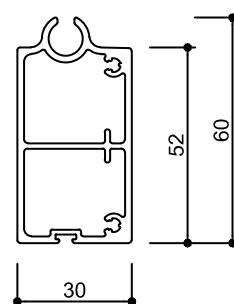

Ritzscreen® lower beam 'L'

Ritzscreen® V550 L

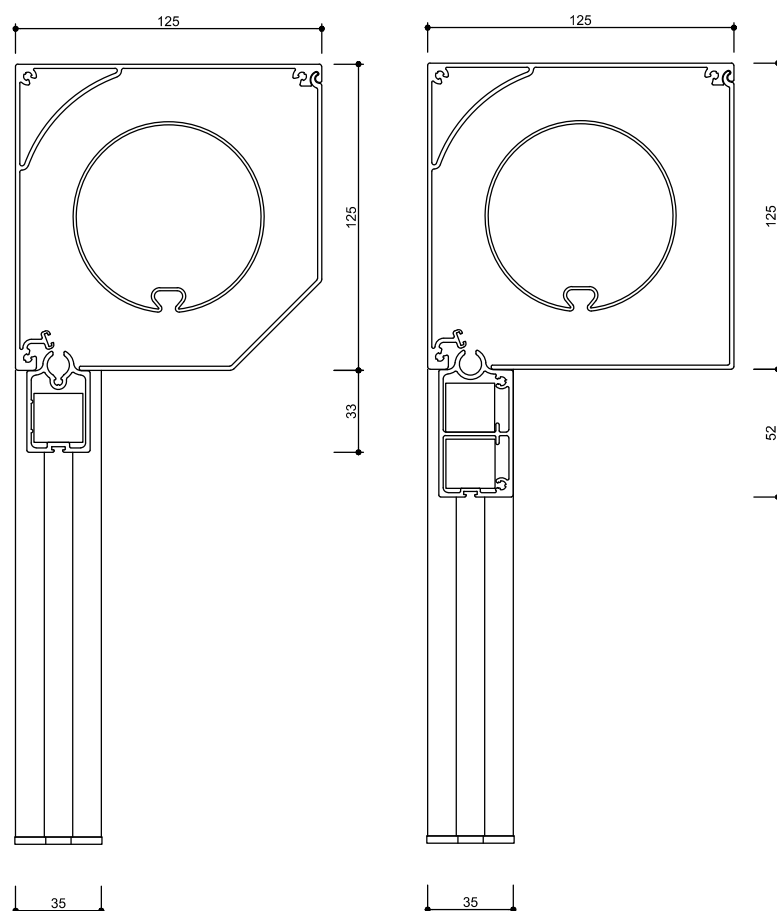

section cover (K), lower beam (O) and guide (G)

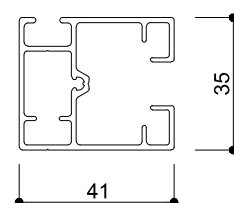

Standard guides
Only possible to be placed on the frame ("outside mount")

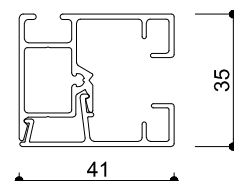

Two-part guides
Possible to be placed in the frame ("inside mount") as well on the frame ("outside mount")

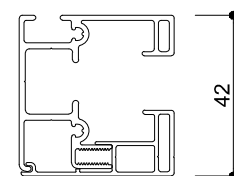

Screw-on guides
Possible to be placed in the frame ("inside mount") as well on the frame ("outside mount")

maximum ordering height V550 XS = 1900 mm
maximum ordering height V550 S = 3000 mm
maximum ordering height V550 M = 3500 mm
maximum ordering height V550 L = 5000 mm

Specifications Ritzscreens®

Ritzscreen® V599 L

Measurements in mm

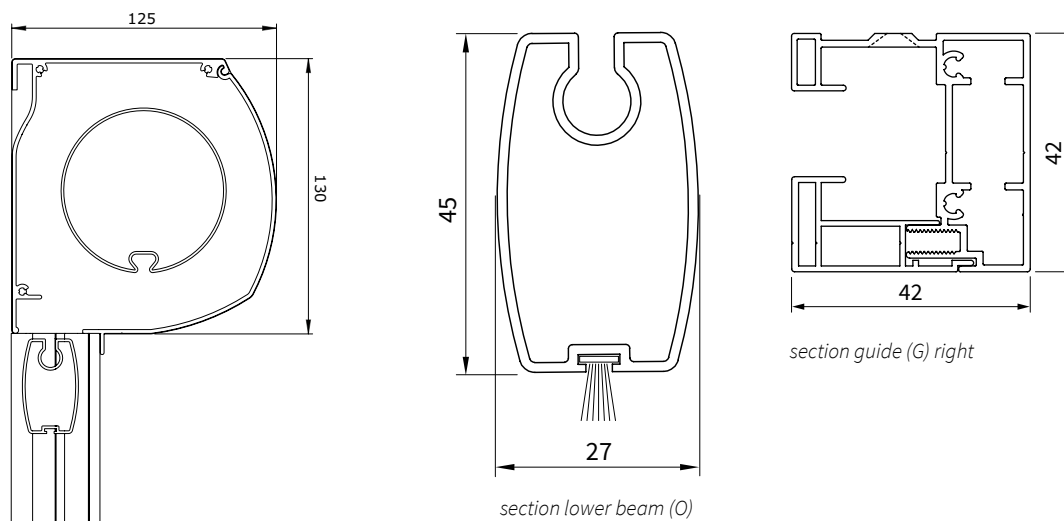

section cover (K), lower beam (O) and guide (G)

maximum ordering height V599 L = 5000 mm

Attention! The Ritzscreen® V599 L is delivered with guides provided with predrilled mounting holes in the back profile. Only use flat counter-sunk screws.

Ritzscreen® V599 XL

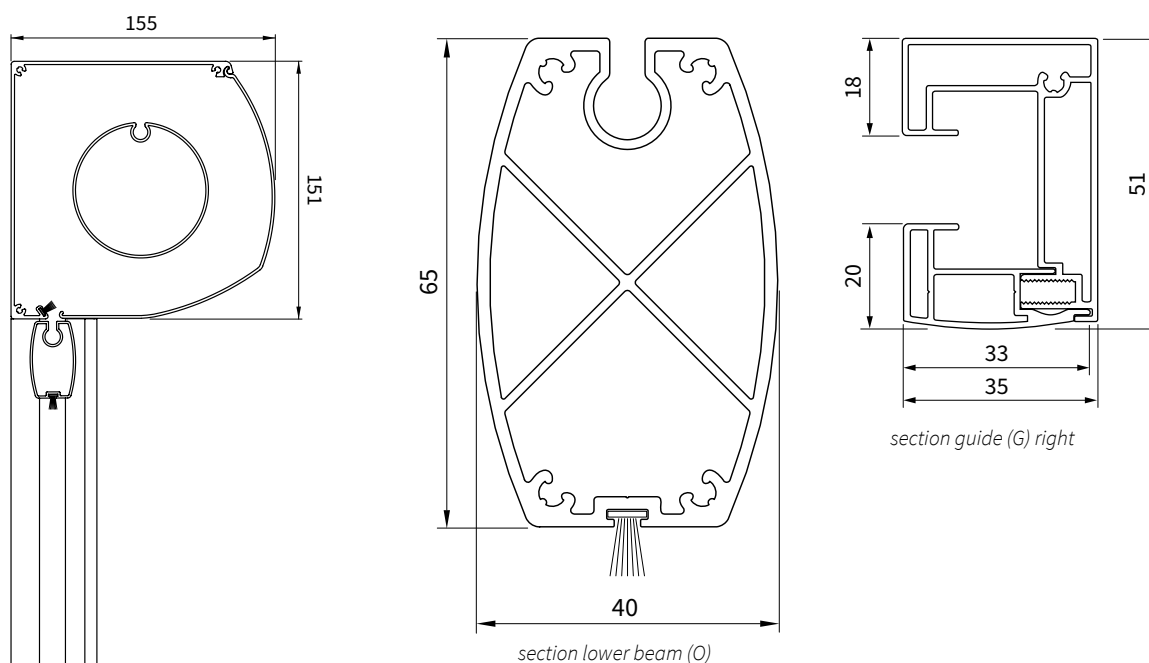

section cover (K), lower beam (O) and guide (G)

maximum ordering height V599 XL = 6000 mm

Extra attention points

Determine if one of the situations below applies to you.

1. Outward opening windows and/or doors

Choose 'outside mount' when you have outward opening windows and/or doors.

The screen cover and the lower beam are mounted above the window frame, on the wall. The window or door can be opened without touching the lower beam of the screen.

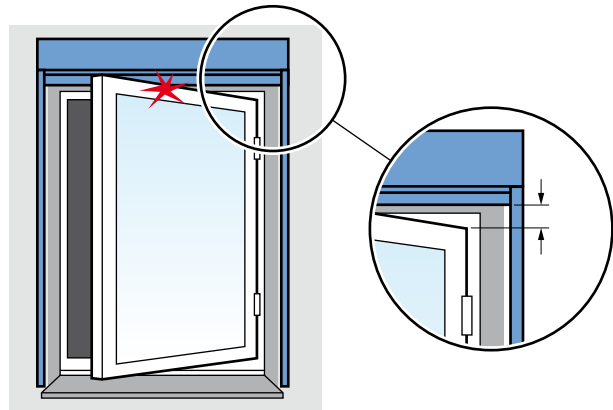

2. Sloping windowsill

When you choose for 'outside mount' and you have a sloping windowsill, take into account that you need extra length in height.

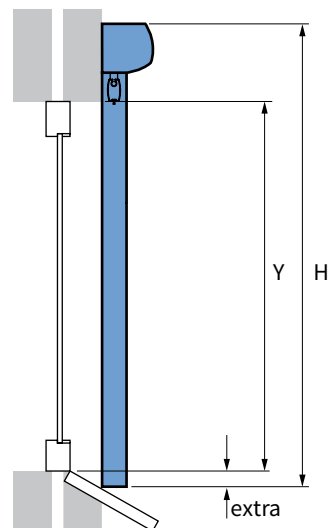

3. Dormer or lower gutter

When mounting a screen on a dormer or house-extension take into account that the space between the top of the window frame and the gutter or eaves is large enough for mounting the screen cover.

If there is too little space for the cover, you can choose 'inside mount' and place the screen in the window frame. Keep outward opening windows and doors in mind.

In some situations, a screen can not be placed.

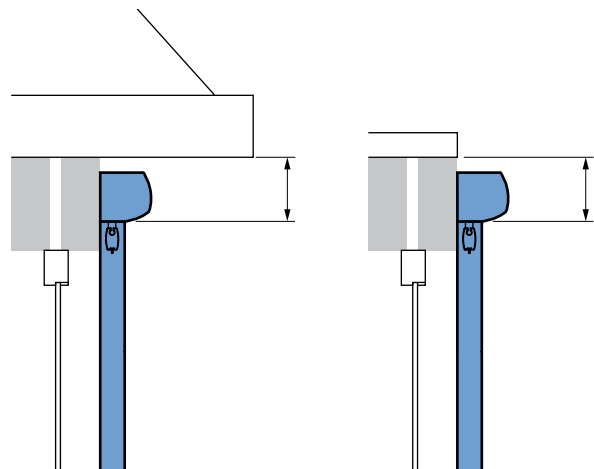

4. Protruding obstacles

Protruding obstacles, like outward opening doors and/or windows, ventilation grids, stones or latches can damage the screen or stop the screen from closing correctly.

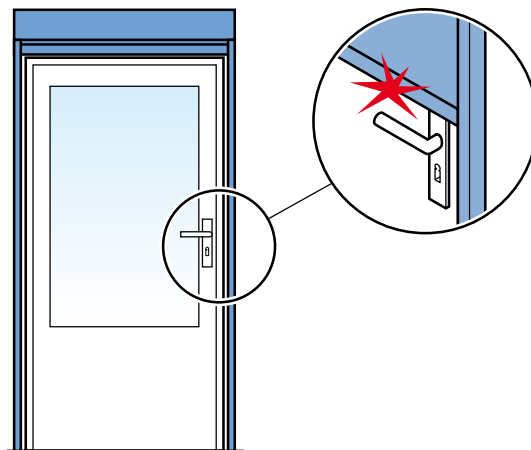

General warning measuring

When you measure the Verano® product yourself, that is for your own risk. You are responsible for measuring the right sizes. Use this instruction only as a help and only for measuring this specific Verano® product.

Not sure about your measuring and don't want to run any risk of ordering a wrong product? Use the measuring service as provided by your Verano® partner.