

## The best preparation!

Take the following points into account before you order a screen.

### 1. How will the screen be installed?

You can choose:

- ☐ **A** Outside mount / Installation on the wall – the box and guides are installed on the wall (see page 2).
- ☐ **B** Inside Mount / Installation between two walls – the box and guides are installed to the window frame between two walls (see page 3).
- ☐ **C** Combination of A and B – the box is installed on the wall and the guides between two walls (see page 4).

### 2. How do I measure the correct width of the screen?

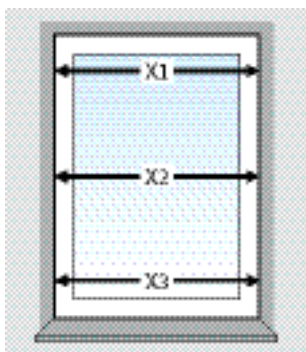

Measure the width (X) between the walls in mm.

To be sure, do this at least at three positions; the wall can be skewed.

- A** Order width (W) = the largest measured width (X) + 60 mm
- B** Order width (W) = the smallest measured width (X) - 10 mm
- C** Order width (W) = the smallest measured width (X) - 5 mm

### 3. How do I measure the correct height of the placeable screen?

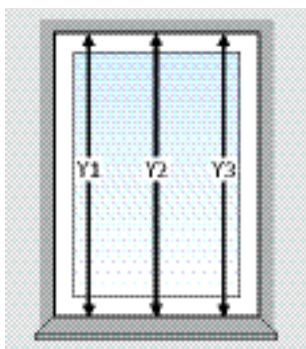

Measure the height (Y) from top to the bottom of the windowsill in mm.

To be sure, do this at least at three places.

- A** en **C**  
Standard screen:  
**Order height (H) = the largest measured height (Y) + 85 mm**  
Standard XL screen:  
**Order height (H) = the largest measured height (Y) + 95 mm**
- B** Order height (H) = the smallest measured height (Y) - 5 mm

### 4. Choose the control side: left or right?

Stand in front of the window frame on the outside. Determine if you want to control the screen on the left or right side.

#### Important!

Also attentively read the attention points on page 6 and 7 to see if they apply to you.

## A Outside mount / Installation on the wall

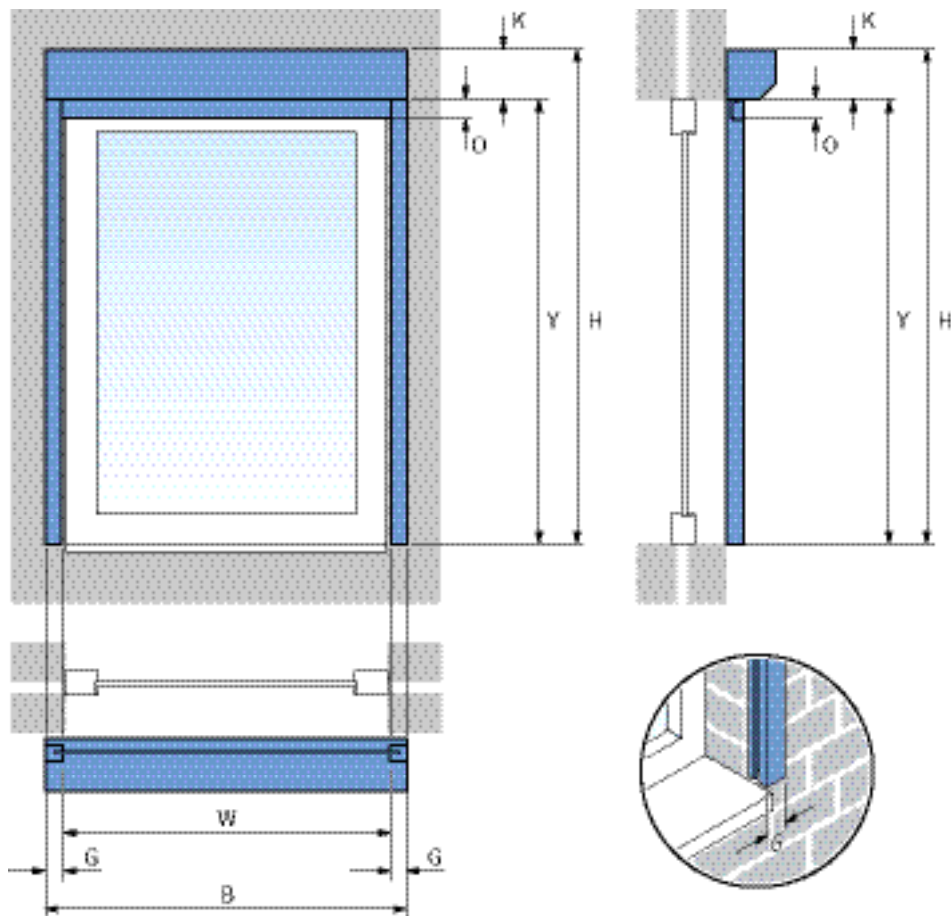

W = order width  
 H = order height (total height including box)  
 X = width window frame  
 Y = height window frame  
 K = box height  
 O = height bottom bar  
 G = guide width

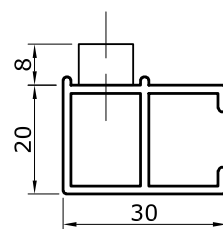

Sectional view left HTF guide

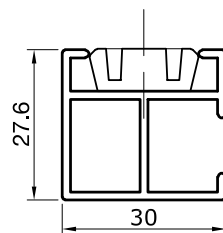

Sectional view left HTF + CLICK guide

If the screen is installed on the wall, both the box as the guides are installed on the wall. To do this, **HTF guides** need to be used.

### Width

Take the largest measured width size (X) of the window frame plus two times the width size of the guide (G).

**Order width (W) = the largest measured width size (X) + 60 mm.**

### Height

Take the largest measured height size (Y) of the window frame plus the height of the box (K).

**Screen V585 -----> Order height (H) = the largest measured height size (Y) + 85 mm**

**Screen V595 -----> Order height (H) = the largest measured height size (Y) + 95 mm**



### Attention!

Take patio doors and/or windows into account. The bottom bar (O) protrudes 35 mm below the box when the screen fabric is pulled up. Please read the attention points on page 6 and 7.

## B Inside mount / Installation between two walls

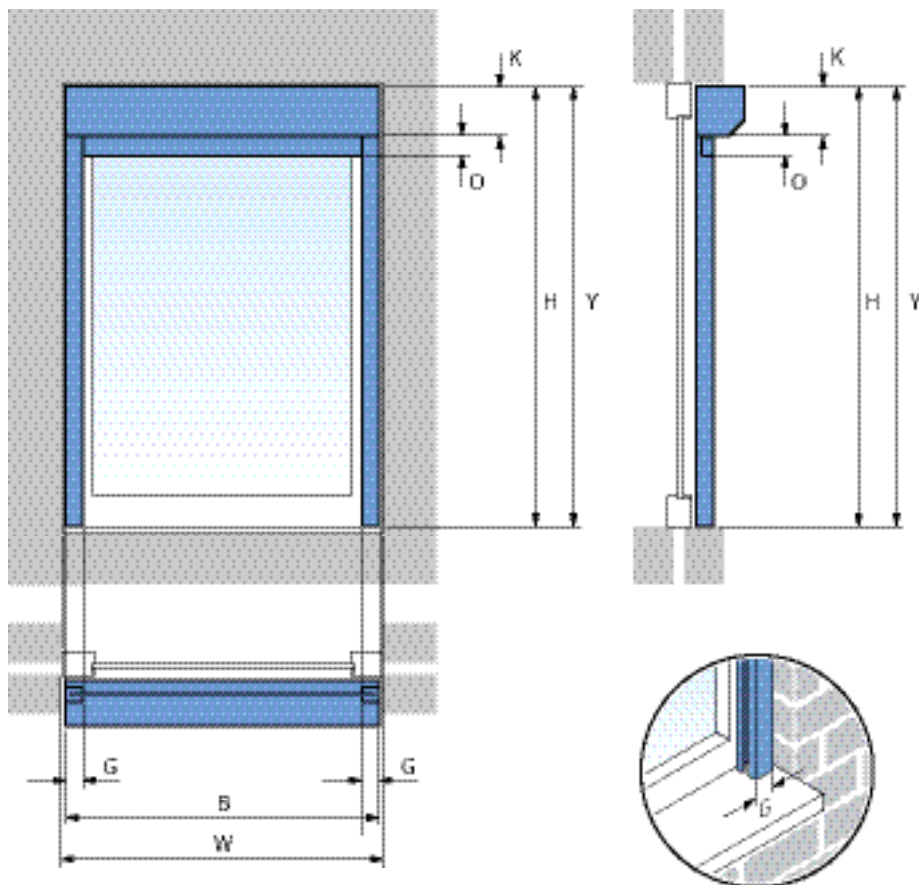

W = order width  
 H = order height (total height including box)  
 X = width window frame  
 Y = height window frame  
 K = box height  
 O = height bottom bar  
 G = guide width

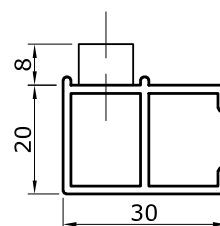

Sectional view left HTF guide

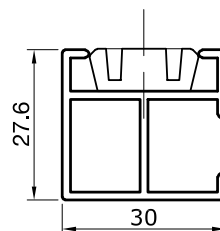

Sectional view left HTF + CLICK guide

If the screen is installed between two walls, both the box as the guides are installed between two walls on the window frame. To do this, **HTF guides** need to be used.

### Width

Take the smallest measured width size (X) of the window frame en subtract 10 mm for installation slack.

**Order width (W) = the smallest measured width size (X) – 10 mm**

### Height

**Order height (H) = the smallest measured height size (Y)**



### Attention!

Installation between two walls is not possible when you have patio windows and/or doors.

## C Combination

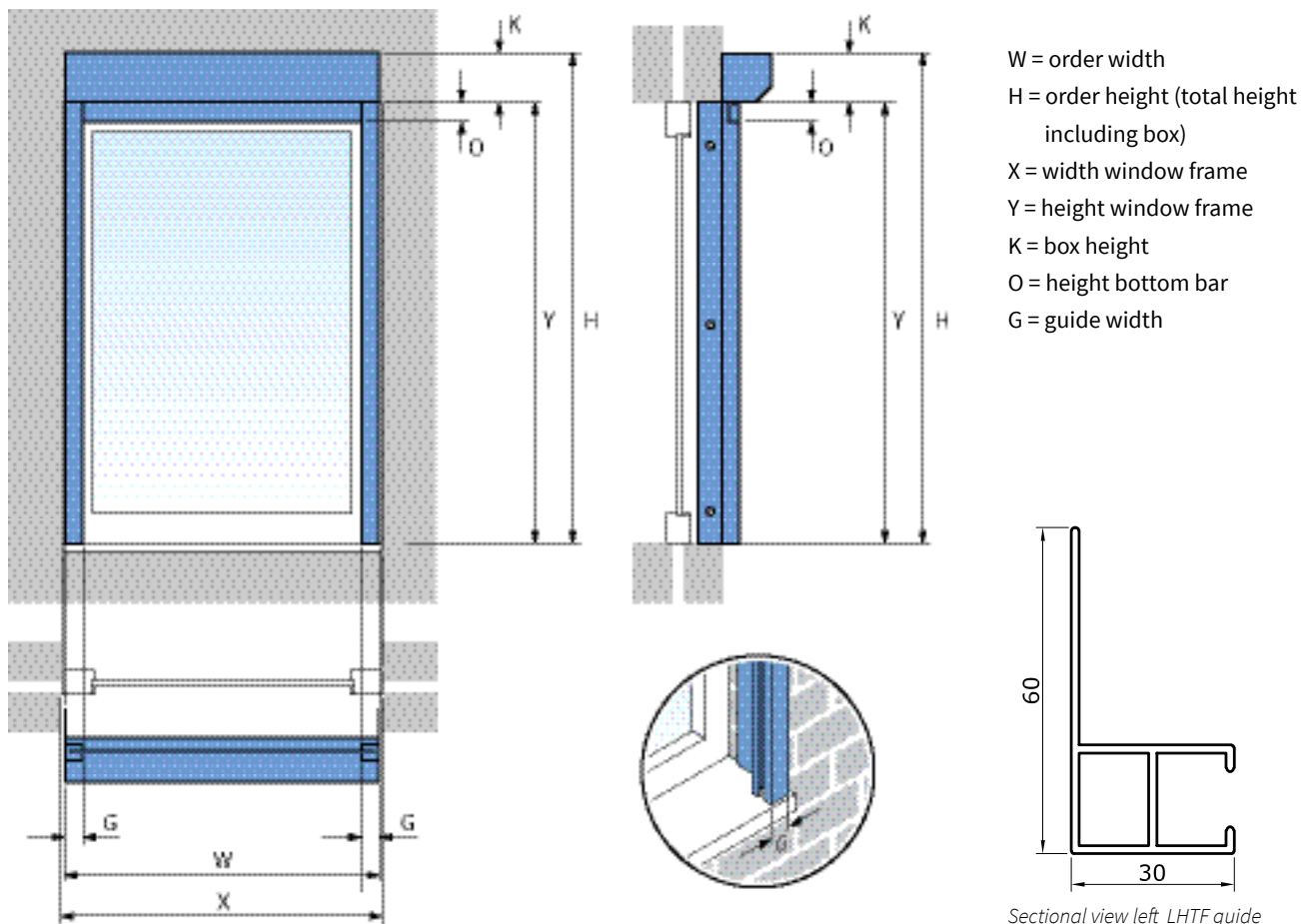

Using this kind of installation, the box will be installed above the window frame on the wall. The guides are installed between two walls. To do this, **LHTF guides** need to be used.

### Width

Take the smallest measured width size (X) of the window frame and subtract 5 mm for installation slack.

**Order width (W) = the smallest measured width size (X) – 5 mm**

### Height

Take the largest measured height size (Y) of the window frame plus the height of the box (K).

**Screen V585 -----> Order height (H) = the largest measured height size (Y) + 85 mm**

**Screen V595 -----> Order height (H) = the largest measured height size (Y) + 95 mm**



### Attention!

Take patio doors and/or windows into account. The bottom bar (O) protrudes 35 mm below the box when the screen fabric is pulled up. Please read the attention points on page 6 and 7.

## Specifications box (K)

### Screen V585

Sizes in mm

sloped

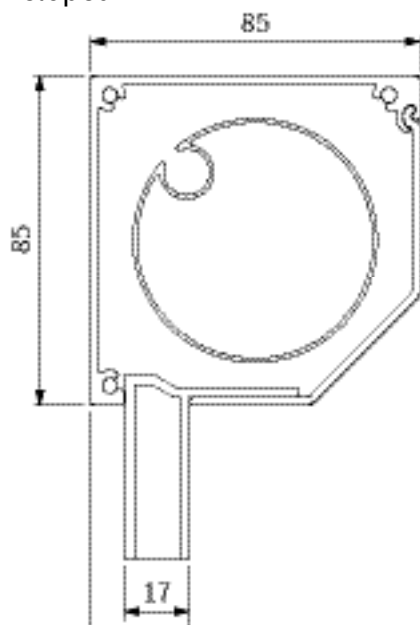

Sectional view box

straight

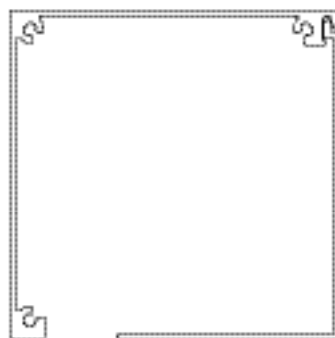

Maximum order height = 2100 mm

### Screen V595

sloped

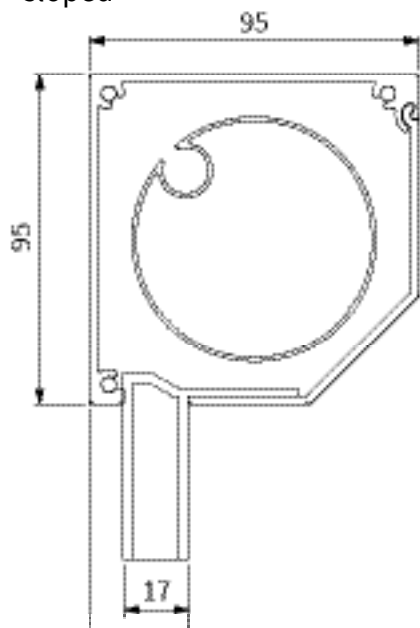

Sectional view box

straight

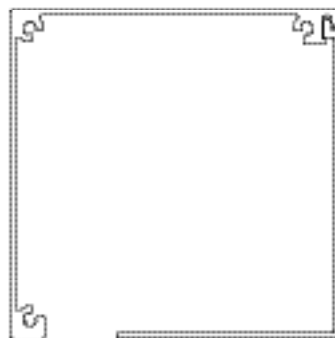

Maximum order height = 2800 mm

## Specifications guides (G)

Sizes in mm

### HTF

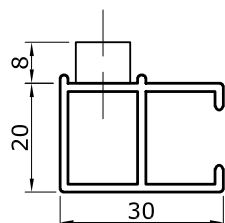

Sectional view left HTF guide

### HTF + CLICK

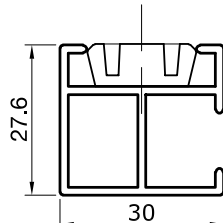

Sectional view left HTF + CLICK guide

### HTF + CLICK + LIP

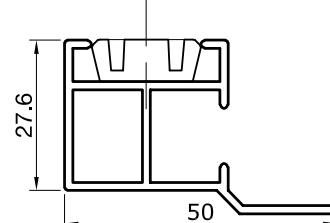

Sectional view left HTF + CLICK + LIP guide

### LHTF

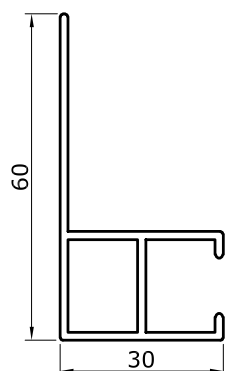

Sectional view left LHTF guide

### LHTF + LIP

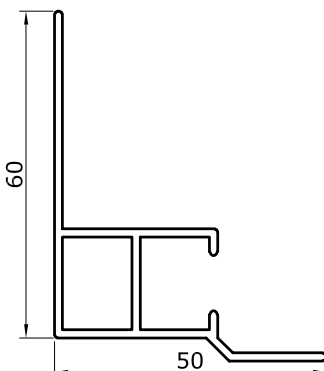

Sectional view left LHTF + LIP guide

### LIP

The fabric is extra protected against windblown due to the extra lip on the guide.

## Extra attention points

Determine if one of the situations below applies to you.

### 1. Outward opening windows and/or doors

Choose 'outside mount' when you have outward opening windows and/or doors.

The screen box and the bottom bar are mounted above the window frame, on the wall. The window or door can be opened without touching the bottom bar of the screen.

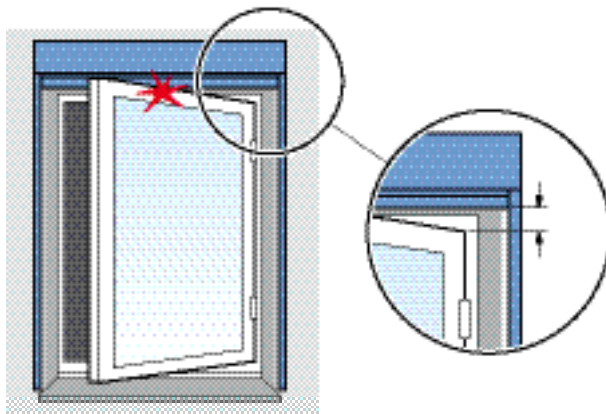

### 2. Sloping windowsill

When you choose for 'outside mount' and you have a sloping windowsill, take into account that you need extra length in height.

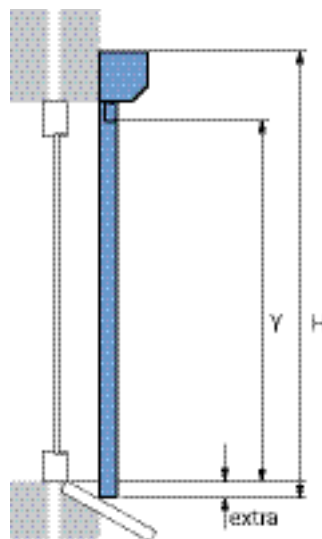

### 3. Dormer or lower gutter

When mounting a screen on a dormer or house-extension take into account that the space between the top of the window frame and the gutter or eaves is large enough for mounting the screen cover.

If there is too little space for the screen box, you can choose 'inside mount' and place the screen in the window frame. Keep outward opening windows and doors in mind. In some situations, a screen can not be placed.

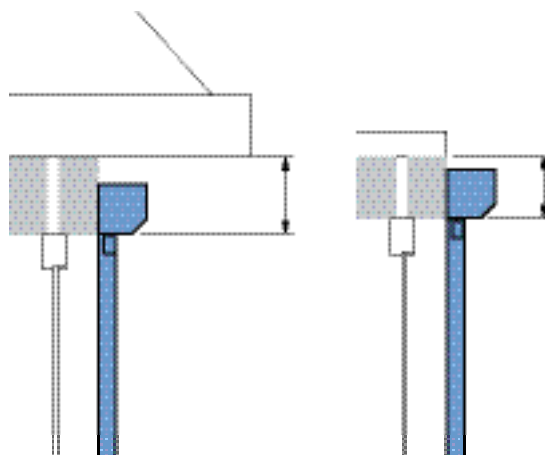

#### 4. Protruding obstacles

Protruding obstacles, like outward opening doors and/or windows, ventilation grids, stones or latches can damage the screen or stop the screen from closing correctly.

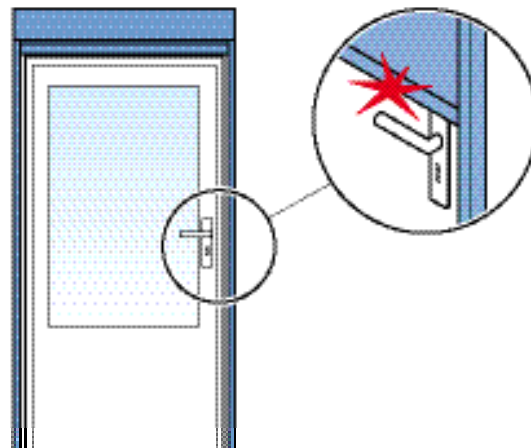

#### General warning measuring

When you measure the Verano® product yourself, that is for your own risk. You are responsible for measuring the right sizes. Use this instruction only as a help and only for measuring this specific Verano® product.

Not sure about your measuring and don't want to run any risk of ordering a wrong product? Use the measuring service as provided by your Verano® partner.