



INSTALLATION MANUAL

# **ROLLER DOORS**

RV55 - RV77

## Content

### Package 1

1. Armor
2. Cap with axle
3. Guides
4. Suspension springs
5. Covers
6. Control
  - a. Electrical: switch + plug
  - b. Remote controlled: remote control + plug

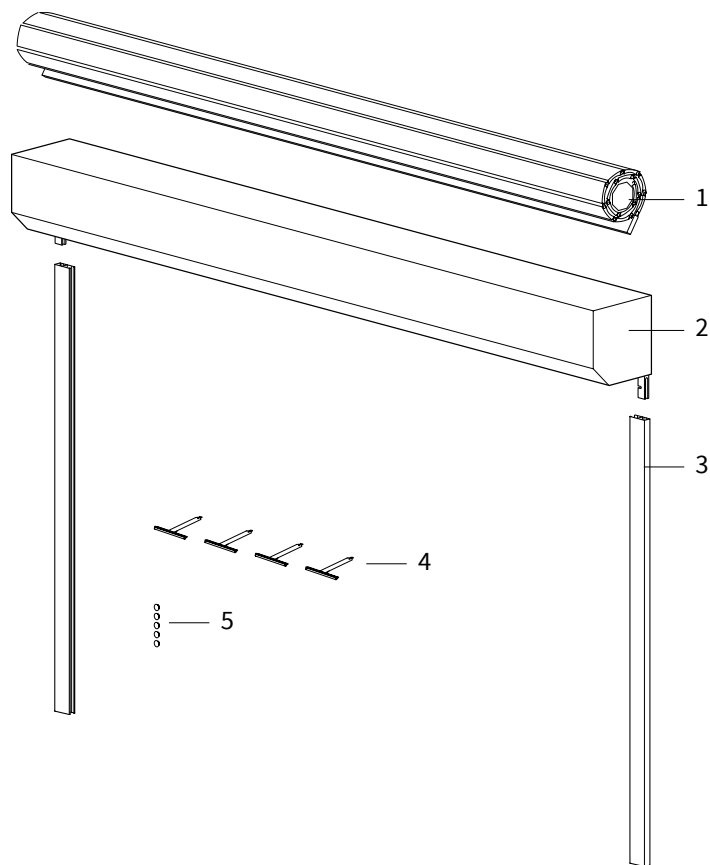

## Necessary tools

- Drilling machine
- Metal drill 6/10 mm
- Masonry drill 6/10 mm
- Crosshead screwdriver
- Tapeline
- Level
- Pencil
- Cardboard or cloth

In case of electrical control:

- Nippers
- Flathead screwdriver

## **Important before installation**

### **General warning**

Installing the Verano® product yourself is at your own risk. Only use this instruction as a tool and for the installation of this specific Verano® product. If you cannot install the product yourself, you can always opt for professional installation. The installation team of Verano® is pleased to help you.

### **Be careful for damages**

Don't use a knife or any other sharp object when opening the packing. This may cause damage to the content of the package. Put the content of the package on a soft surface. Be careful when drilling, falling drill cuttings can cause damages.

Check if the window frame or façade is flat and smooth.

## 1. Instruction placing roller shutter (outside)

### 1.1 Marking the installation-holes

1. Place the left guide, at the right height, to the façade.

**Attention!** The guides have an open and closed side. The open side needs to be on the window side and conducts the slats. You may not drill in the open side!

2. Mark the installation-holes on the guides. Make sure that the installation -holes are in a stone and not in the seam!  
The first hole at the fixation point of the box, needs to be drilled at least 15 cm from the edge.  
This space must be kept free for the cover bracket.

3. Place the right guide at the right height and width against the wall and mark the installation-holes the same way.

**Attention!** The left- and right guide need to be exactly levelled at the top and bottom. Use a shelf and level to check this.

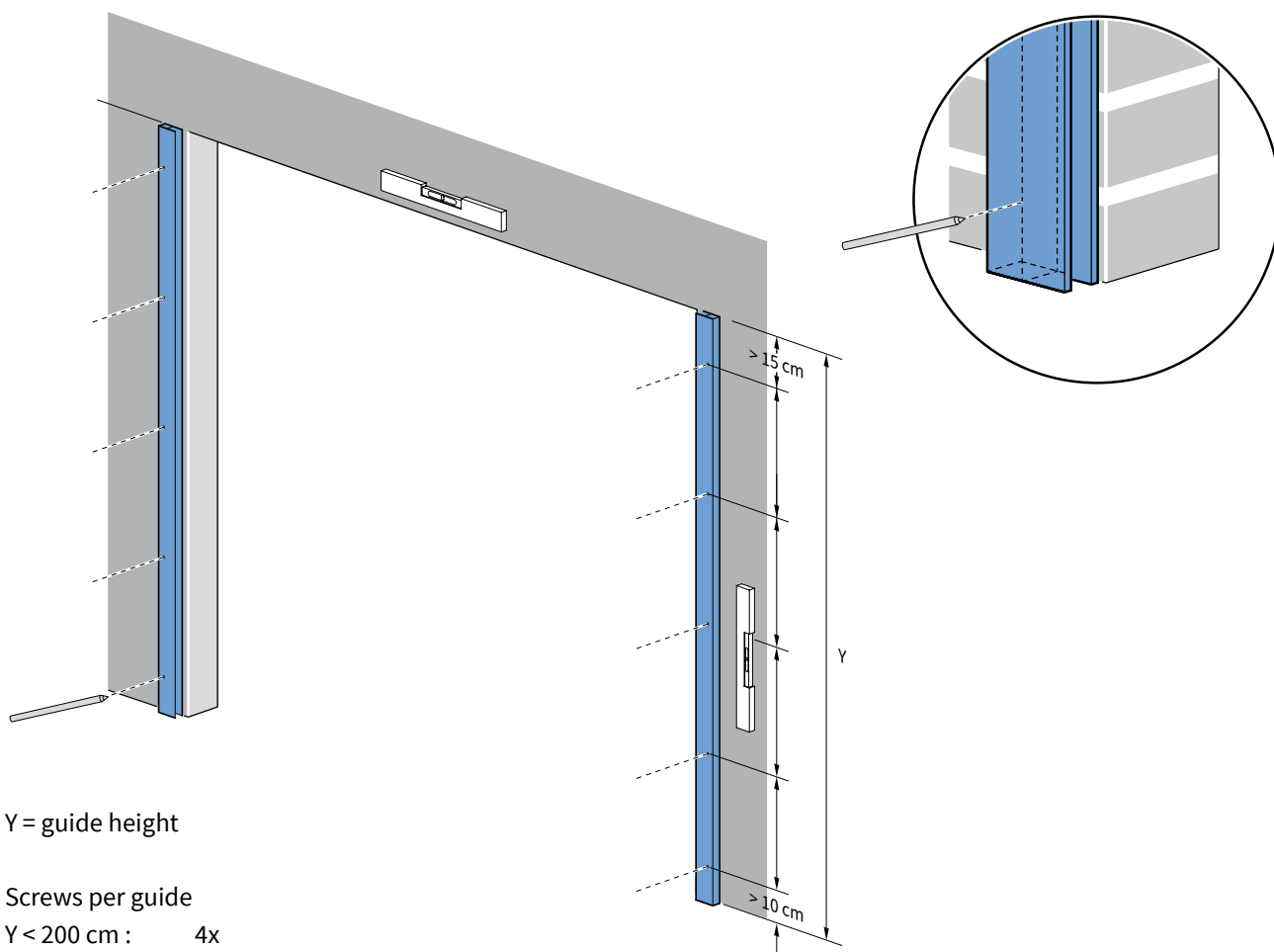

## 1.2 Drilling installation-holes in the guides

1. First drill a hole of 6 mm through both layers of the guide.
2. After that, drill the top hole with a 10 mm drill. This is the side that isn't placed to the wall.  
Later, the plastic screw caps are placed here.

Roller door RV 55: guide UPH 240 or UPH 260, with rubber closure strip.

Roller door RV 77: guide UPH 89, with brush closure strip.

Tip: don't remove the protection foil to prevent damages to your roller door.

### RV55

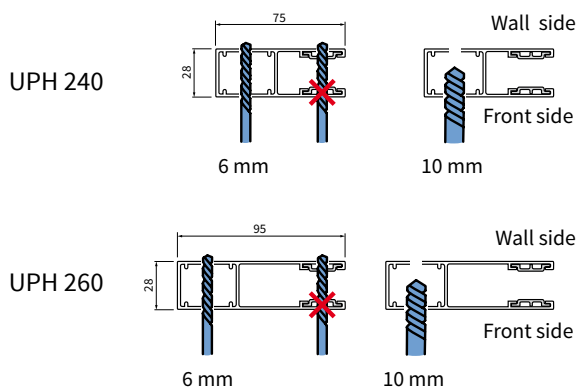

### RV77

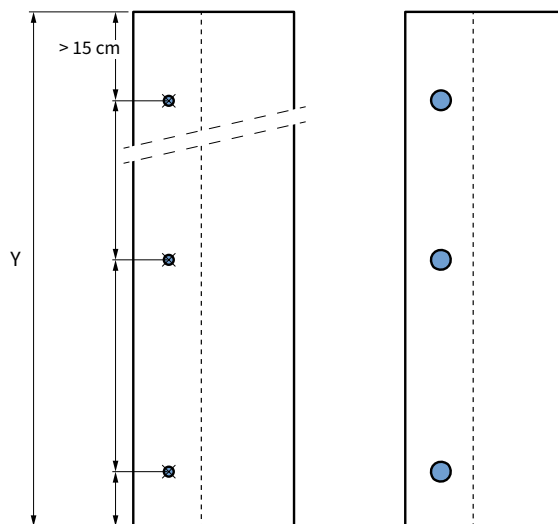
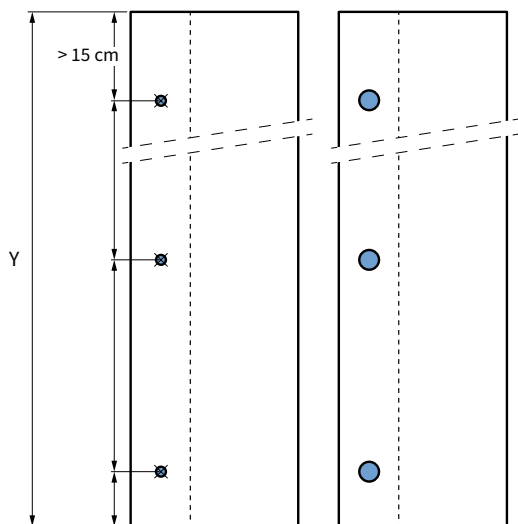
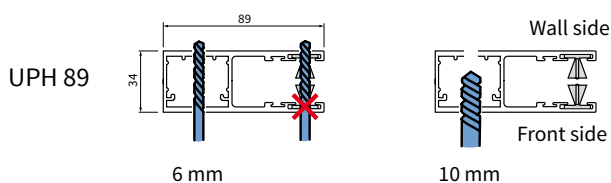

Y = guide height

### 1.3 Cutting and bending of the guides before installation

In order to ensure that the armor runs smoothly into the guides, cut at the upper side a maximum of 50 mm in the guide. Bending this piece up to 44 mm forward.

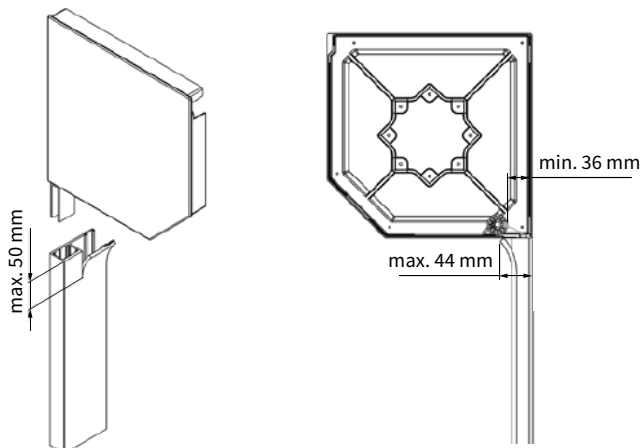

### 1.4 Installation of the guides

1. Place the guides back in the façade. Make sure that the guides are perpendicular and run parallel to the wall. You can mark the drill holes according to the holes in the guides.
2. Drill the final holes. Take the size of the screws and wall plugs you are going to use into account.
3. Screw the guides and check if the guides are equally level both left and right.

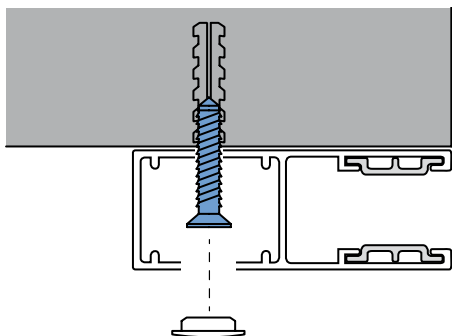

### Caution! In case of low gutter or eaves.

When a roller shutter needs to be installed below a low ceiling or eaves, it is necessary to first place the cap on the guides before the guides are screwed on to the wall.

Be extra careful with the installation. The cover brackets are vulnerable! To prevent breaking of the cover brackets, you always need to lift the roller door with two persons at the fixation point of the cap on the side guides.

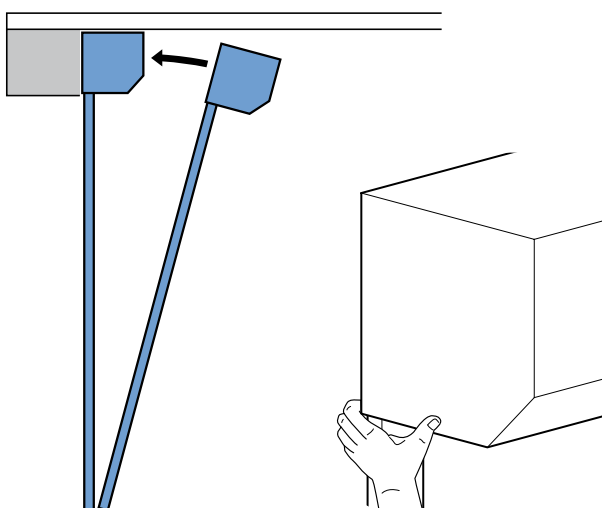

### 1.5 Hole for the control

If you want to place the roller door to the wall on the outside and you prefer an indoor control, you need to drill a transit hole for the power cord or band.

1. Accurate mark the transit hole where the power cord or band needs to come inside for the control.  
This needs to be at exactly the same height as the place where the power cord or band comes out of the cap!
2. Drill a 10 mm hole for the wall transit. Check before drilling if there are no pipes and such are in the wall!  
Always use a shelf on the inside of the house, so the stucco can not be damaged.

### 1.6 Installation of the cap to the guides

1. Remove the foil on the back of the cap. Leave the foil on top of the cap on.
2. Lift the cap with two persons.
3. Slide, if necessary, the power cord or band through the transit hole.
4. Slide the cap brackets, that extrude below the cap, in the guides.  
Be extra careful, the cap brackets are vulnerable!
5. Check if the roller door is level.
6. Fixate all screws.

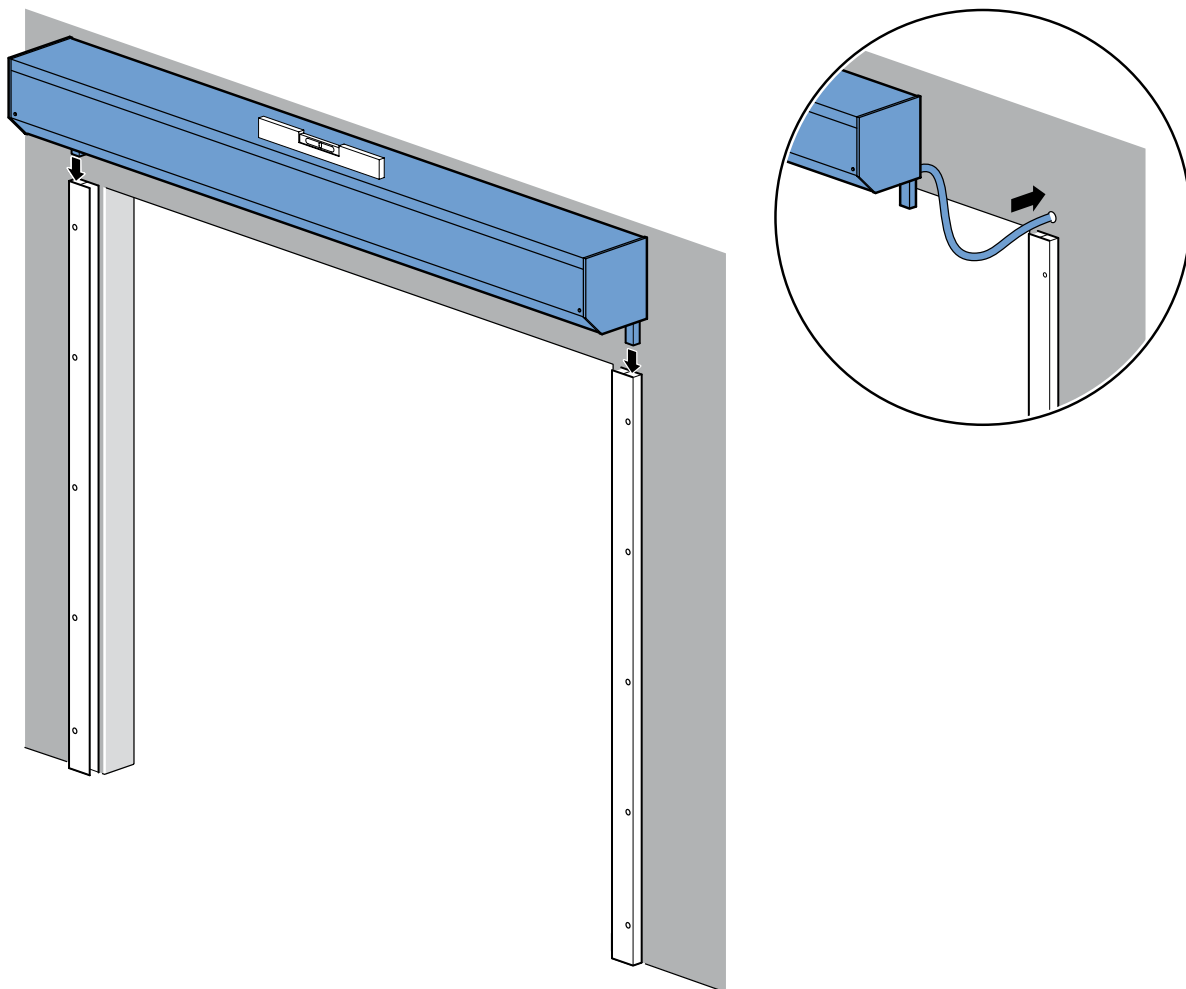

### 1.7 Fixation of the cap to the wall

**Attention!** The roller door cap needs to be fixated to the wall for a solid installation. You need to do this to prevent damages to the slats. The cap brackets of the side cap are less loaded by the armor weight.

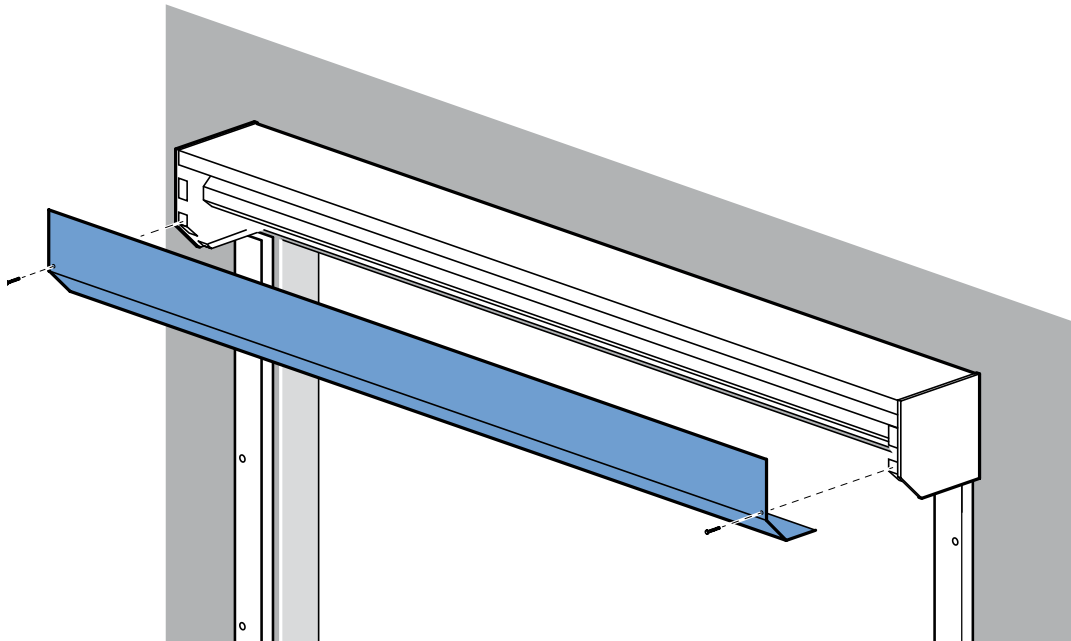

1. De-install the front side of the cap.
2. Drill the installation holes through the back of the side caps and the top cap in the wall. We advise to drill with a masonry drill. In case of a width smaller than 300 cm: three holes. In case of a width bigger than 300 cm: four holes. Screw the side caps and the back of the top cap to the wall. Use matching plugs, rings and screws of high quality.

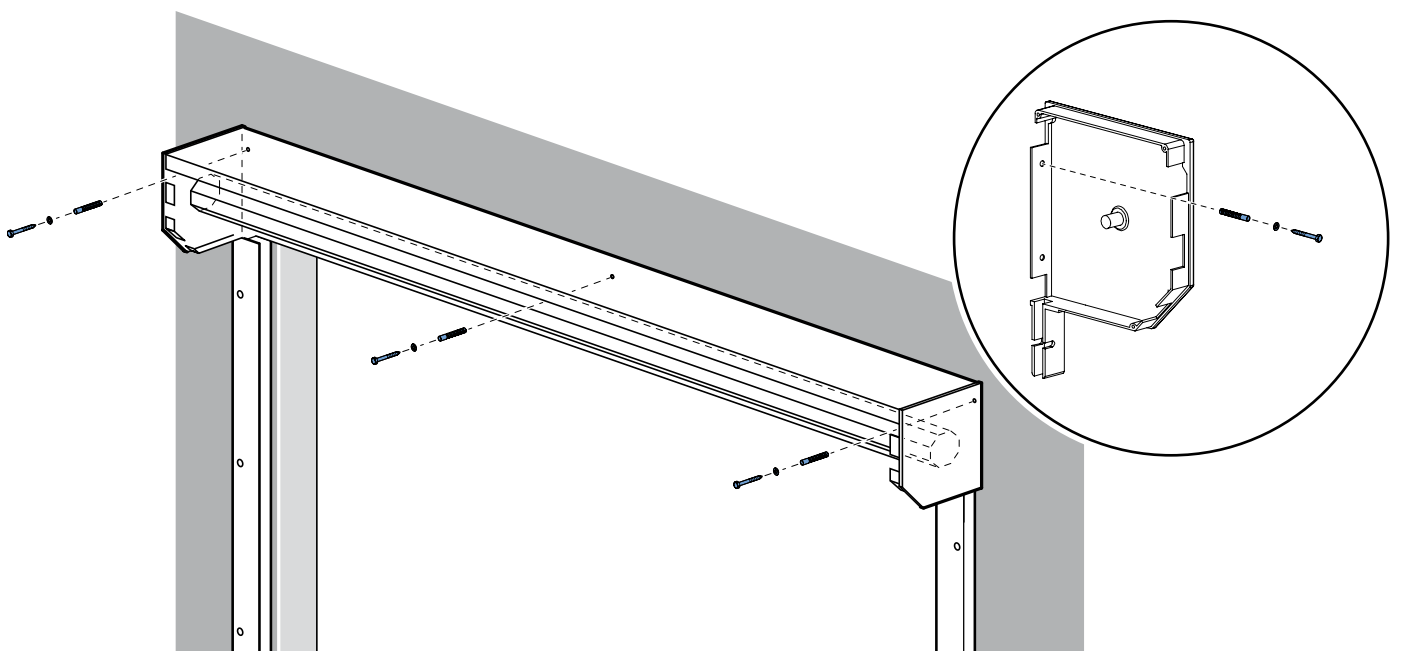



### 1.8 Installation of the armor

1. Slide the included suspension springs in the top slat of the armor.  
Place the first suspension bracket at 10-15 cm of the side. Divide the rest equally the width of the slat.

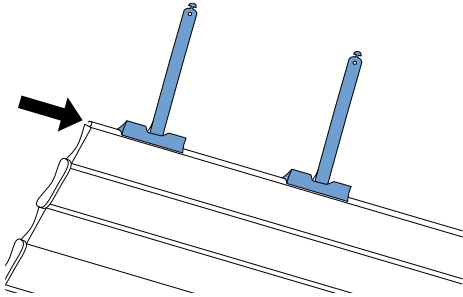

2. Lift the armor with two persons.
3. Turn the axle to make the rectangular grooves visible and hitch the suspension springs in the grooves of the axle.

**Attention!** The hollow side of the slats in the direction of the axle.

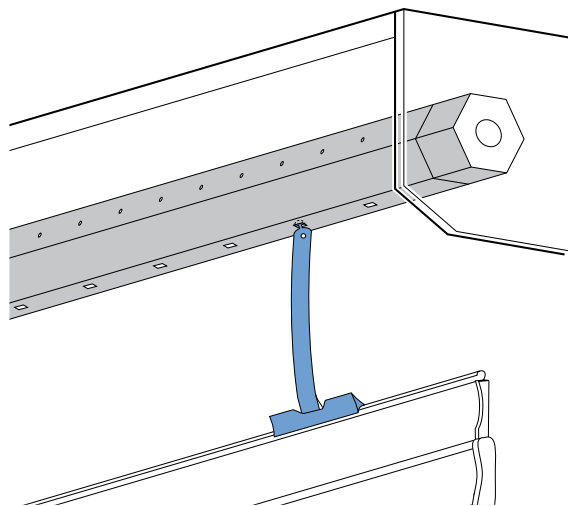
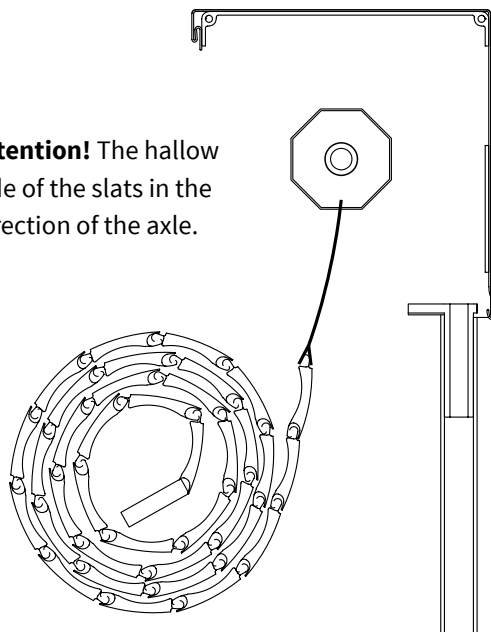

4. Roll the entire armor over the axle using the engine. The armor rolls from behind over the axle to the front.

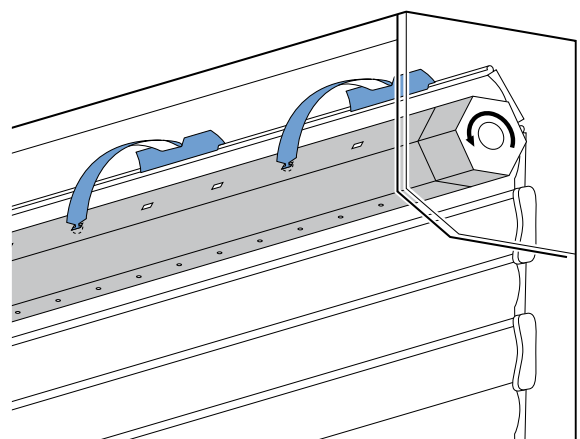
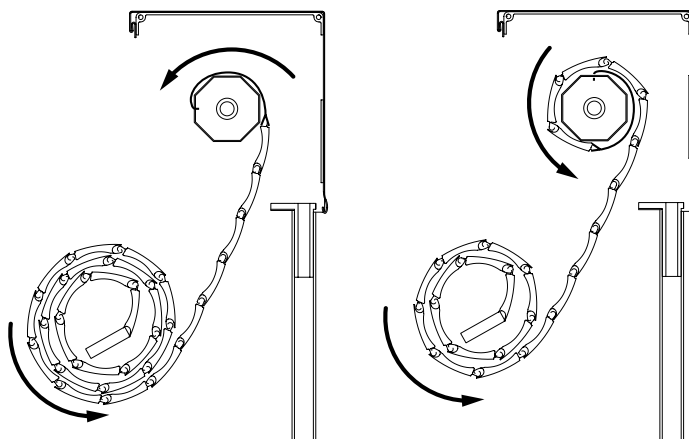

5. When the armor is fully rolled up, lower it again and guide the bottom bar carefully into the guides.
6. Lower the armor further into the guides until it is completely below.
7. Now set the end position of the armor. (See 1.9.)

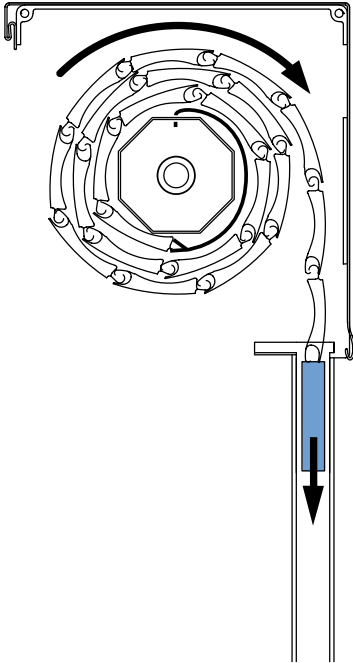

### 1.9 Adjustment of the motor

The adjustment of the motor depends on the brand and type of motor you ordered.

1. Set the end position of the armor fully pressed down.
2. After that, set the end position of the armor fully pressed up.

**Attention!** The bottom bar must remain completely in the guides.

See the instruction of the motor or ask your Verano® dealer for advise.

### 1.10 Finish

1. Install the front side of the cap.
2. Remove the protection foil from the top side of the cap and guides.
3. Close the holes with the covers.
4. Glue, if desired, the top and sides of the cap. In case of electrical control, this prevents water dripping inside.

## 2. Installation electrical control

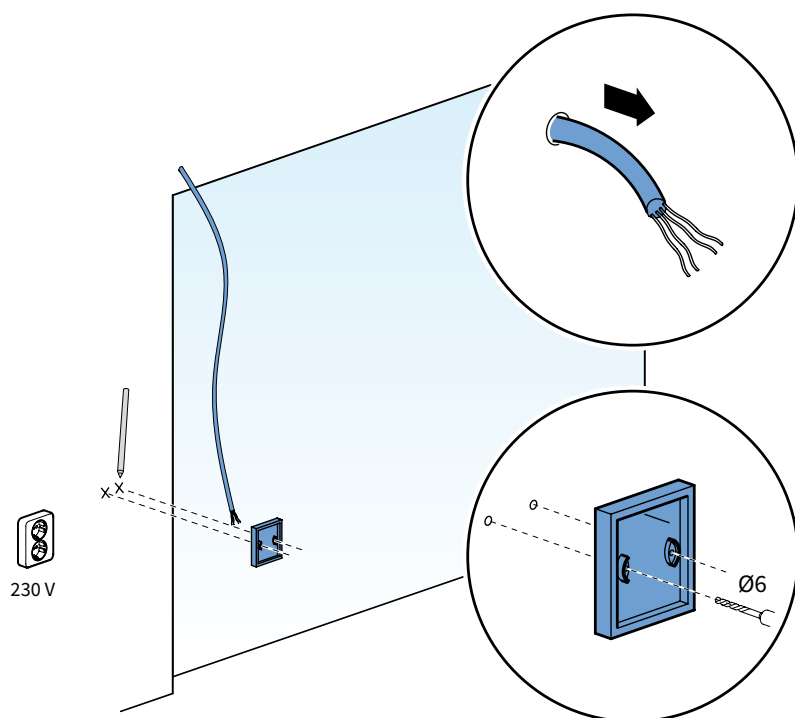

1. Determine the position of the switch and mark the two holes on the wall indoors.

2. Drill the holes with a 6 mm drill.

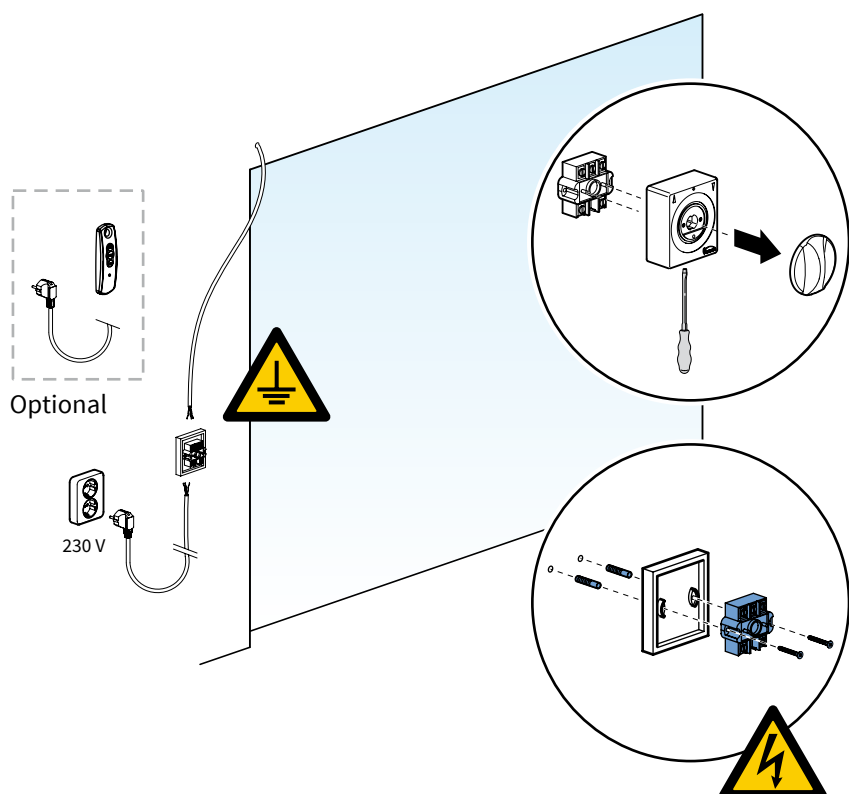

3. Open the switch using a flat screwdriver.

4. Place the wall plugs and install the switch with two recessed screws. Make sure that the power is turned off and without tension!

5. Connect the 4-core power cord of the motor and the 3-core power cord + switch, following the schedule. If necessary, consult an installer.

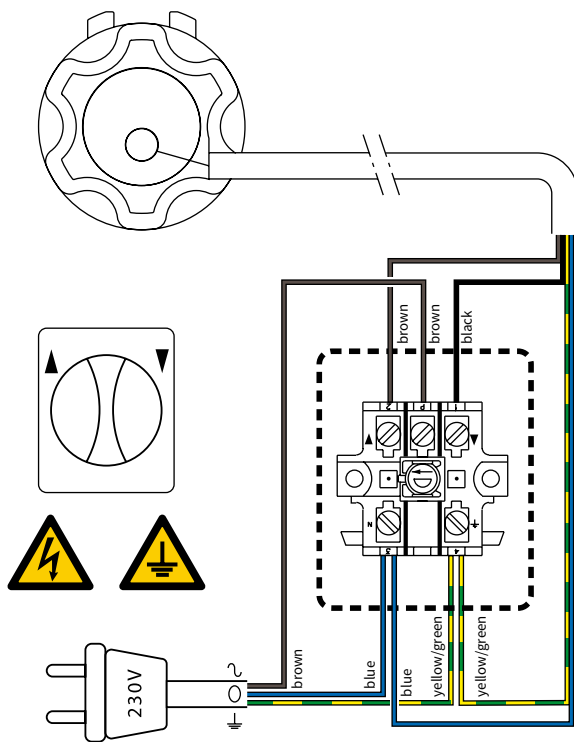

Motor left (seen from the outside)

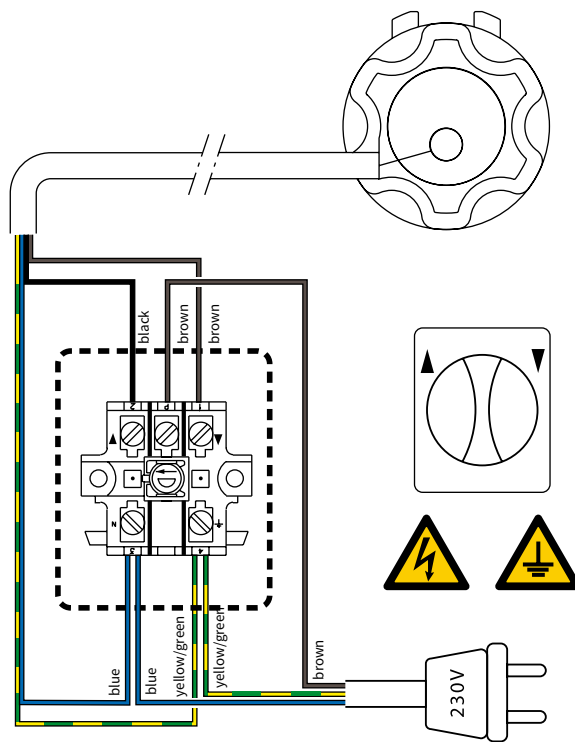

Motor right (seen from the outside)

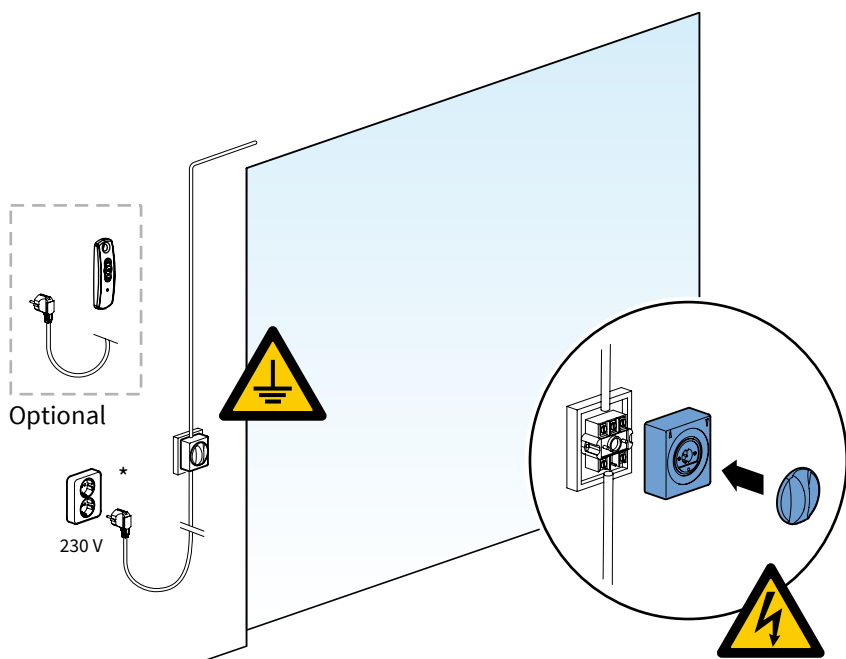

6. Install the switch.

In a situation with a wireless remote control, the 3-core power cord can directly be connected to the socket.

7. Put the switch in the socket and turn on the power.

The roller door is now ready to be controlled.

\*See the included Somfy instruction for the setting of the remote control.