

INSTALLATION MANUAL

SLIDING DOOR V790 - SOLANO

Index

	page
Exploded view	2
Partslist	2
Required tools	3
Important before installation	3
General - Mounting the window frame	4
Mounting the sliding door	6

Exploded view

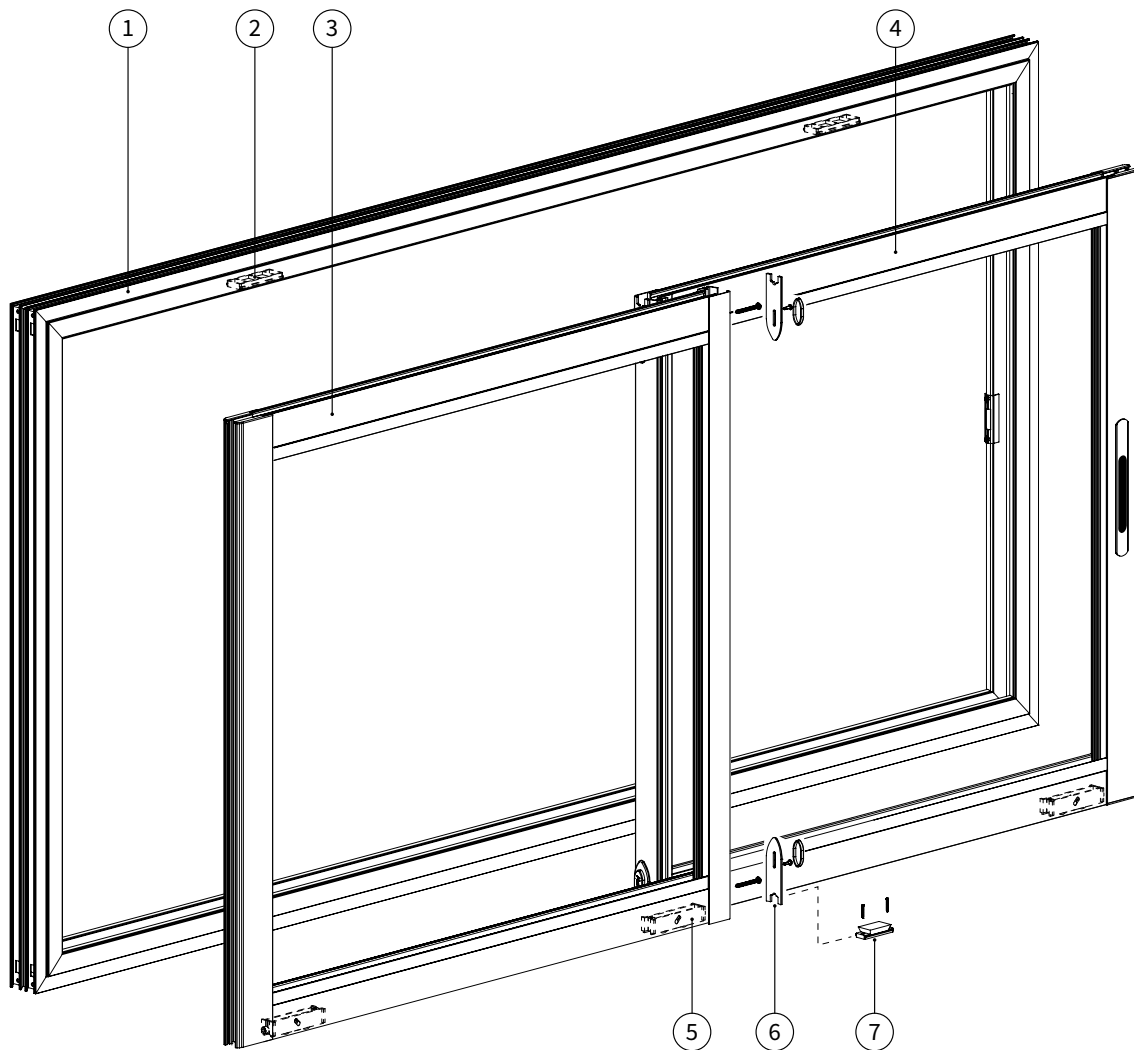

Partslist

1. Window frame
2. Anti-lifting blocks
3. Sliding window part
4. Fixed window part
5. Double pulley
6. Rail cover with small cap
7. Lock bumper

Screws

Warning! The installer needs to determine the size, number and type of plugs.

Required tools

- Drilling machine
- Metal drill
- Crosshead screwdriver
- Allen key set
- Tapeline
- Level
- Pencil
- Screwdriver
- Silicone kit (Acid Free)

Important before mounting

General warning

Mounting the Verano® product yourself is at your own risk. Only use this instruction as a tool and for the mounting of this specific Verano® product. If you cannot install the product yourself, you can always opt for professional mounting. The mounting team of Verano® is pleased to help you.

- Be careful for damages. Don't use a knife or any other sharp object when opening the packing. This may cause damage to the content of the assembly. Put the content of the assembly on a soft surface.
- Be careful when drilling, falling drill cuttings can cause damages.
- Clean, degrease and dry off the sides of the opening wherein the sliding door will be installed.
- Remove all the dust, loose plaster and other unevenness for a perfect closure.

General - Mounting the window frame



2,5 mm

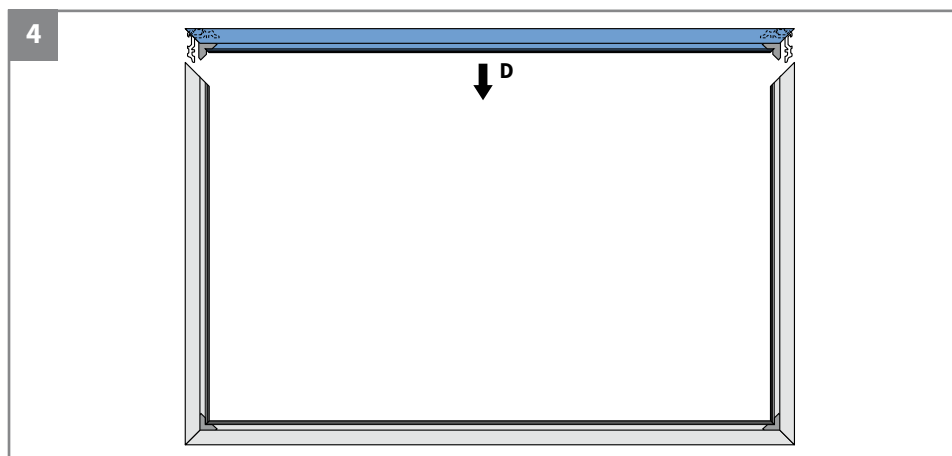
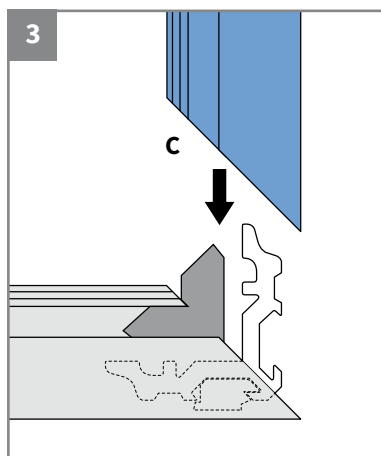
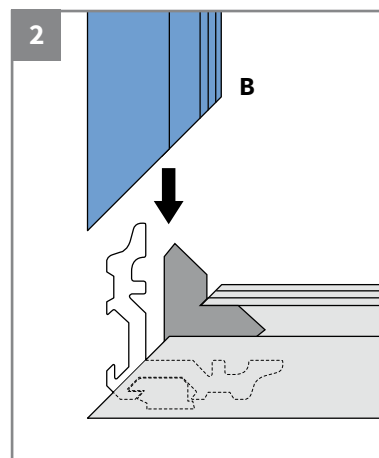
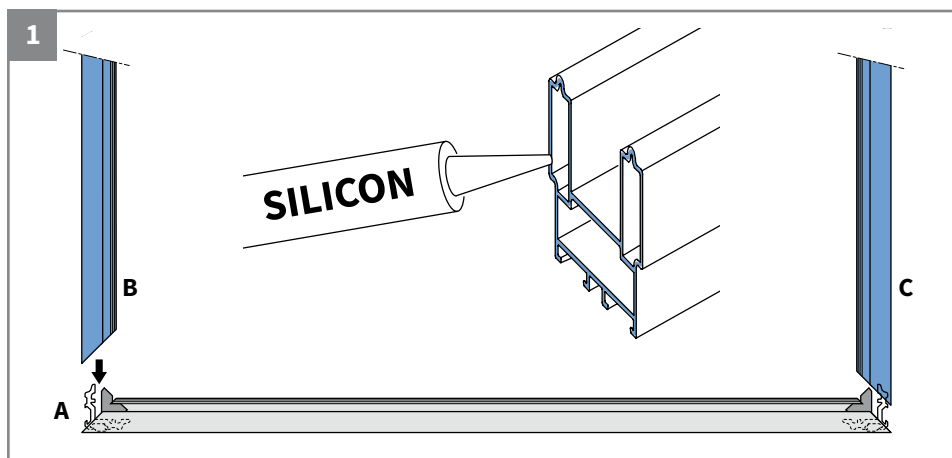
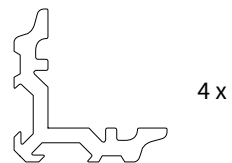

5

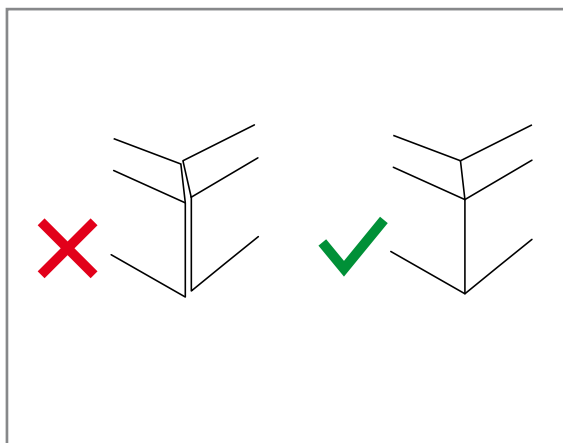
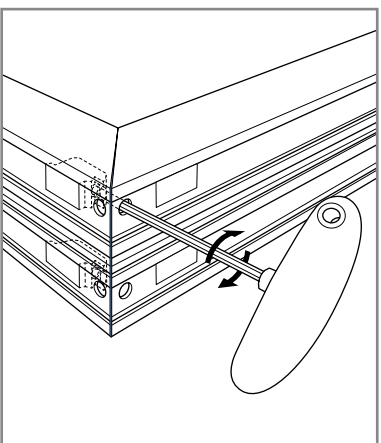
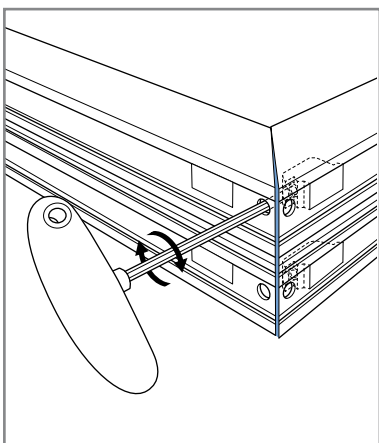
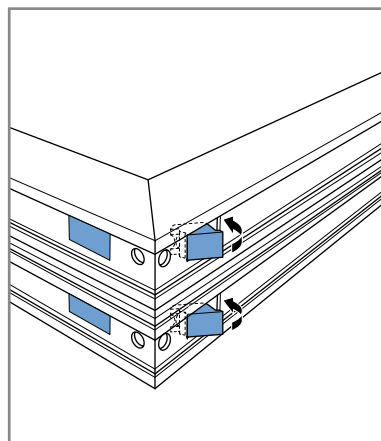
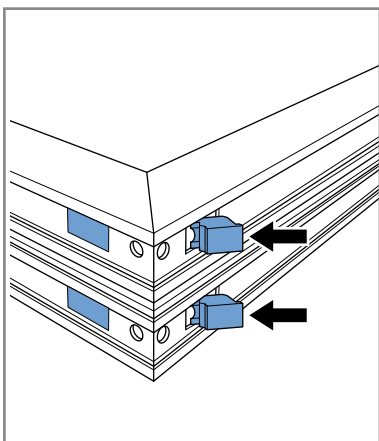
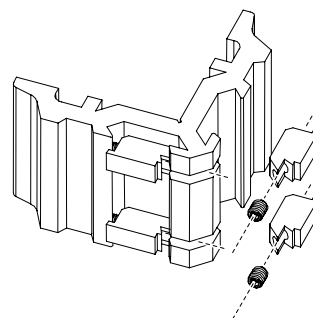
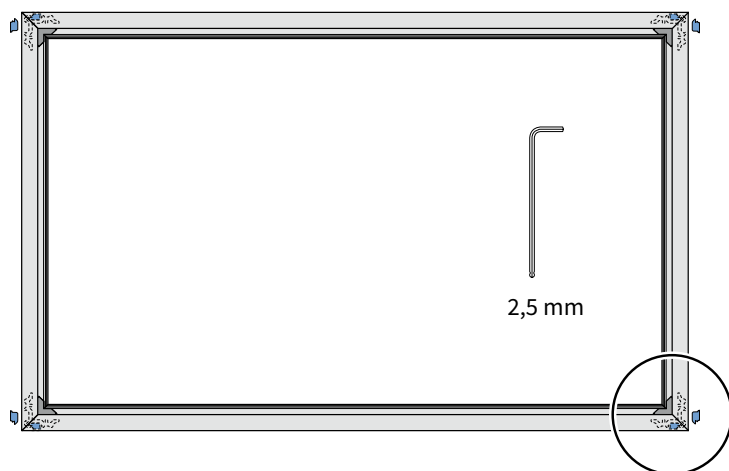

Mounting the sliding door

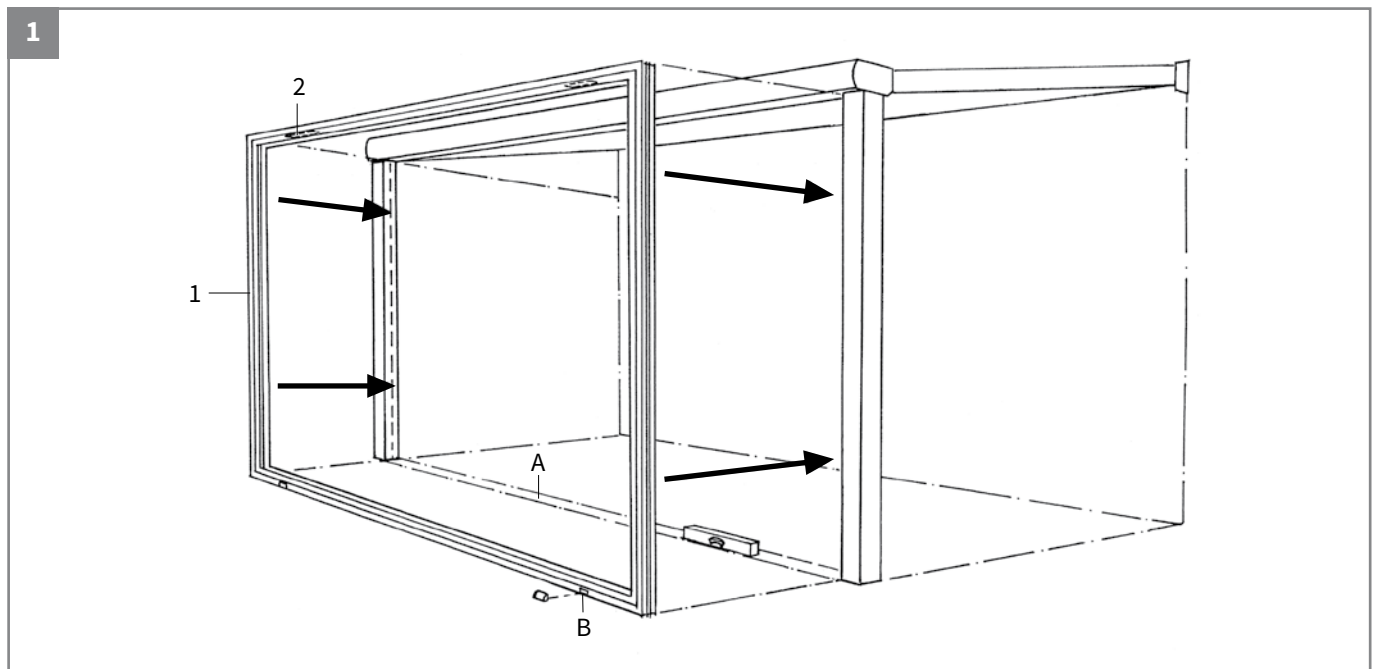

Install the window frame (1) below the veranda.

Attention! The blocks (2) on top. The water outflow holes (B) below.

The floor (A) needs to be 100% level.

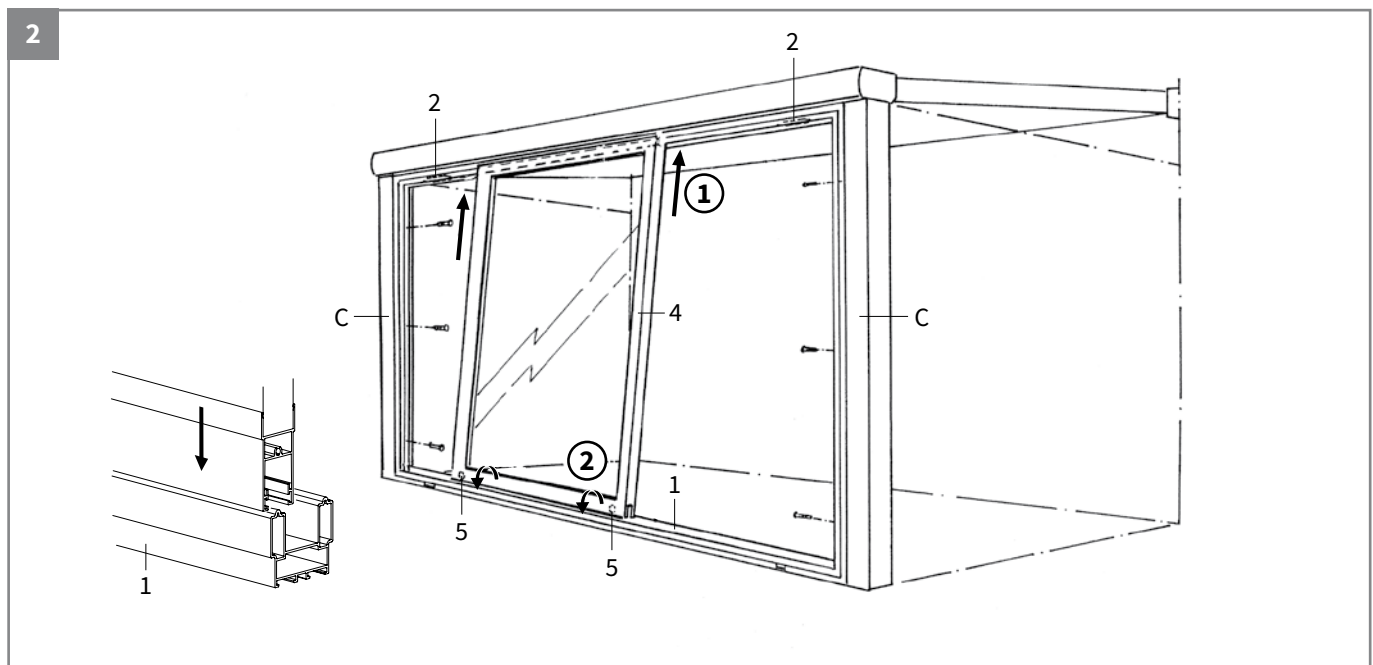

- Screw the window frame to the veranda posts (C).
- Install the fixed window part (4) between both anti-lifting blocks (2), approximately in the middle.

Attention! Wheels (5) underneath.

First slide as high as possible, this way the fixed window part can lower on the front rail (1)

- After that, slide the fixed window part to the left.

3

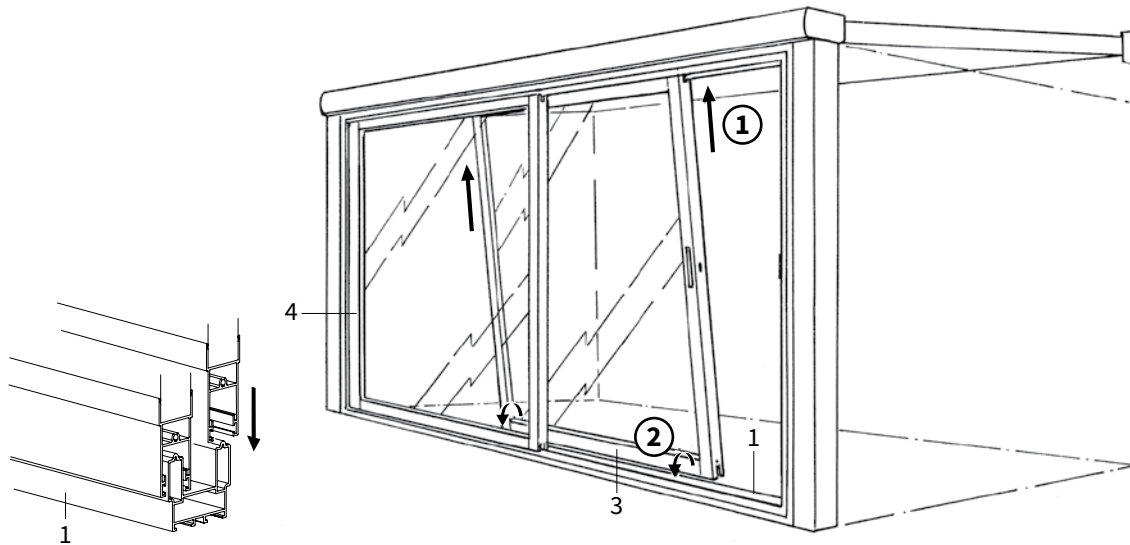

Install the sliding window part (3) to the rail (1) (inside rail).

Attention! Wheels underneath.

4

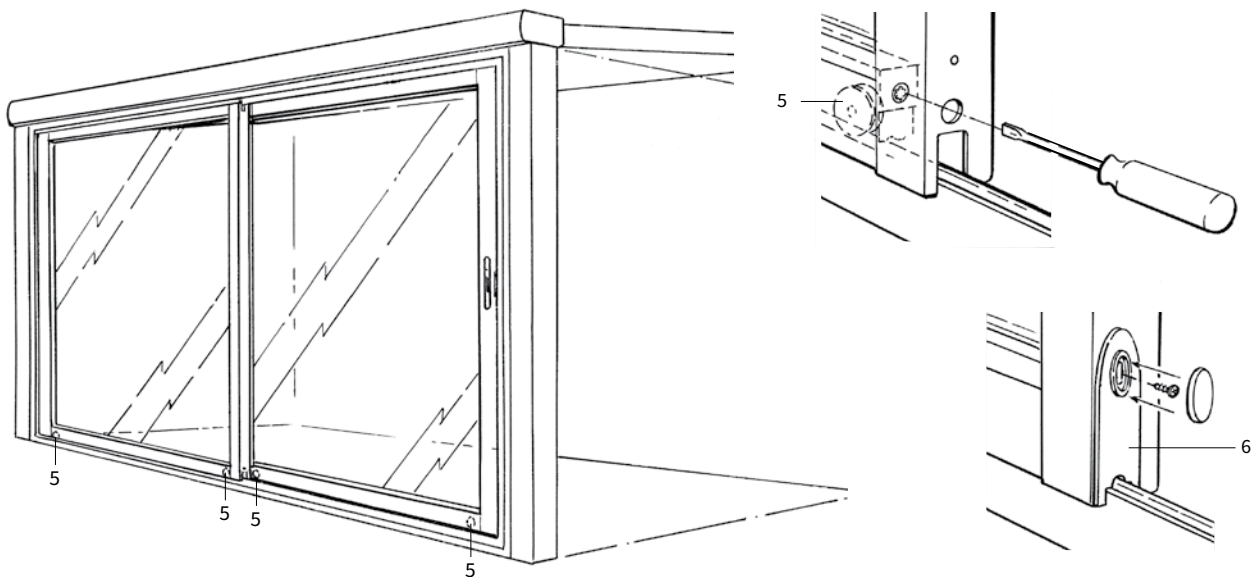

- Make sure that the sliding door moves smoothly.
- Set the wheels (5), if necessary.
- Screw the rail cover (6) and push the small cap on (at 4 points: 2x above, 2x below).

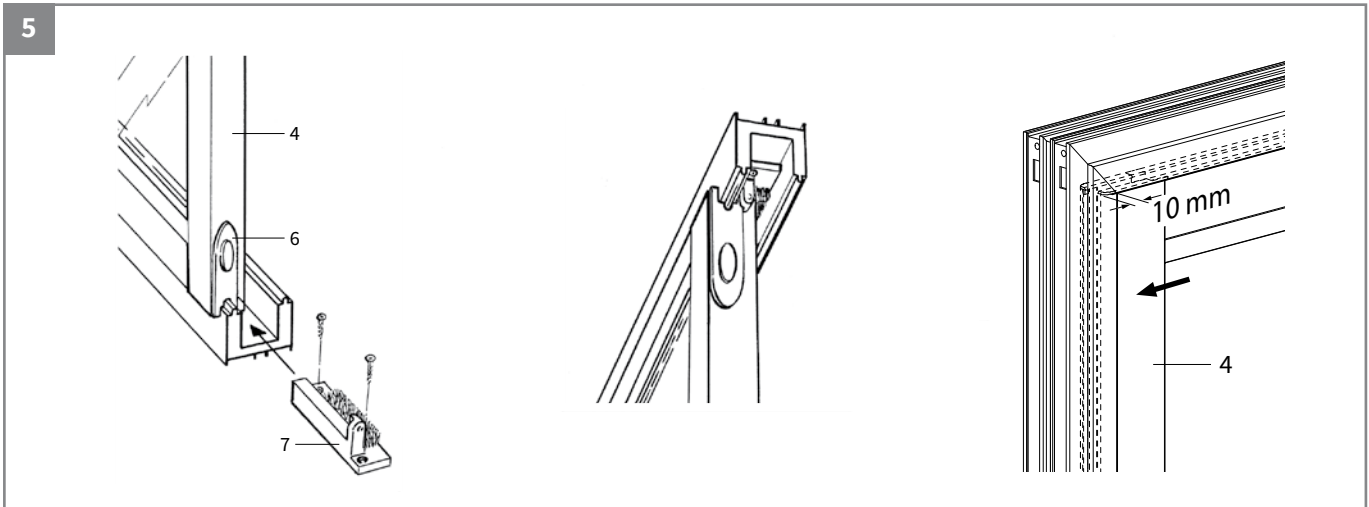

- Secure the fixed window part using the lock bumper (7). Slide the lock bumper (7) below the fixed window part (4) against the rail cover (6) and secure with two screws.
- Repeat at the top.

Attention! Make sure the fixed window part presses as far as possible against the window frame (10 mm overlap).

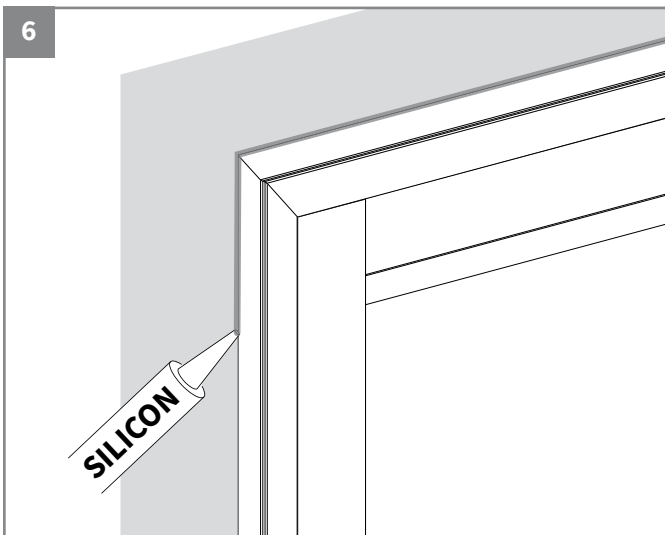

Optional: use silicone for a fine finish.