



INSTALLATION MANUAL  
**VERANDA V910 - GARDA**

## Index

	page
Exploded view	2
Summary of the parts	3
Required tools	4
Important before installation	4
1. Mounting the wall profile	5
2. Fixing the gutter	6
3. Foundation	8
4. Mounting the uprights	9
5. Mounting the gutter	10
6. Placing the beams	11
7. Laying the glass or Poly roofing panels	14
8. Placing the side plate and rubber	15
9. Finishing	16
Processing the polycarbonate plates	17
CE-statement	20

## Exploded view

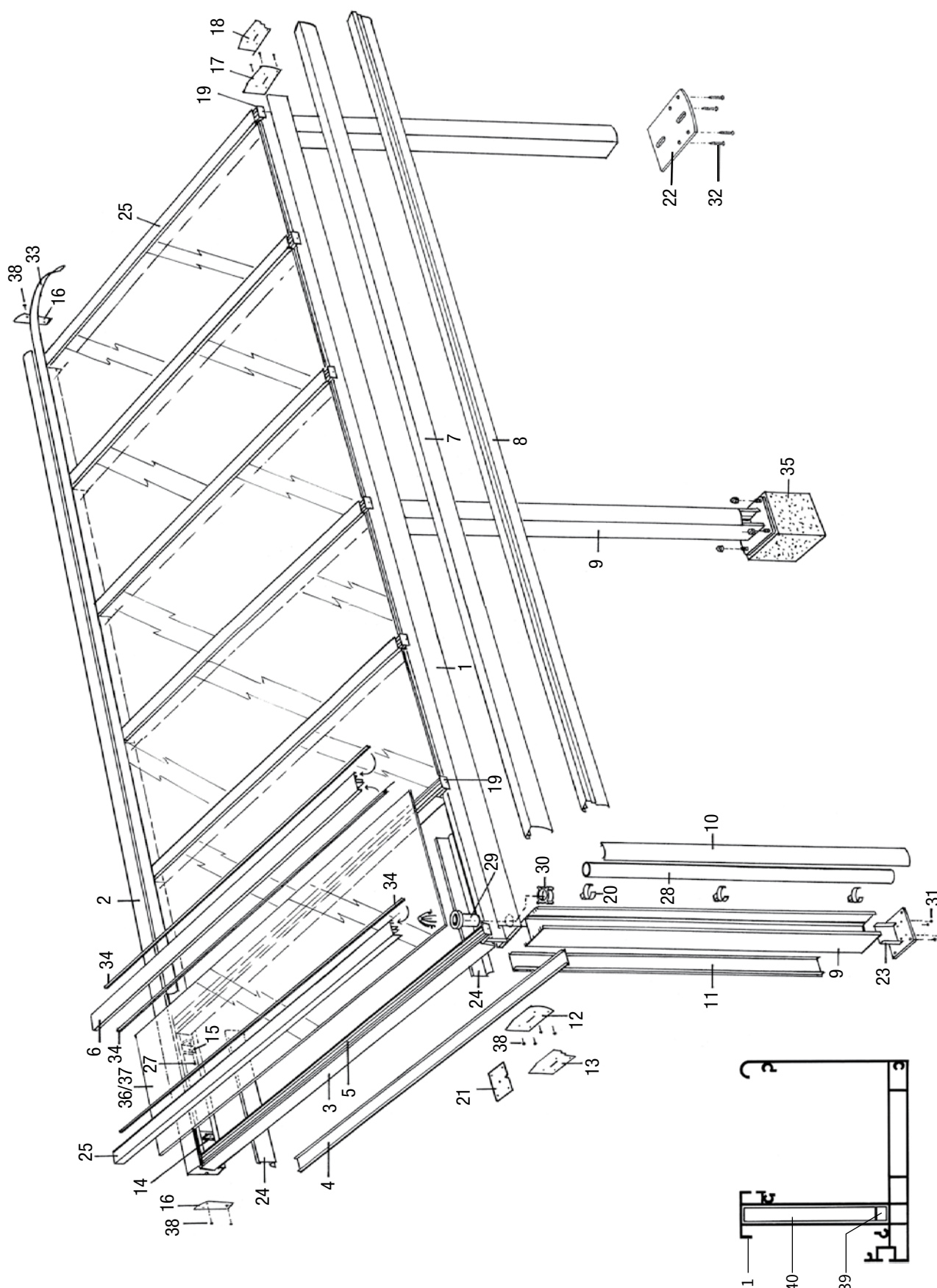

## Summary of the parts

- |                                      |   |
|--------------------------------------|---|
| 1. Gutter                            | 21. Drilling template gutter and upright                |
| 2. Wall profile                      | 22. Mounting foot flat                                  |
| 3. Beam profile                      | 23. Mounting foot V91                                   |
| 4. Click profile beam                | 24. Click covering                                      |
| 5. Plastic frame beam                | 25. Top profile beam                                    |
| 6. Covering frame                    | 26. Allen key screw M8 x 16 DIN 914                     |
| 7. Top unit, standard                | 27. Screw 4,8 x 25 DIN 7981                             |
| 8. Top unit, rustica                 | 28. Pipe Ø 50 mm  |
| 9. Upright                           | 29. Plastic grommet tube                                |
| 10. Upright, click front             | 30. Nut for plastic grommet tube                        |
| 11. Upright, click back              | 31. Screw 4,2 x 45 DN 7981                              |
| 12. Side plate gutter, left          | 32. Screw 4,2 x 45 DIN 7982                             |
| 13. Side plate gutter rustica, left  | 33. Rubber wall profile                                 |
| 14. Mounting bracket beam, right     | 34. Co-extrusion  |
| 15. Mounting bracket beam, left      | 35. Foundation foot                                     |
| 16. Side plate wall profile          | 36. Glass plate   |
| 17. Side plate gutter, right         | 37. Polycarbonate plate                                 |
| 18. Side plate gutter rustica, right | 38. Screw 4,2x25 DIN 7981                               |
| 19. Covering cap beam                | 39. Rods for additional weight gutter (2 pieces 10 x 5) |
| 20. Clamping yoke, pipe Ø 50 mm      | 40. Additional weight gutter (100x10)                   |

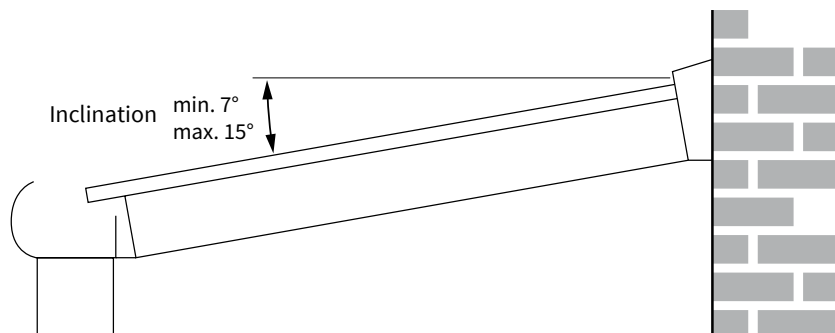
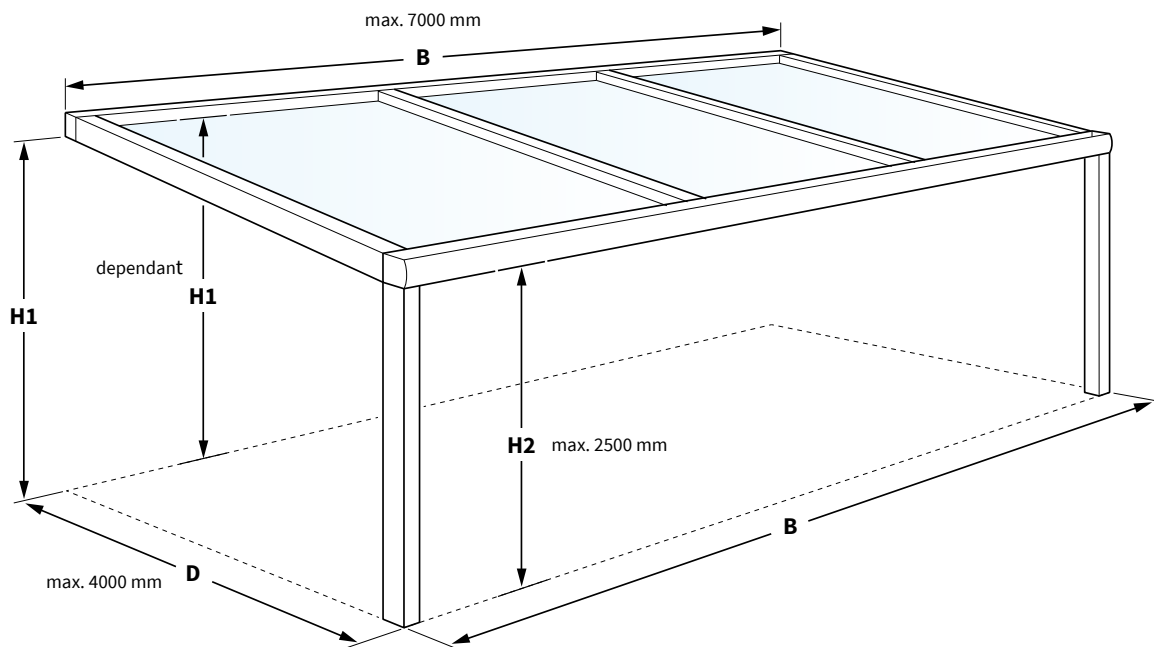

## Required tools

- Drilling machine
- Metal drill
- Masonry drill
- Crosshead screwdriver
- Allen key set
- Tape measure
- Level
- Pencil
- Cutting plier
- Flathead screwdriver
- Silicone kit
- Rubber hammer

## Important before installation

### General warning

Installing the Verano® product yourself is at your own risk. Only use this instruction as a tool and for the installation of this specific Verano® product. If you cannot install the product yourself, you can always opt for professional installation. The installation team of Verano® is pleased to help you.

### Be careful for damages

Don't use a knife or any other sharp object when opening the packing. This may cause damage to the content of the package. Put the content of the package on a soft surface. Be careful when drilling, falling drill cuttings can cause damages.

Check if the façade is flat.

## 1. Mounting the wall profile

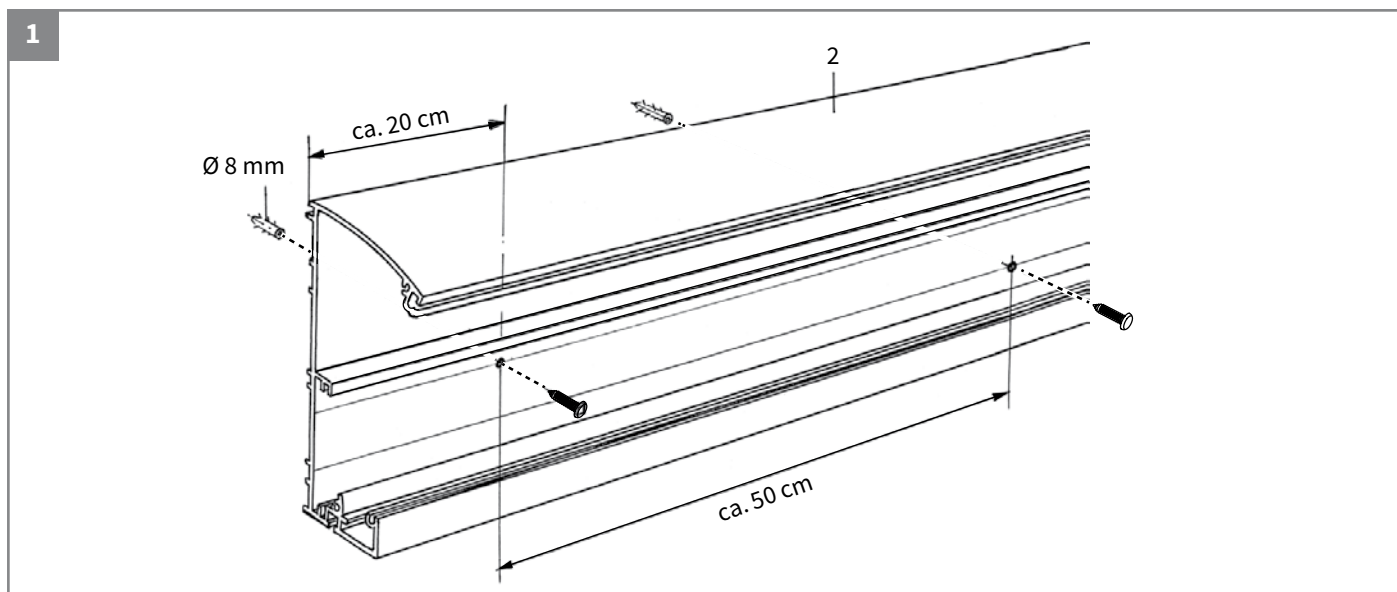

- Drill holes in the wall profile (2), Ø 5 mm.
- Distance between the holes around 50 cm and switch up/down.
- Mark the holes on the wall and drill with a concrete drill 8 mm.
- Screw the wall profile (2) (screws and plugs are not included).

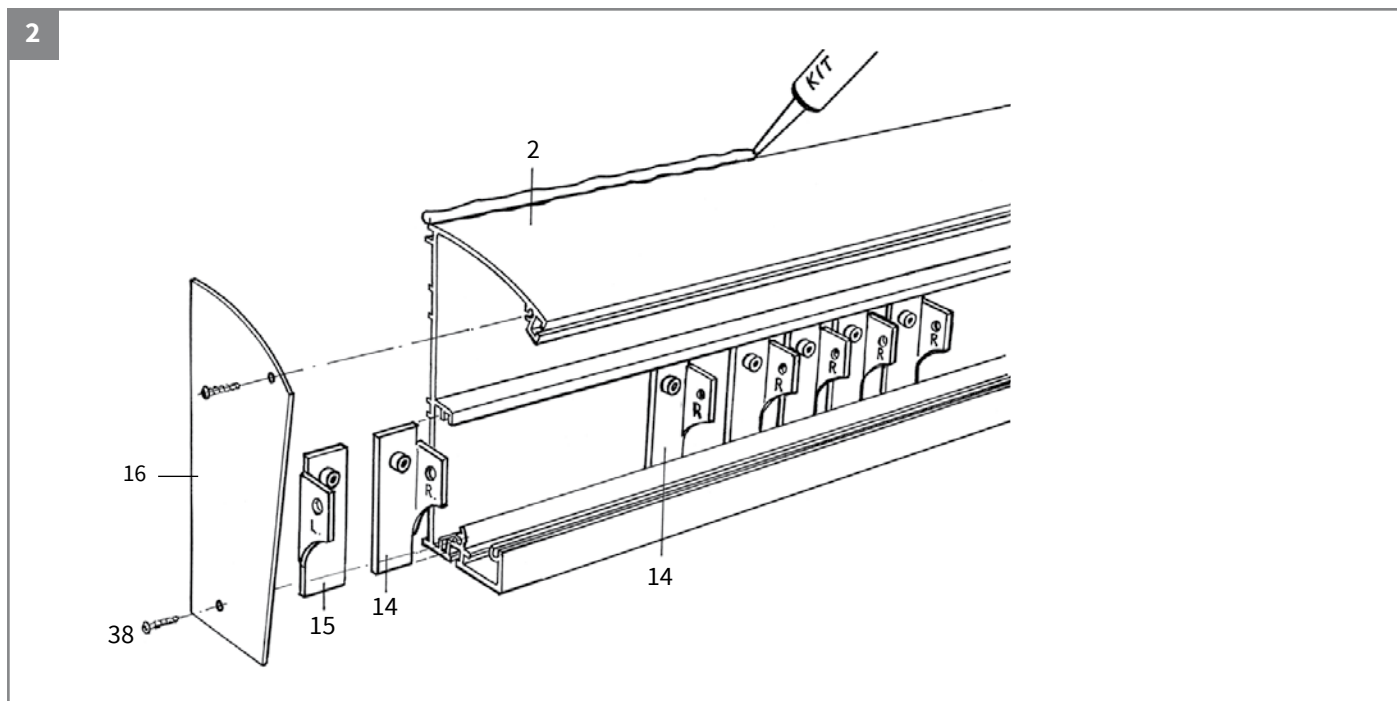

- Seal the top side.
- Slide the mounting brackets for the beams into the wall profile (2).

### Attention!

One bracket for one beam: for the left beam, use the left bracket (15). Use the right brackets (14) for the remaining beams.

- Side plate wall profile (16) can be mounted with screws (38).

## 2. Fixing the gutter

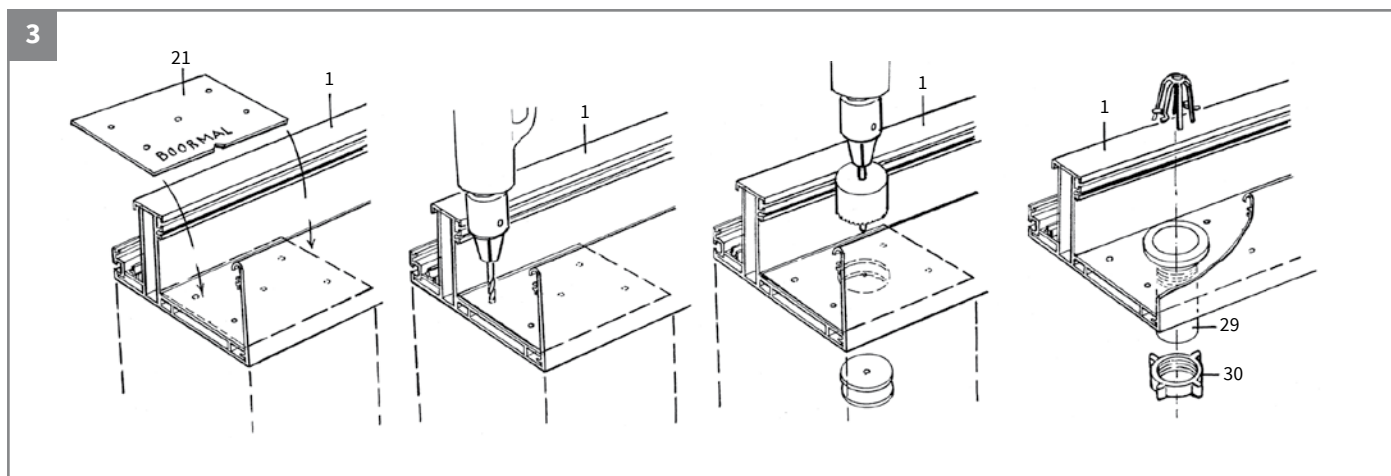

### Drilling the holes for the upright

- Use included drilling template (21). For the outer uprights, place the drilling template equal to the gutter ends. Drill 5 holes Ø4,0 mm.
- Drill the hole for the drainage Ø50 mm.
- Now install plastic grommet tube, possibly provided with sealing kit in advance. Tighten with nut for plastic grommet tube (30).

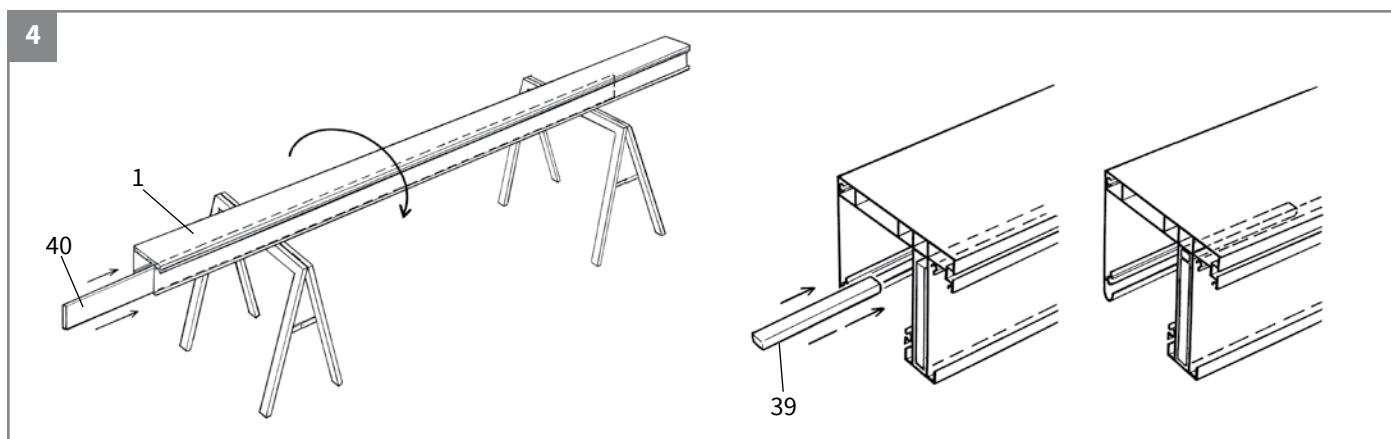

### Applying additional weight in the gutter

To prevent bending of the gutter, you need to fill up the gutter with additional weight.

- Turn the gutter upside down.
- Slide the weight (40) into the gutter.
- Fill up, on both sides, with the rods (39).

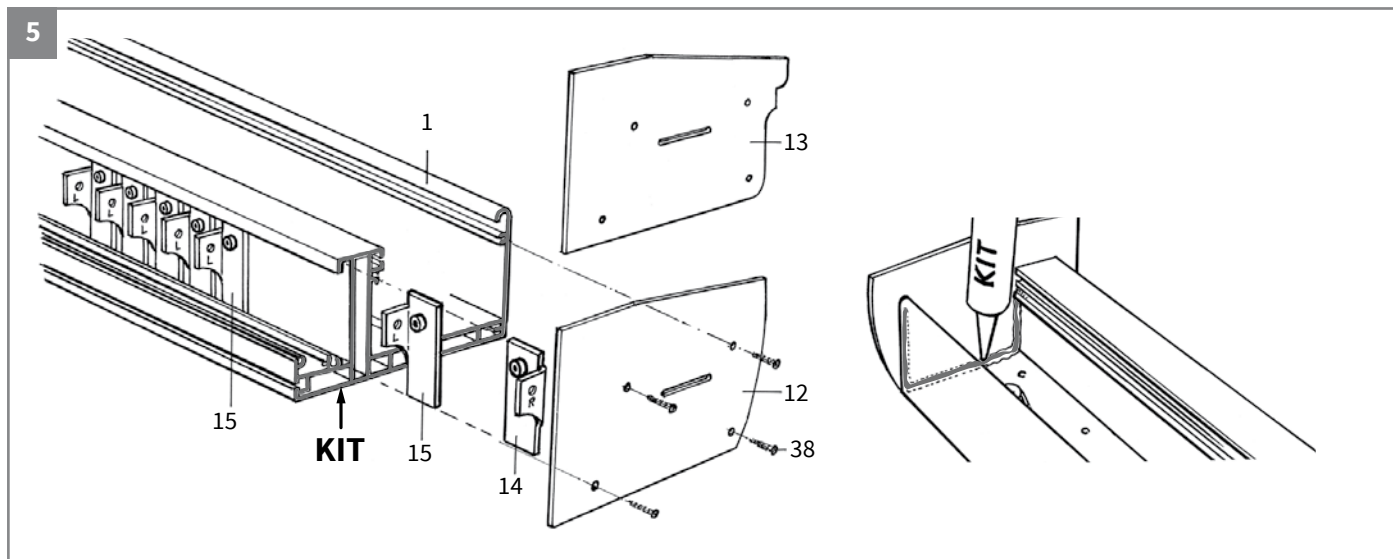

## Mounting brackets beam

- Slide the mounting brackets for the beams into the gutter profile (1). One right bracket (14). The remaining brackets are left brackets (15).
- Seal the sides of the gutter before you mount the side plates.
- The side plates gutter (12 or 13) can now be mounted. Screw tightly with screws (38).
- Seal the side plates on the inside of the gutter.



### 3. Foundation

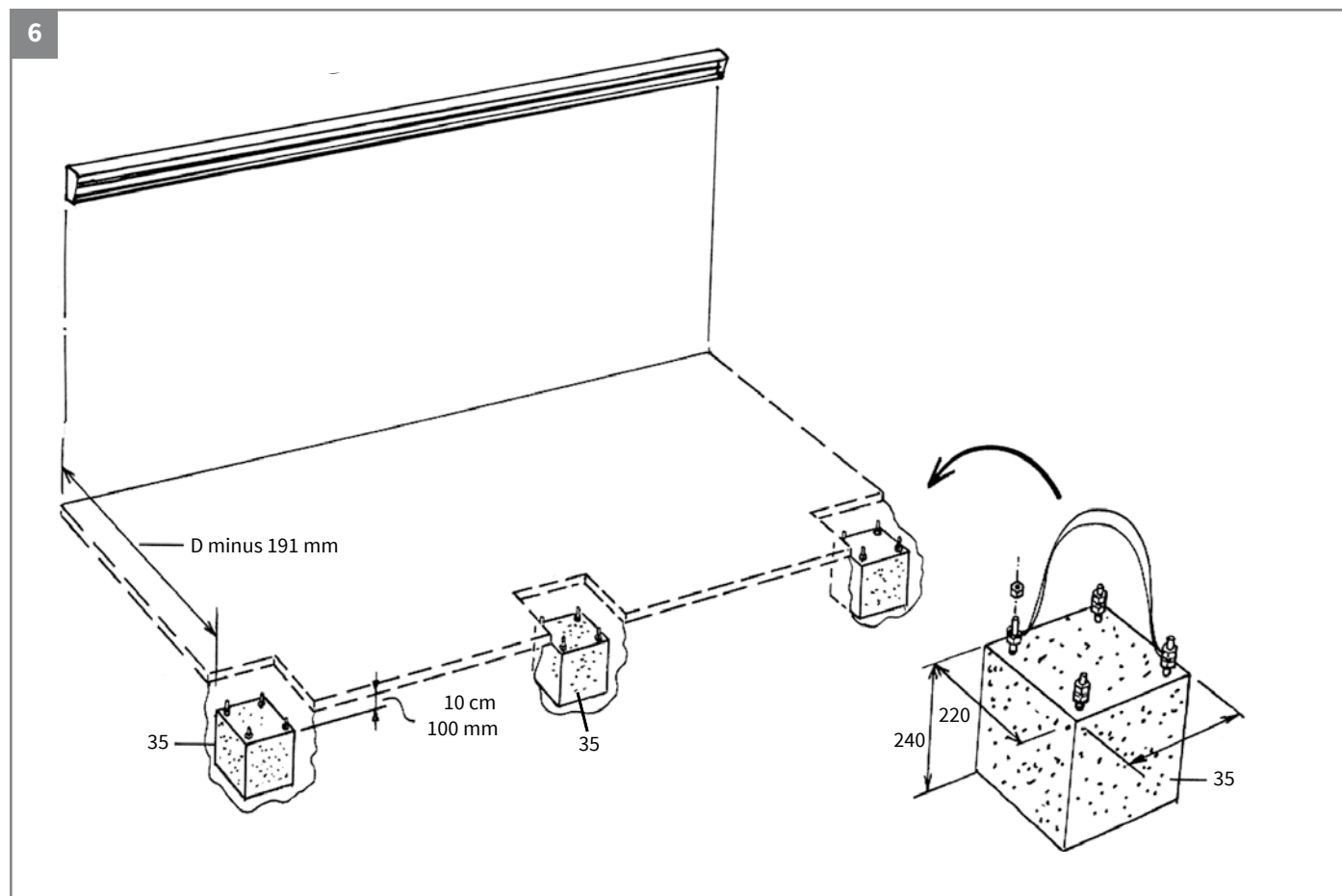

#### Placing the foundation blocks

This needs to be done carefully. The distance between the foundation blocks (35) and the wall is size D minus (-) 191 mm. You wrote down size D on your order form. We advise to place the foundation blocks around 10 cm (100 mm) below the terrace level.

(Pour extra concrete if needed. This depends on the type of soil on which the porch is installed).

**Attention!** Before the final placement of the foundation blocks, you need to mount the uprights, gutter and outside beams. Only then you know the specific position of the foundation blocks.

## 4. Mounting the uprights

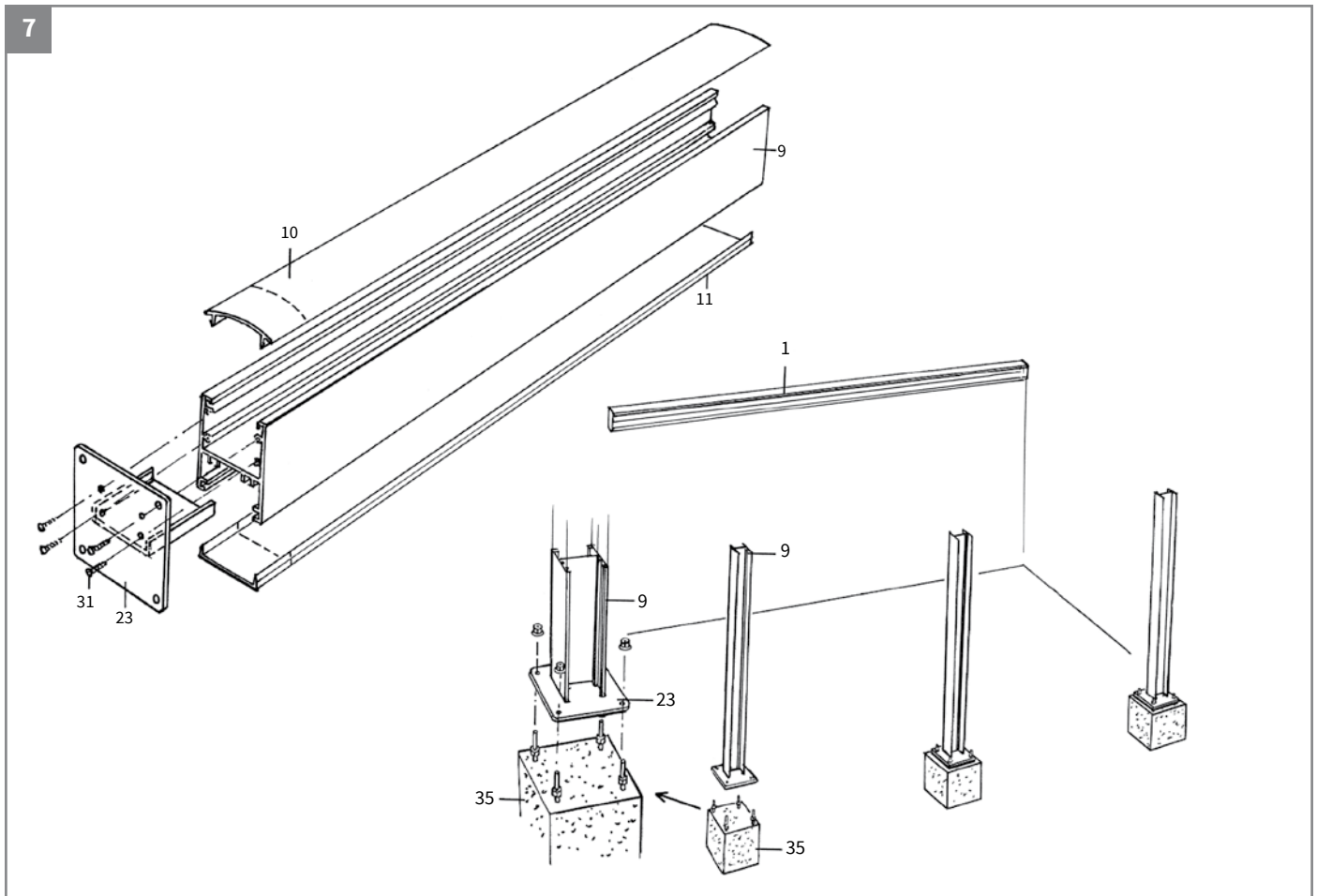

The uprights are standard 250 cm long and must be custom made by you. The size of uprights (9) is 10 cm longer than size H2. You have quoted size H2 on your order form. This 10 cm is the distance from the terrace to the top of the foundation block.

### Sawing the covering profiles to the right size

Because the upright (9) is set about 10 cm below the terrace level, the covering profiles (10) and (11) need to be sawed approximately 10 cm shorter. It is advisable to do this last. (See page 16).

### Mount uprights onto foundation blocks (35)

The foundation blocks have casted threaded ends with 2 nuts, in this way the uprights can be adjusted in height.

### Mount footplates

Screw footplate (23) using screws (31) onto the upright (9).

## 5. Mounting the gutter

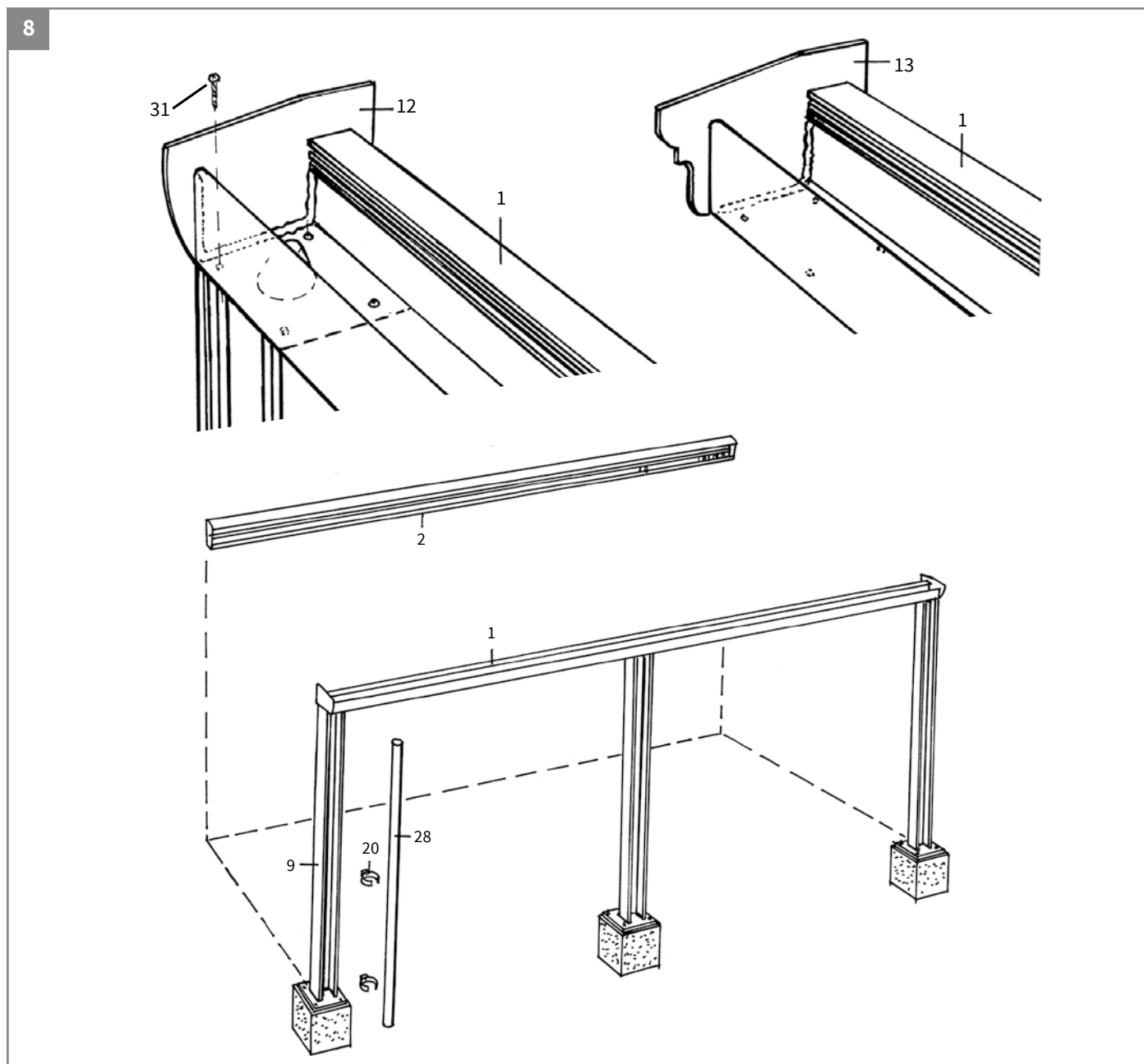

### Mounting the gutter onto the uprights

The four drilled holes are positioned with the aid of the drilling template and fit exactly to the screw holes of the uprights (9).

It is advisable to place the drainage pipe (28) before tightening the screws. 2 clamps (20) are required to do this.

These clamps are screwed to the back of the upright. Drill Ø 3 mm holes in the middle of the upright to place the clamps.

### Warning!

If the veranda is placed between two walls, and the overflow can no longer function, the drainage system must be fitted with an additional outlet. In this manner, the overflow of water can be prevented.

## 6. Laying the beams

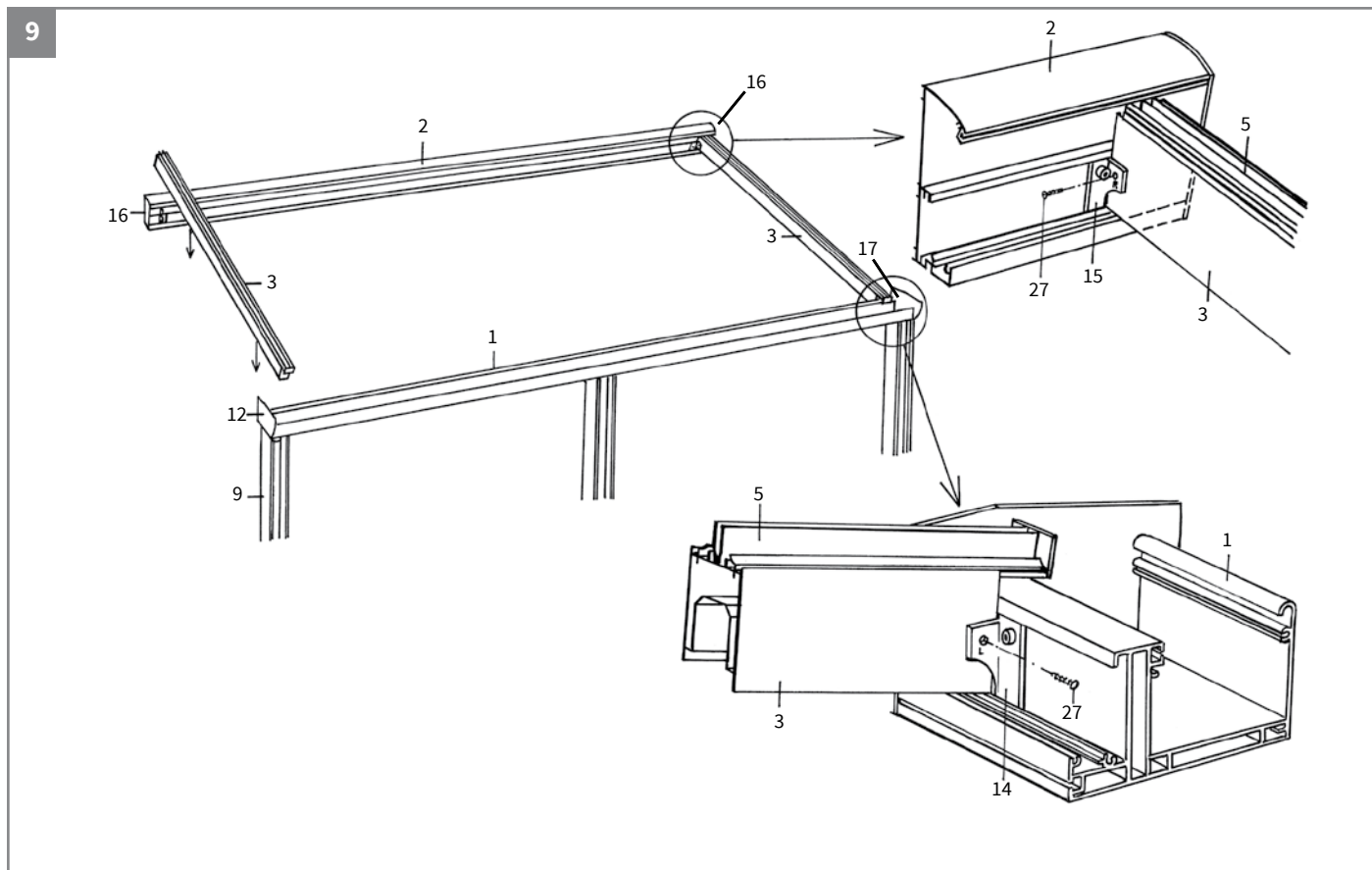

- The beams (3) are standard provided with a plastic glassbracket profile (5), which is already made to measure.
- The first step is the placement / mounting of the outer beams (3). Between the beams and the covering plates (12), (16) and (17) should be 2 mm space to install the 2mm thick top profile later on (See page 12).

10

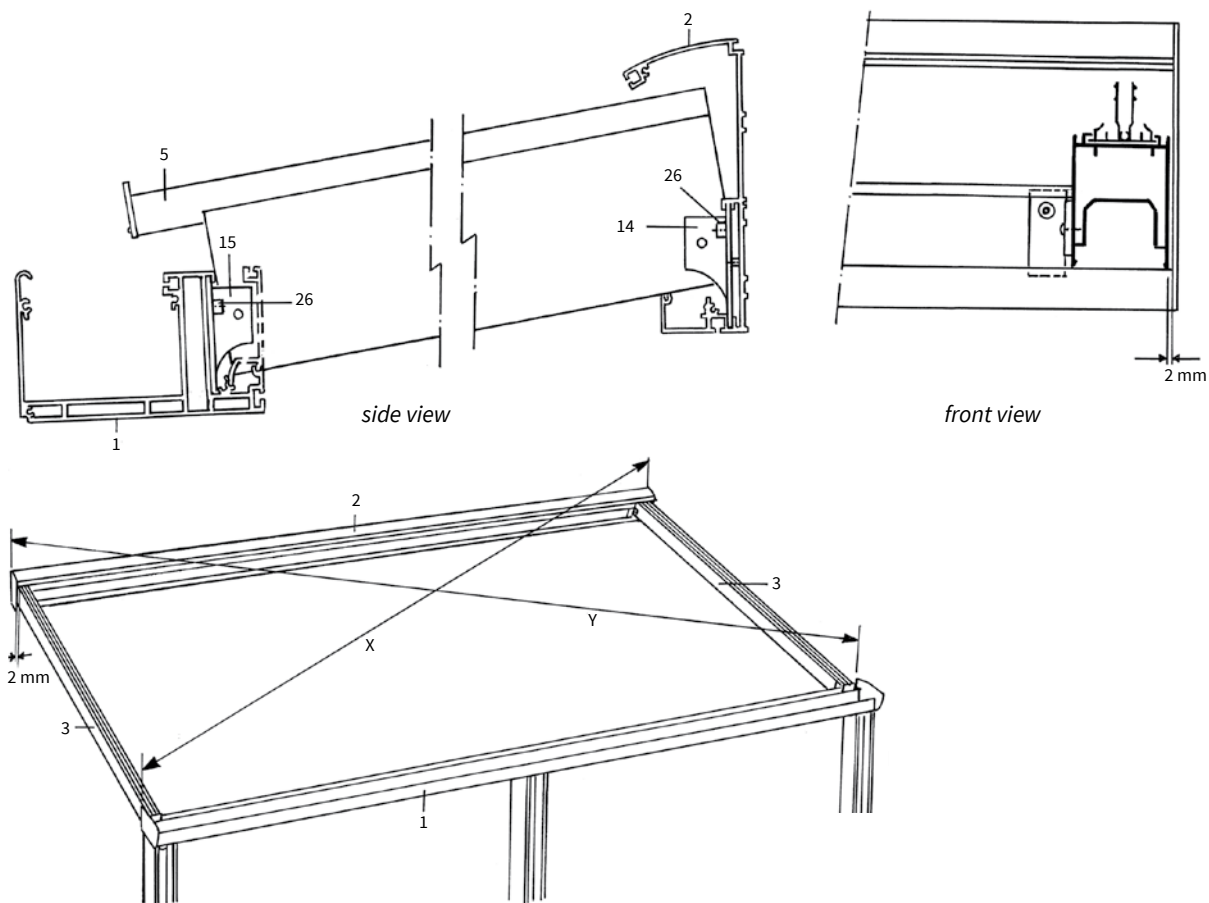

## Securing

You will need the beams brackets to do this (15) or (14).

- First place the beams (3) in the right position (press to the wall profile).
- Then, drill the hole of the brackets (14) or (15) in the beam (3), Ø 4.5 mm diameter and fasten with screw (27).
- Now, using the allen key screw (26), secure the bracket.

**Attention:** 2 mm space between side plate of the wall profile and the outer beams.

After mounting the outer beams measure the construction diagonally. Size X and Y must be identical.

11

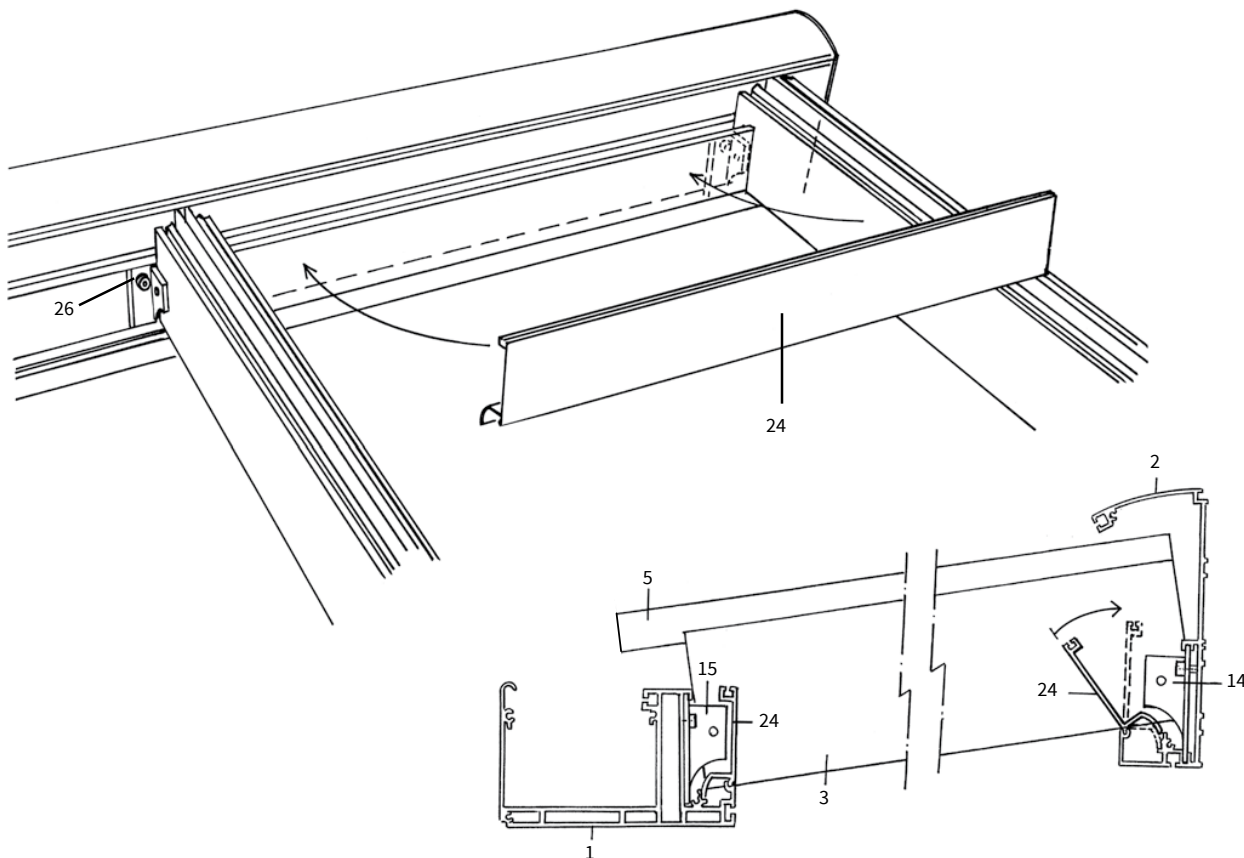

### Install other beams

- In order to determine the correct distance, use the click covering (24), which is tailor-made for you. Use this stiffener to measure the right distance.
- The other beams are installed in the same way as the outer beams, so with beam brackets (14/15).
- Now click the click covering divider (24) into the wall profile (2) and gutter profile (1) (by pressing it in the slot and turning it backwards and clicking).

## 7. Laying the roofing panels

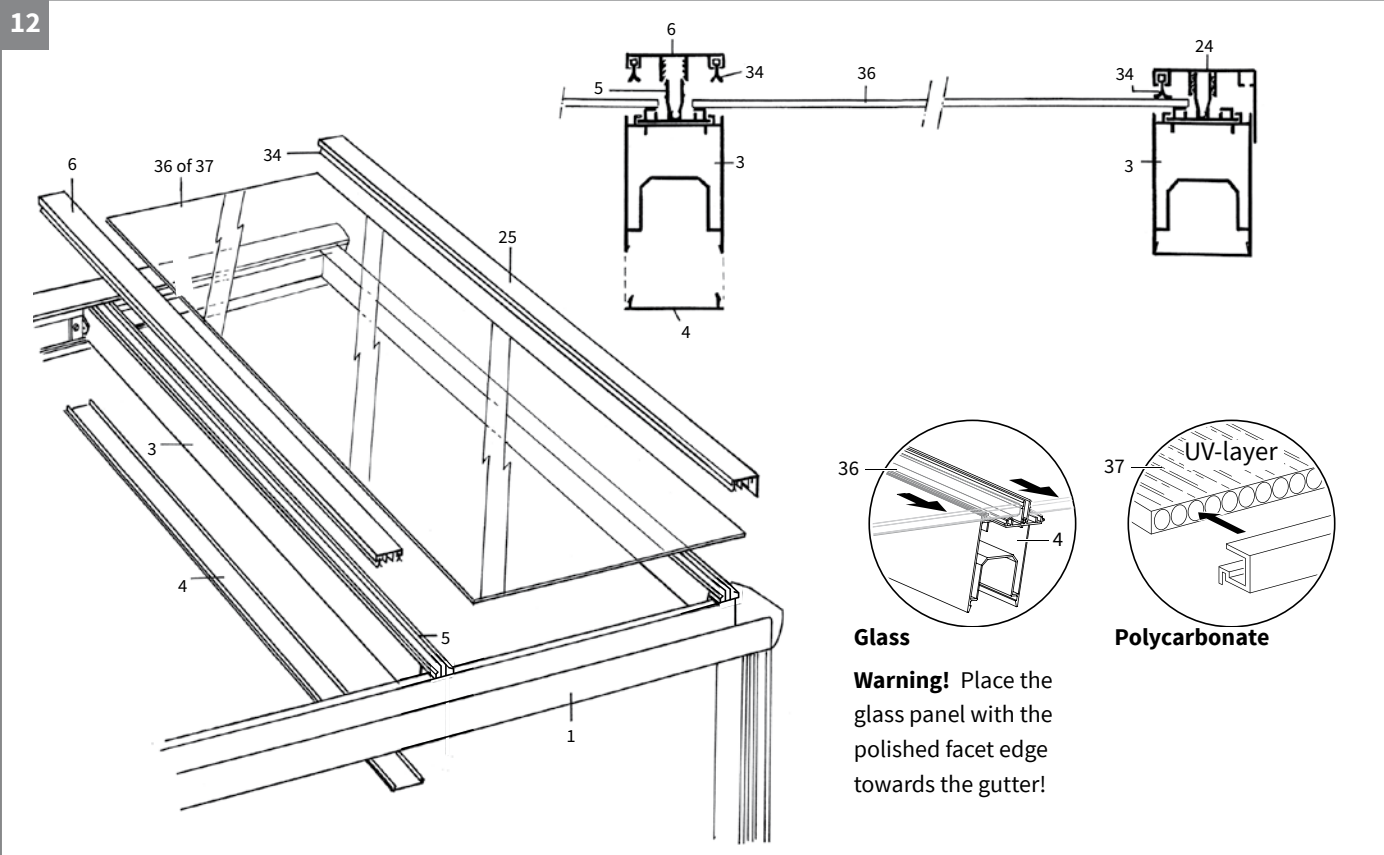

### Mounting the glass or polycarbonate plates

It is important that the glass or polycarbonate plate, is placed in the middle. So divide the space on the left and right proportional and place against the covering cap (19) (at the front above the gutter).

Before mounting first read the information about 'Processing the polycarbonate plates' on page 17.

### Ranking of the roof plates

Starting at the left box (or right box). Place the first roof panel and then install the cover frames.

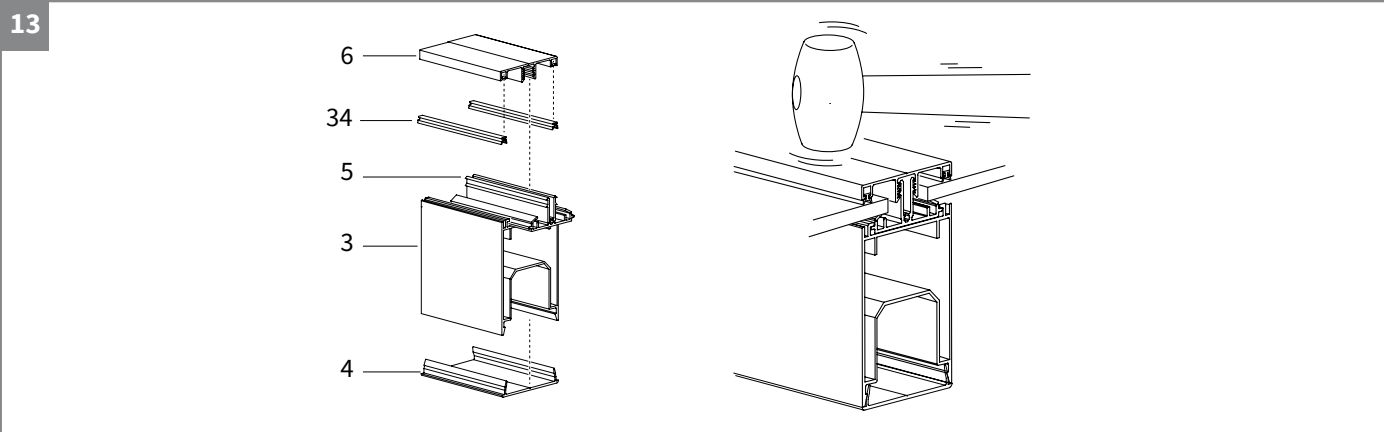

### Install covering frame

- Covering frame (6) including rubber sealing strips (34).
- Install the covering frame (6) by pushing it into the plastic profile (5) . Use a rubber hammer the prevent damages.
- Mount the click profile (4) on the underside of the beams.

## 8. Placing the side plate and rubber

14

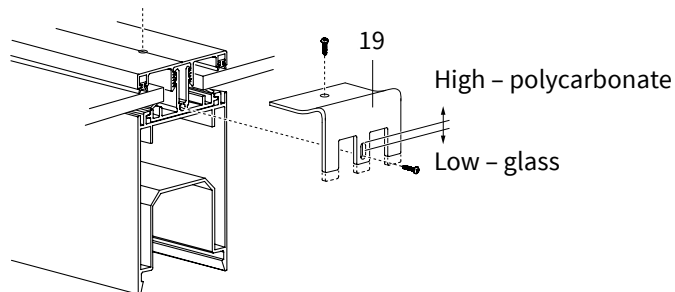

### Mounting the covering cap

Mount the covering cap (19) on the head of the beam. Place a screw on the front side and top side. The cover has two positions: low position is for glass, high position is for polycarbonate.

15

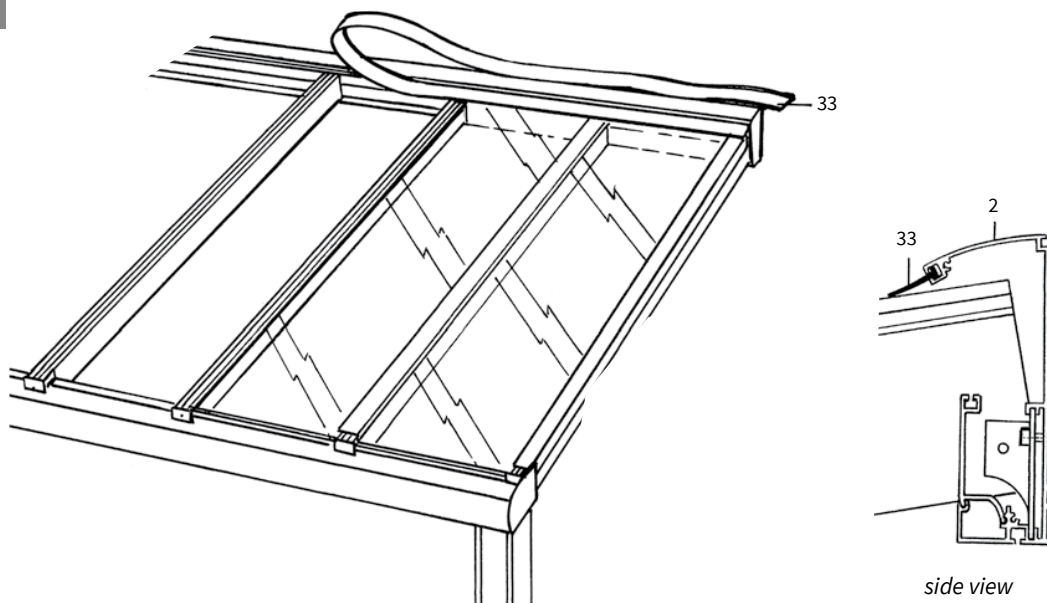

### Install rubber wall profile

It is advisable to place the rubber wall profile (33) directly after installing each glass- or polycarbonate plate and covering frame (6) by pushing it firmly into the slot of the wall profile (2). This can also be done after the roof is finished. However, you can NOT stand on the glass- or polycarbonate plates, only on the beams!



## 8. Finishing

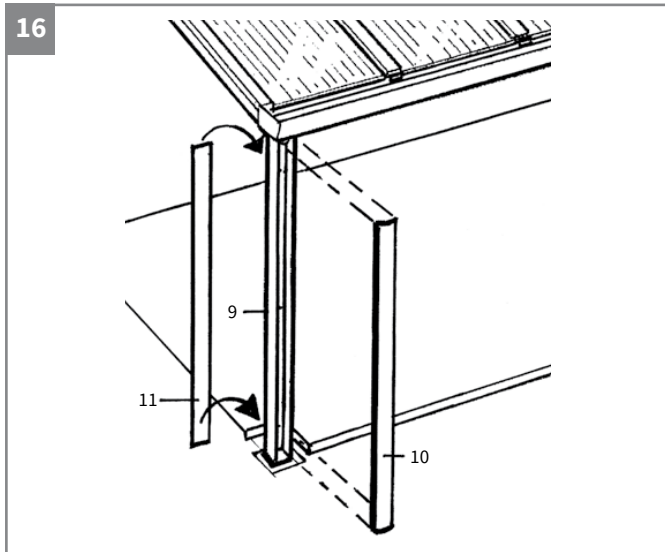

### Locking covering frames upright into place

Click covering frames for upright (10) and (11) into place.

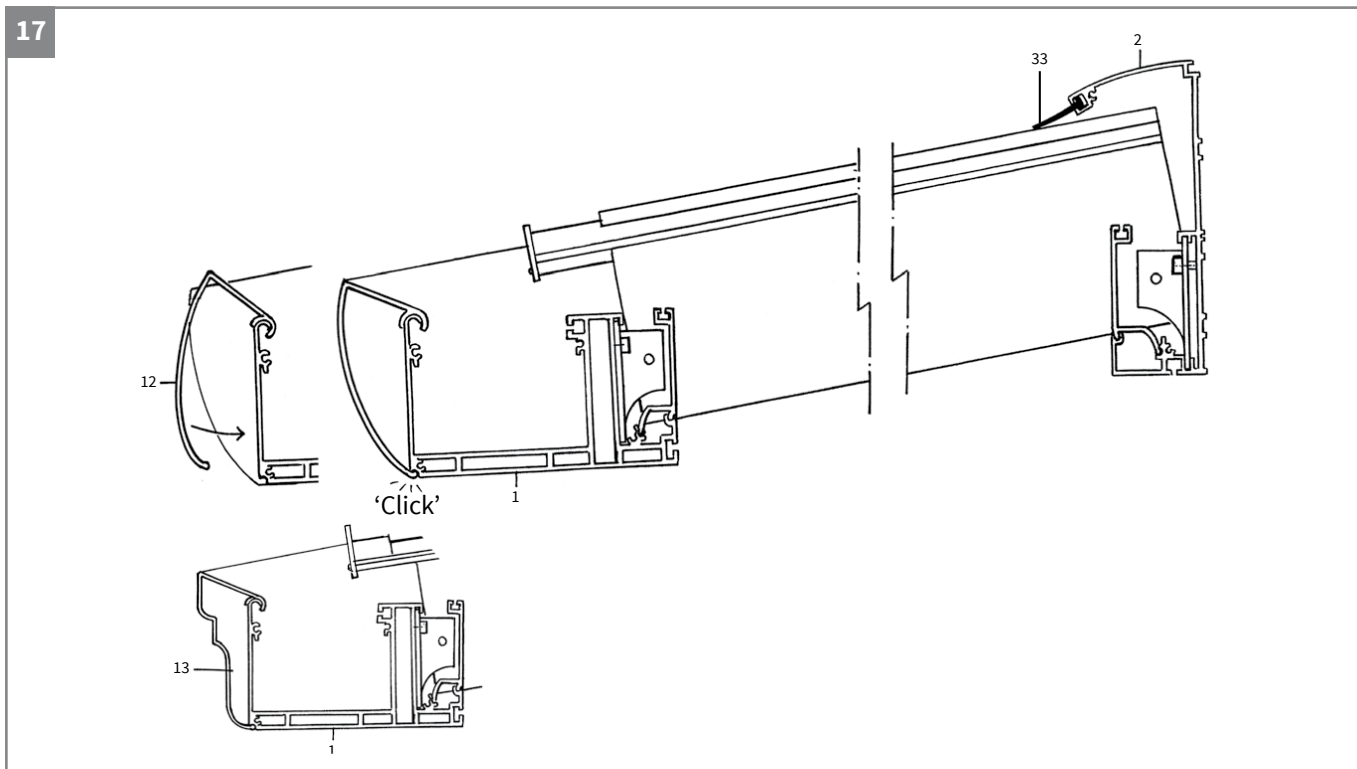

Finally, click the gutter side plate (12) or (13) in front of the gutter.

### Installing covering rubber into wall profile

In case you forgot the place the rubber wall profile (33) then this can still be done now.



We point out explicitly that you can NOT stand on the glass- or polycarbonate plates!  
Use a sturdy shelf and lay this over the beams.

- Press the rubber flap (33) into the groove of the wall profile (2) and over the entire width (see also page 15).
- At the end, cut the rubber flap to the right size.

## Processing the polycarbonate plates

### Storage

If you storage the polycarbonate plates, to plates need to lie on a flat surface, for example pallets. The plates may not be stacked directly on the ground. Avoid direct sunlight and rainwater and cover the plates with a white polythene foil. Storage preferably inside. If outside, then under a roof.

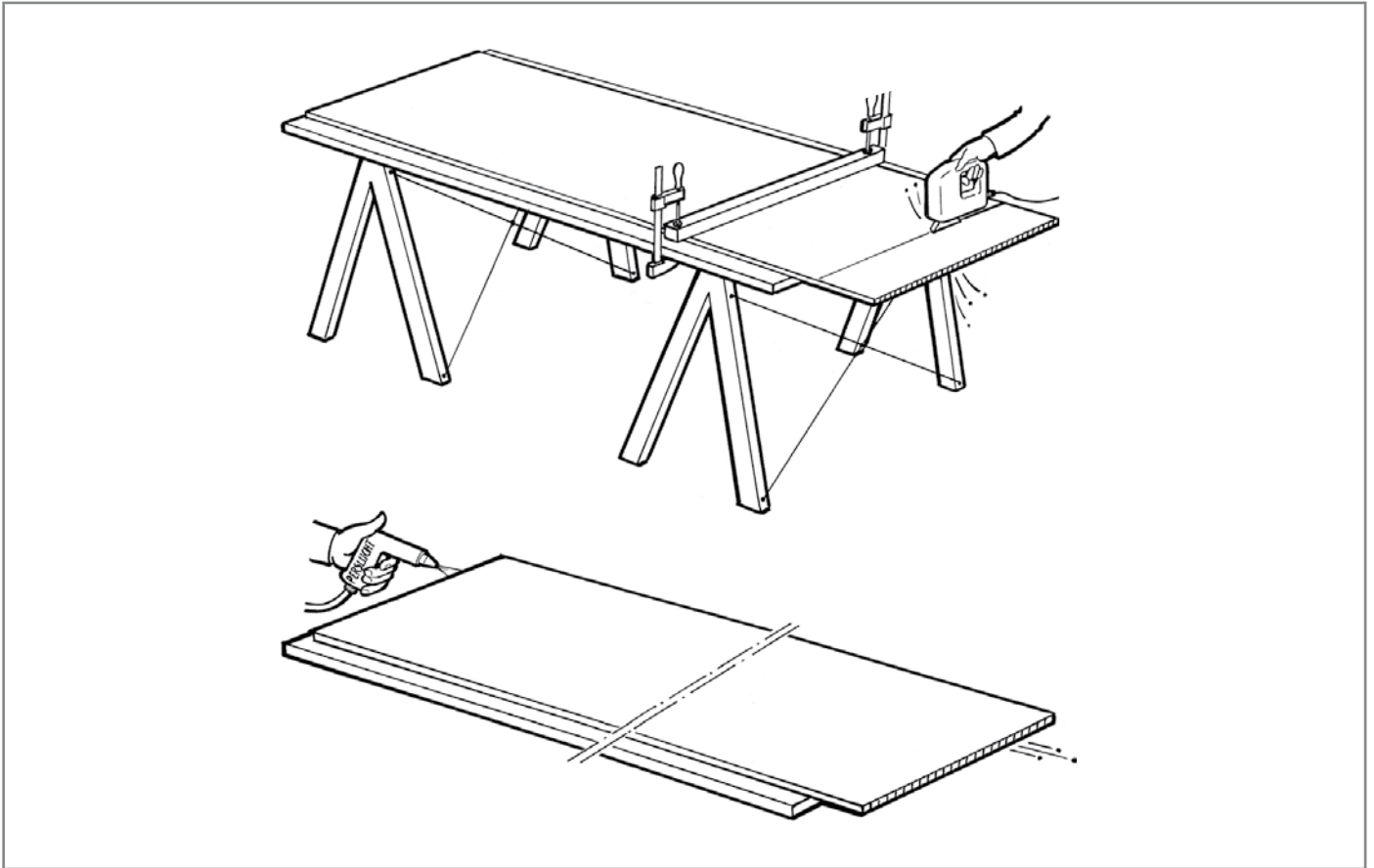

### Sawing

- Saw with a hand circular saw or jig saw with fine-tooth saw blade.  
Use a stable and vibration-free surface and avoid swinging and flapping of the plate.  
Do not remove the protection foil before the sawing and drilling. This prevents scratching on the surface.
- Clean the canals with dry compressed air.
- After that, immediately close with a Anti-dust or transportation tape.

### Backlash and installation

Due to temperature fluctuations, polycarbonate plates can bulb or shrink.  
The plate is blocked against shearing on the underside with an end partition on the cover profile.  
The whole backlash needs to be provided on the upper side.  
The side of the plate needs to have a backlash of 3 mm.

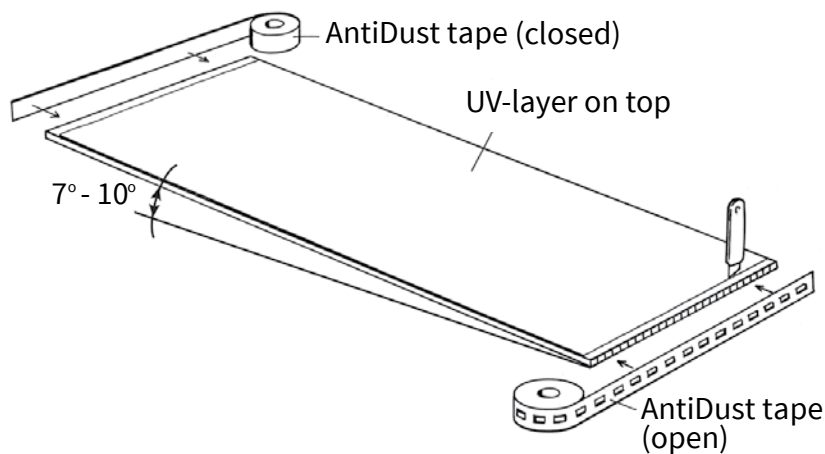

## Sealing against moisture

Polycarbonate is gas- and vapor-permeable, this is the reason that moisture can not be quite prevented. A right slope of the roof between 7° – 10° and an effective sealing can limit this.

- The plates need to be taped on the upper side with a closed Anti-dust tape.
- The underside needs to be taped with a perforated Anti-dust tape.
- If possible, remove a strip of protection foil below and above (approx. 3 cm).
- Cut lightly with an utility knife.

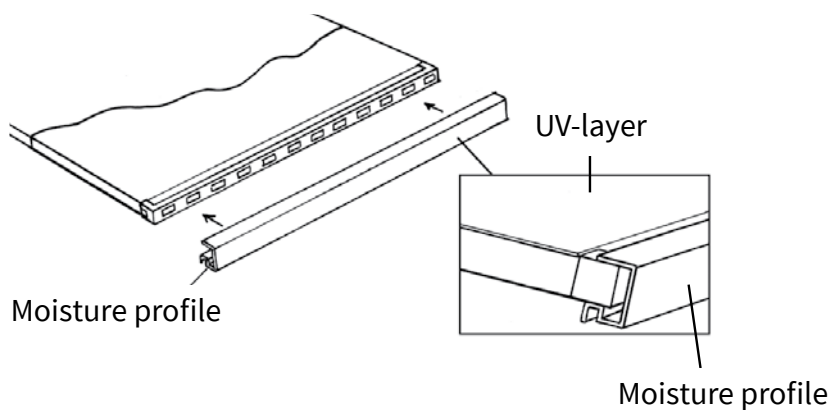

## Placing the moisture profile

After applying the Anti-dust tape, provide the underside of the plate with a moisture profile over the whole width of the plate.

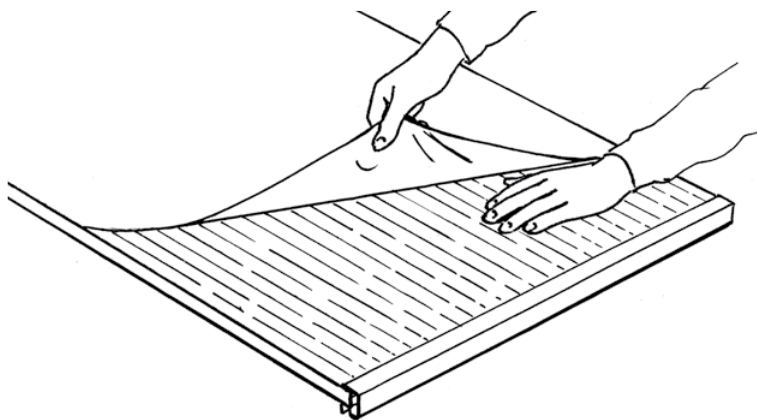

## Removing the protection foil of the UV-layer

After applying the moisture profile, the polycarbonate plate can be installed. The removing of the UV protection foil can be done after mounting, but also before mounting. It is more easy and more safe to remove it before mounting. You do not need to be on the roof to do this.

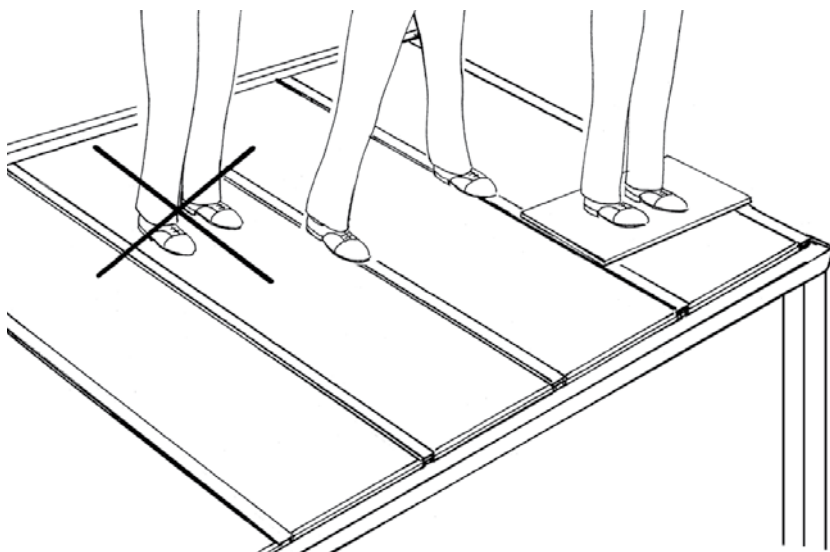

## Do not stand on the polycarbonate plate

The polycarbonate plates are solid and strong, but not resisted enough against concentrated load. Do not walk on the plates! Only walk on the edges where beams and cover strips are or use a shelf.

## Cleaning

- Clean the polycarbonate plates at least once a year with tepid water and soap. If necessary, use non-alkaline soap in combination with a telescopic car brush.
- Use a soft brush or sponge.
- Never use abrasives or solvents!
- Before- and after rinsing with a lot of water and at last clean with a soft cloth.



Registration number TÜV The Netherlands QA B.V.: 1231

Verano BV  
Bedrijfsweg 8  
5683 CP Best, Nederland

Certificate number:  
1231-CPR-1090-1-2400-A-293

## EN 1090-1:2009 + A1:2011

Aluminium parts, to be applied in veranda's according to order:  
see sticker on the back of this installation manual

<b>Tolerance on geometric data:</b>	EN 1090-3
<b>Weldability:</b>	N.A.
<b>Fracture toughness:</b>	not for aluminium products
<b>Reaction to fire:</b>	material classification: class A1
<b>Cadmium emissions:</b>	NPD
<b>Radioactive radiation:</b>	NPD
<b>Durability:</b>	surface powder coated according quality class 3
<b><u>Constructive properties:</u></b>	
<b>Deadweight:</b>	design according EN 1990 (Eurocode 1) and EN 1999 (Eurocode 9): reference order noted on sticker on the back of this installation
<b>Distortion in serviceability limit state:</b>	NPD
<b>Fatigue resistance:</b>	NPD
<b>Fire retardend:</b>	Class A1
<b>Fabrication:</b>	according to part specifications; reference order noted on sticker on the back of this installation manual and EN 1090-3, EXC1