

General warning

Installation of this product is at your own risk. Use this installation instruction only as an assistance and only with the installation of this specific product. If you can not install this product yourself, you can always opt for professional installation. Your dealer's installation team is always ready to assist you.

Tips before measuring

Check the (installation) surface

For installing the Lüderitz windscreen, the surface must meet certain requirements:

- The windscreen may only be installed on a solid surface.
- Note if there are no protruding parts or other obstacles in the way.
- For the installment of the windscreen, it is important that the surface is horizontal level.
- If the floor is not level, you can opt for post extension. The uprights are sunk into the bottom of the surface.

(see 'Post extension' on page 3)



Warning! Keep free space for maintenance

Take possible future service- and maintenance proceedings into account during the placement of the windscreen. Keep free the space at the top and the side of the fixed part for maintenance.

This product is provided with a motor. The motor is installed on the left- or right side in the bottom profile of the fixed part. Make sure that the motor can be replaced if any defects occur.

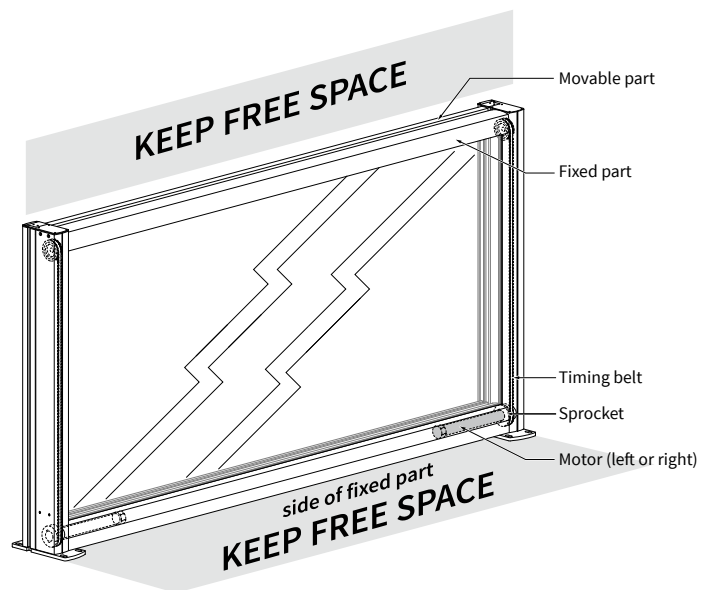

The Lüderitz is not suitable as a balustrade!

A balustrade is a low fence or wall that with a difference in height, people, who are located on the high side, helps to protect against falling. A balustrade is obliged with a height difference of 1 meter.

The Lüderitz windscreen should never be used as a substitute for a balustrade. It must only be placed against a balustrade, on the high side!

With a height difference of 1 meter or more, the windscreen should be implemented with layered safety glass.

Never clamp in between two walls!

The Lüderitz windscreen should never be clamped in between two walls. Clamping the windscreen can damage the windscreen or impede its operation. You should leave at least 1mm space, both at the right as at the left side.



With regard to stability and wind loading, preferably to place the sliding part on the outer side (windward side).

Windward side

(also the control side)

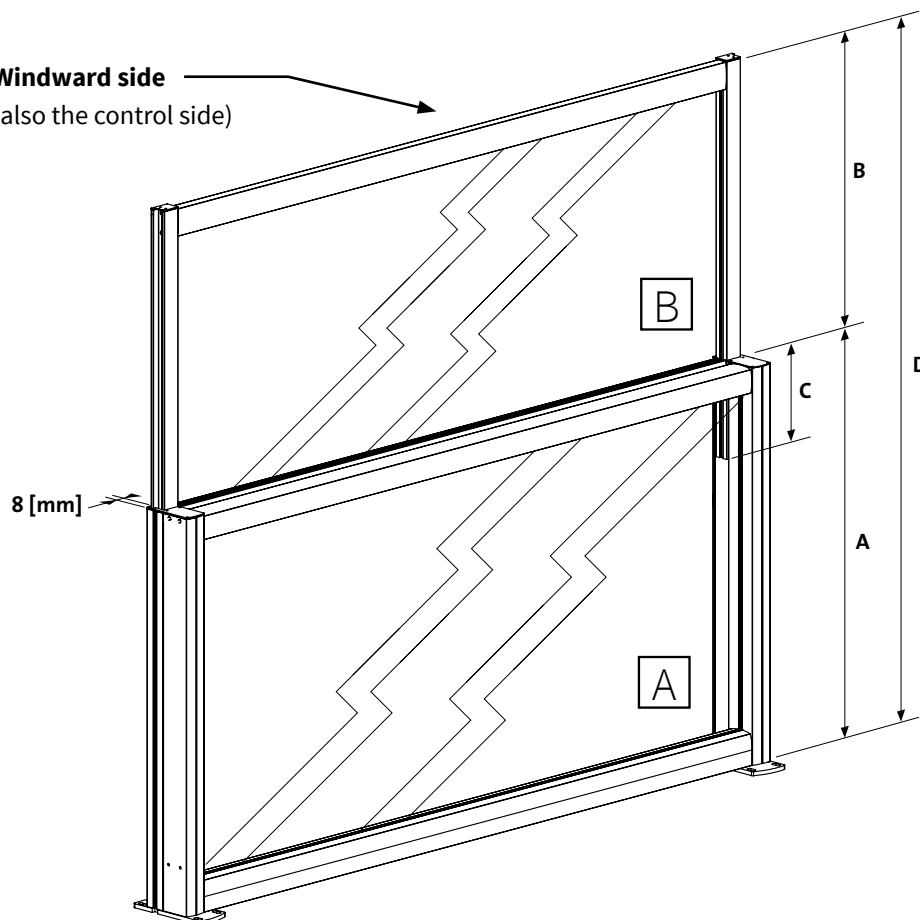

Size of mounting foot

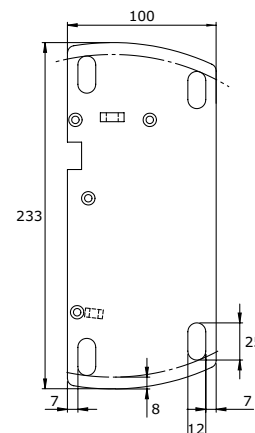

Thickness mounting foot: 10 [mm]

Warning!

A is always measured without mounting foot and closing caps.

D = order size

Width

min. 840 mm - max. 3000 mm

Height

min. 1500 mm - max. 2500 mm

Determination of the height based on D

D = Total height

A = Total height ÷ 2 + 127 [mm]

C = Fixed size (minimum 254 [mm])

B = A - 254 [mm] of D ÷ 2 - 127 [mm]

Determination of the height based on A

A = Height fixed part

D = A x 2 - 254 [mm]

B can always smaller, never higher, except if part B may protrude part A in the lower position.

Control side

left or right

The control side is the side where the motor is located.

This side is always seen from the frontside of the sliding part.

Warning! Except for a balcony alignment this side is always seen from the side with the fixed part!

Optional:

Ongoing vertical upright* The upright of the fixed part extends to where the sliding part stops.

Post extension* In this way height differences in the subsurface can be catered.

Blind link The Lüderitz windscreen can be linked blind.

* see detailed explanation on page 3

Ongoing vertical upright

The Lüderitz windscreen can be supplied with a ongoing vertical upright (optional). You should make this choice in advance, when ordering the product. Adjusting the uprights afterwards is not possible.

Windproof

A major advantage of the ongoing uprights is that when the windscreens are linked they will become windproof. In the standard uprights there is a gap of 10mm between the upper sliding parts. With the Lüderitz with ongoing uprights there is no gap.

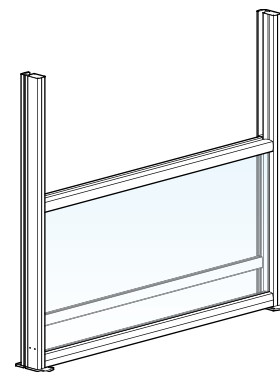

Ongoing uprights

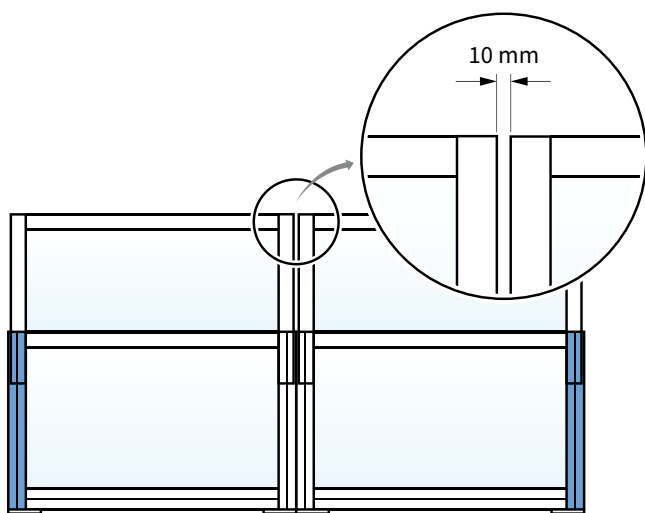

Gap with standard uprights

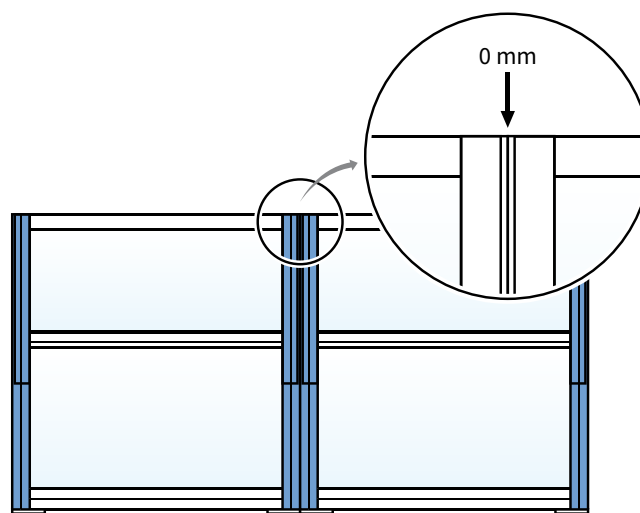

Windproof with ongoing uprights

Post extension

If you have a terrace with sloping pavement, you must install the windscreen recessed. The uprights of the Lüderitz can be extended at the bottom with a required amount (x) of millimeters. In this way height differences in the subsurface can be catered. You should make this choice in advance, when ordering the product. Adjusting the uprights afterwards is not possible. Important is that the windscreen remains level.

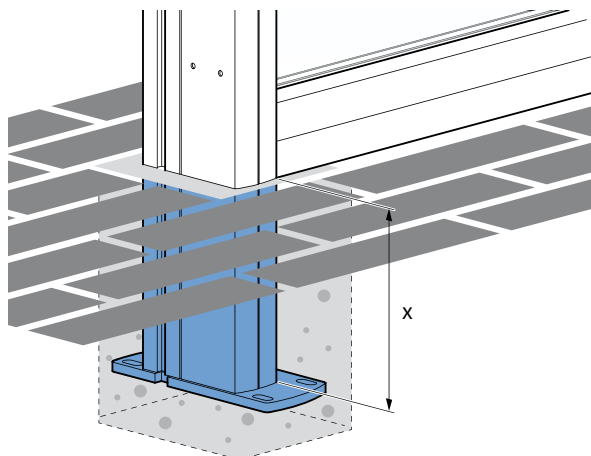

Post extension at the bottom side

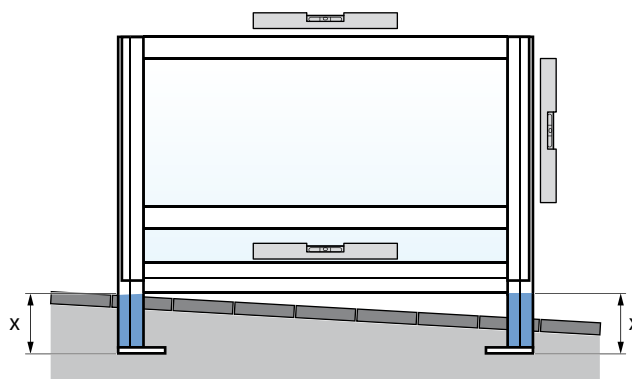

specify extra lenght X when ordering
X = 200, 300, 400, 500, 600, 700 or 900 mm

Dimensions of various setups

A = width of the windscreen

V = fixed part

S = sliding part

L = operating side left

R = operating side right

O = opening between the windscreens



Warning!

The operating side is the side where the motor is located.

This side is always seen from the side with the sliding part (S).

Sizes in mm

1 - Standard alignment single

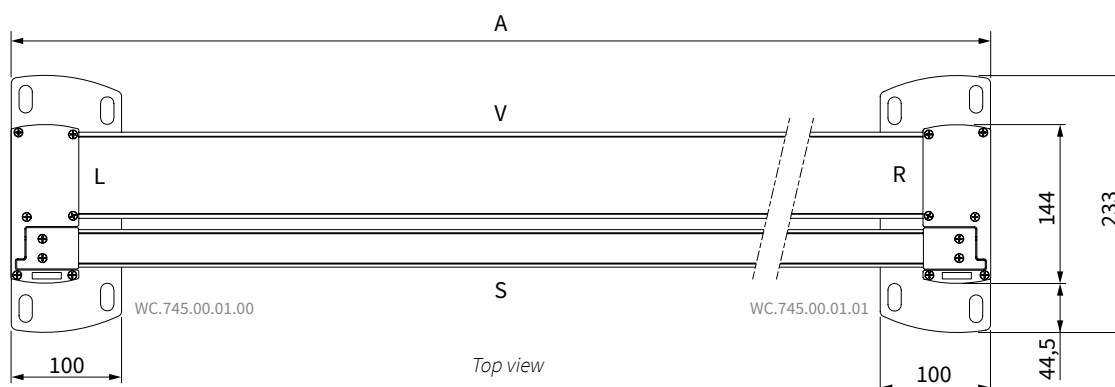

2 - Standard alignment multiple

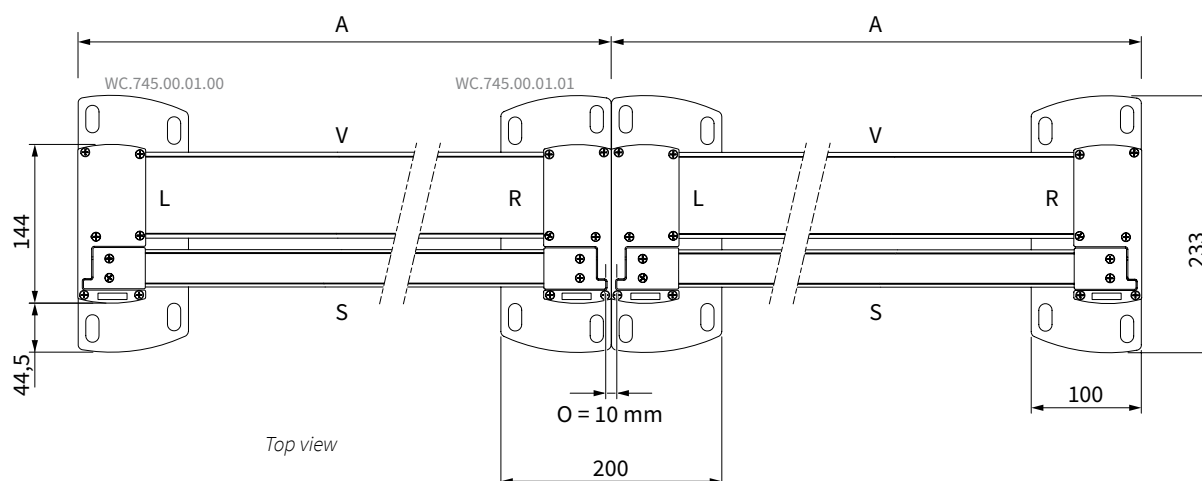

Warning!

If you want to order a windscreen with a Somfy Altus 50 RTS motor?

Never place two motor sides together. This may cause malfunction!

3 - Corner alignment, sliding part at the inside

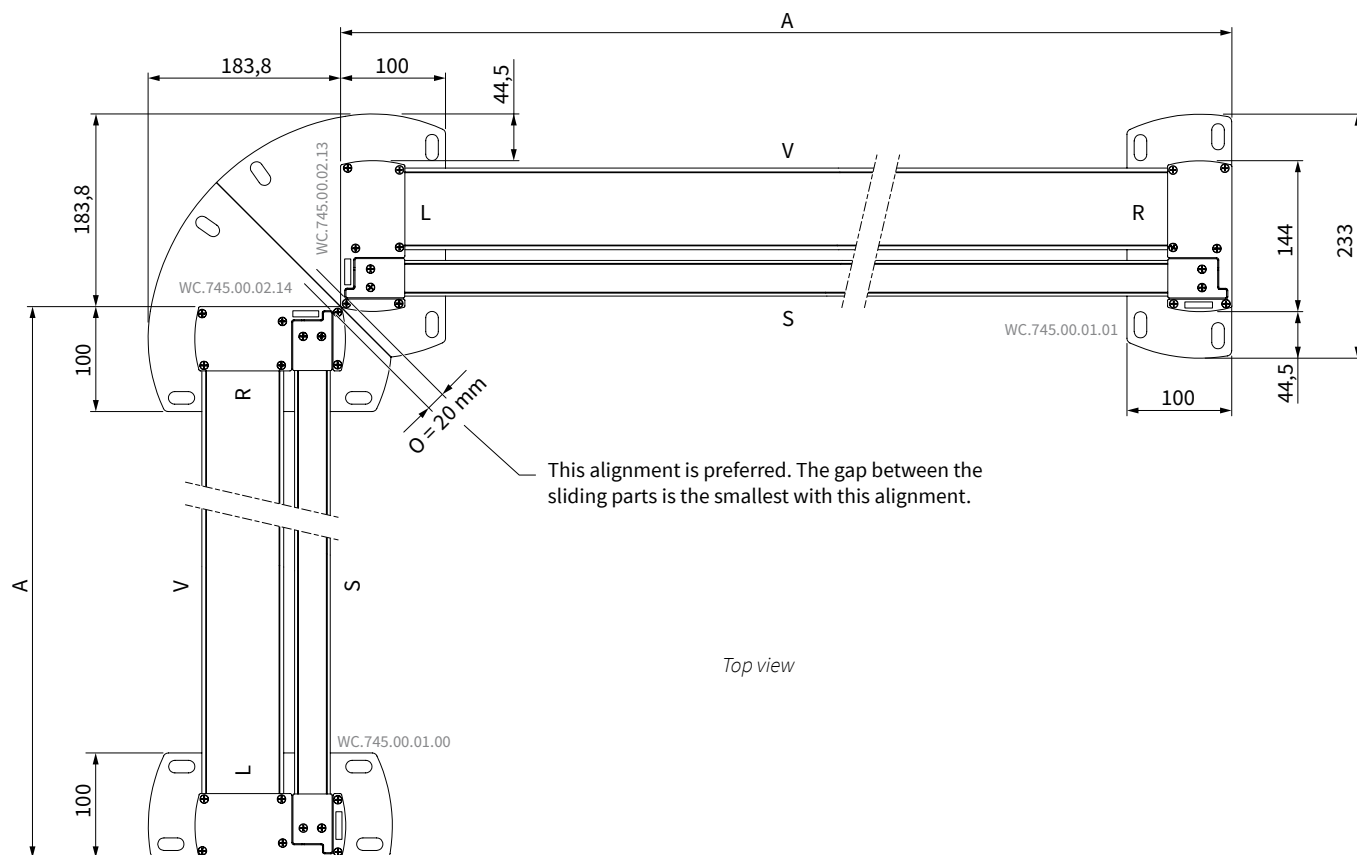

4 - Corner alignment, sliding part at the outside

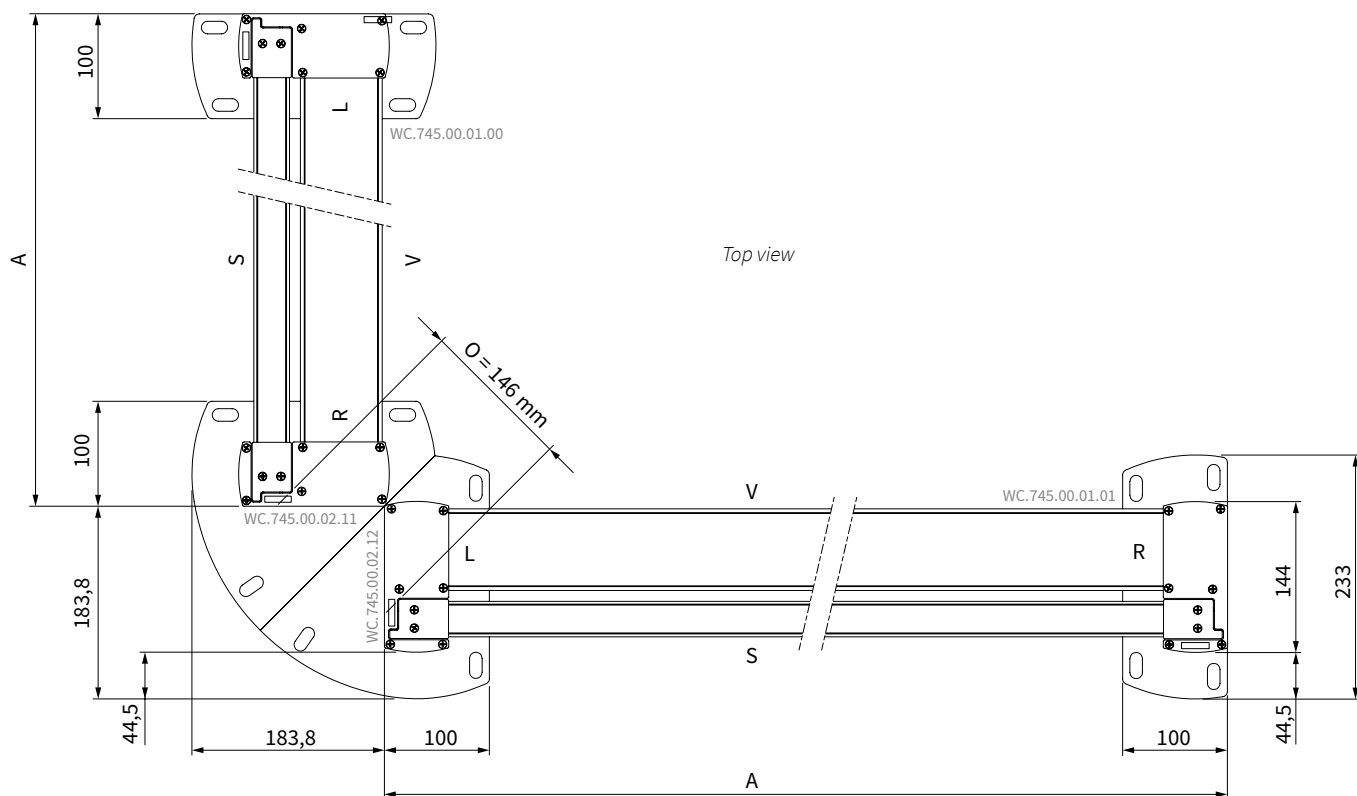

5 - U-alignment, sliding part at the inside

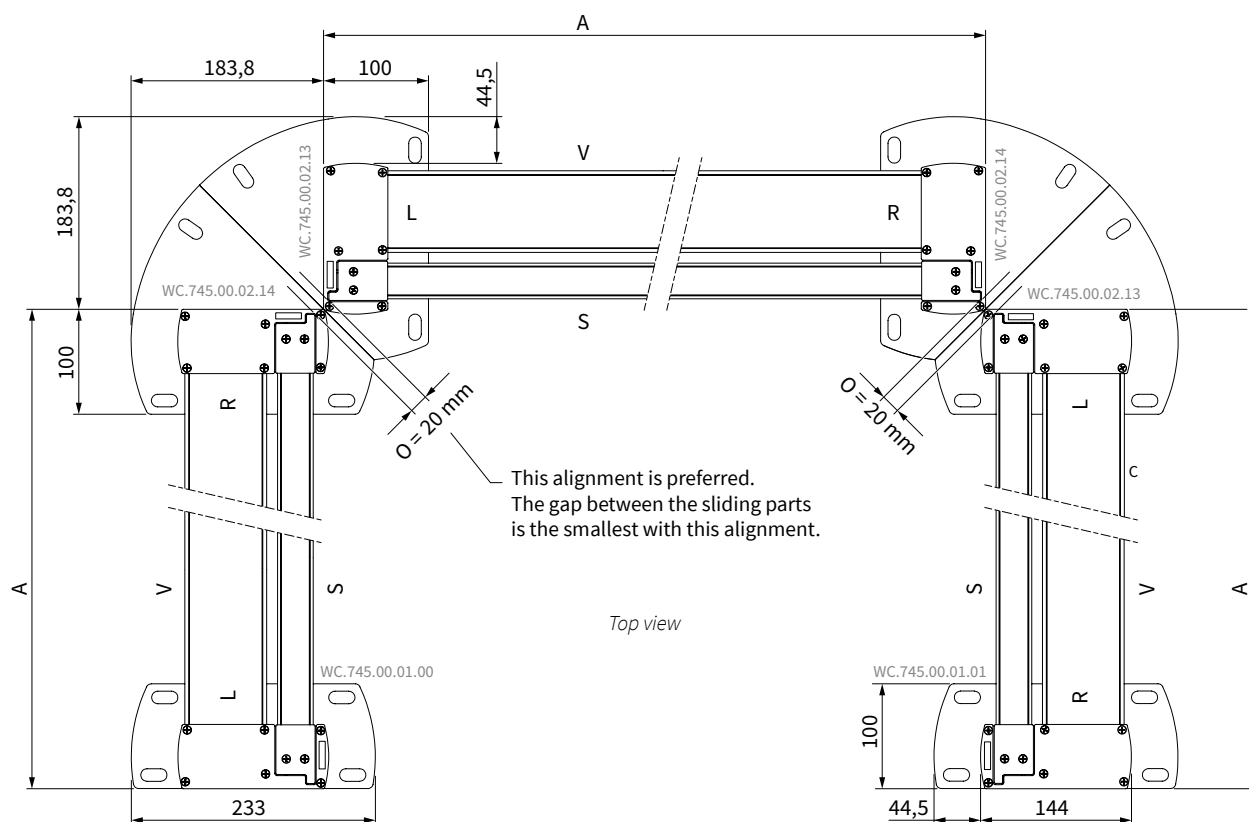

6 - U-alignment, sliding part at the outside

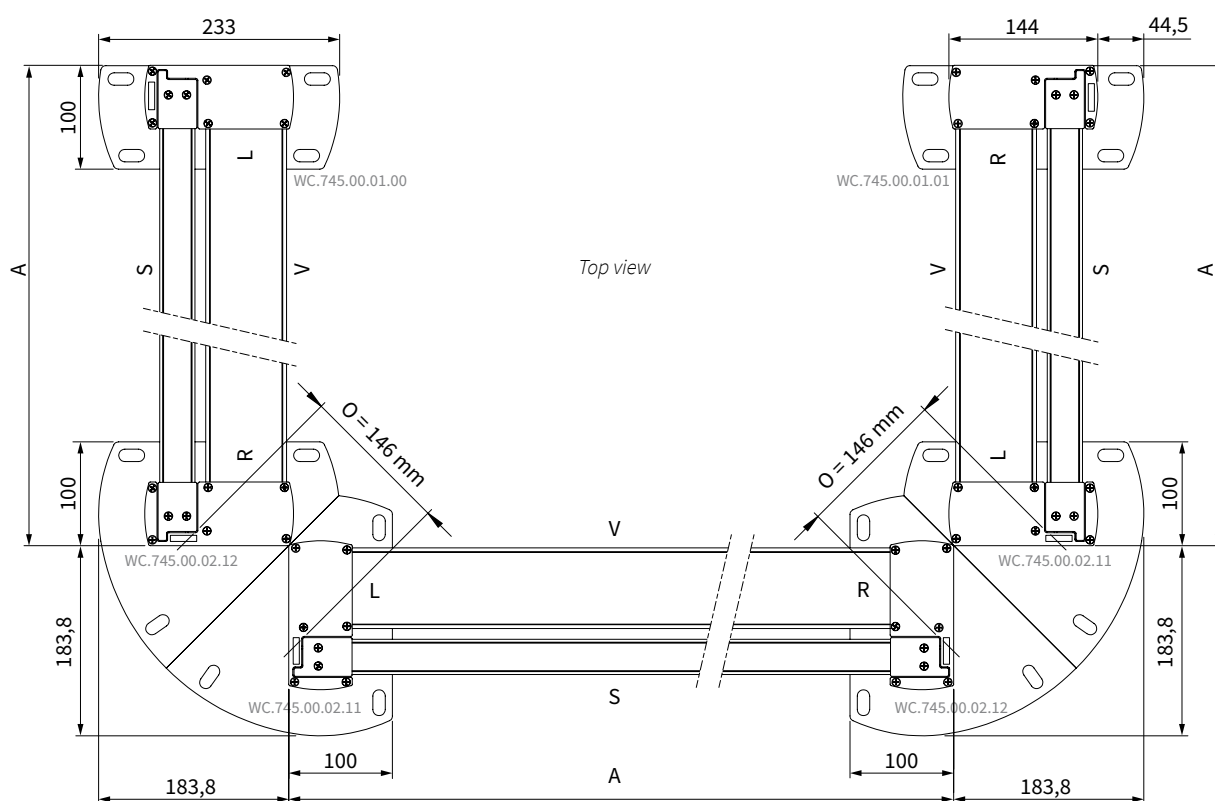

7 - Balcony alignment, sliding part at the inside

A = width of the windscreen

$V =$ fixed part

B = sliding part

W = windward side (outside)

L = operating side left

R = operating side right

0 = opening between the windscreens



Warning!

The operating side is the side where the motor is located. With a balcony alignment this side is always seen from the side with the fixed part (V).

Sizes in mm

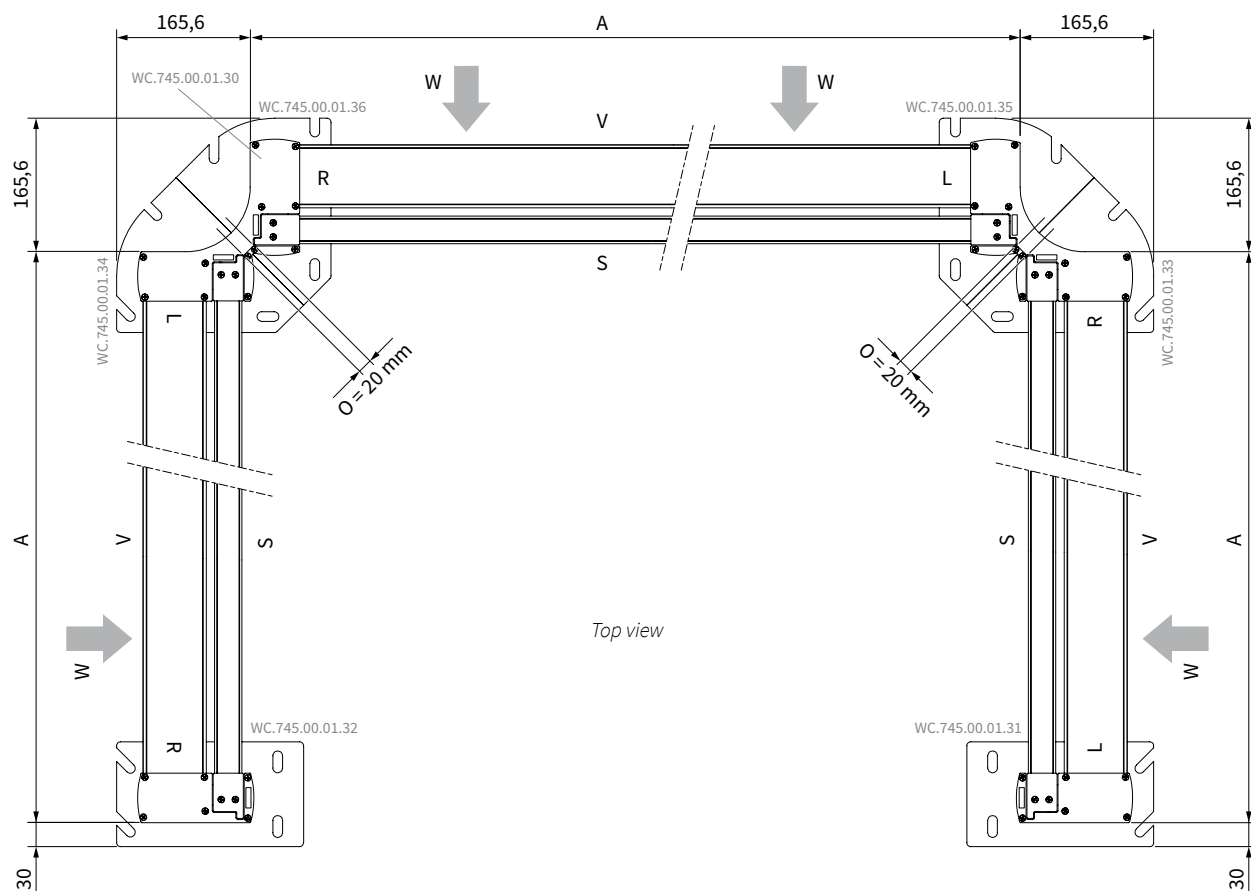

Special feet

The Lüderitz windscreen is with balcony alignment provided with special feet. Because on a balcony the space between windscreen and railing is very small, fitting the feet is very difficult. Therefor the special balcony feet are provided with slot-holes, so that they can be placed over the nut or bolt. For installation instructions, see page 14.

Be aware with linking the straight part!

When you want to link the straight parts on a balcony, you should use the standard footplates instead of the special balcony feet.

Linking corner

To provide extra stability to the windscreen in a corner, the fixed uprights can be linked with a ongoing covering plate.



WC.745.00.01.30

Feet specifications

1 - Standard alignment

Mounting foot standard left
WC.745.00.01.00

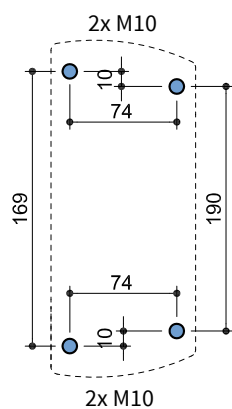
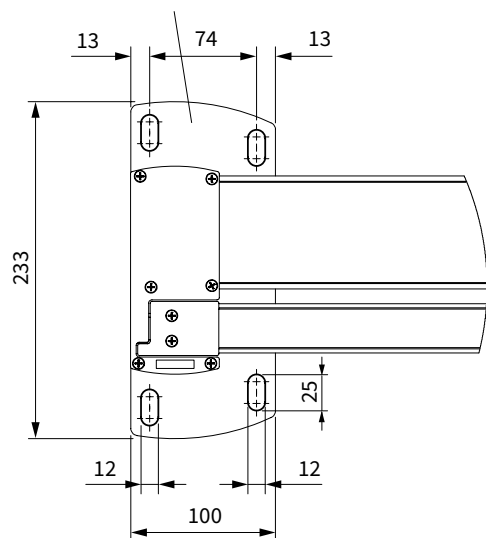

Position holes for mounting
footplates

Mounting foot standard right
WC.745.00.01.01

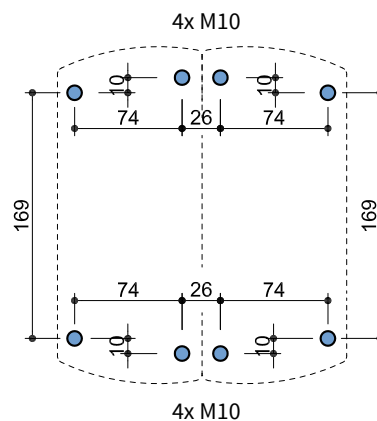
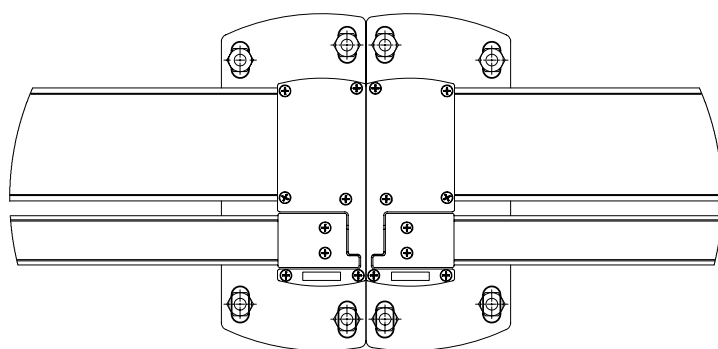
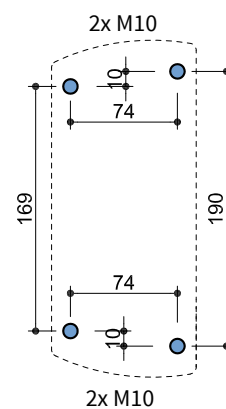
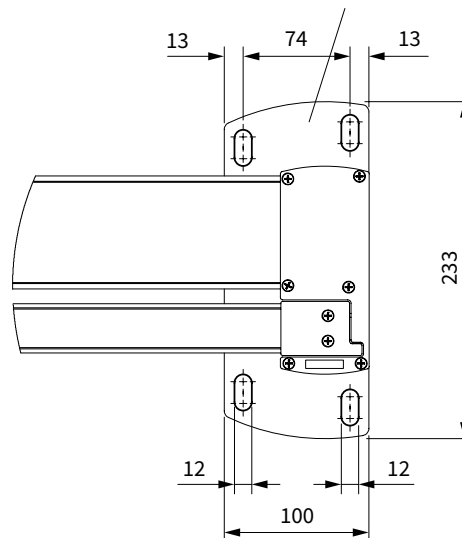

Position holes for mounting
footplates

2 - Corner- and U-alignment

Sliding part at the outside

Mounting foot from
the right corner
WC.745.00.02.12

Mounting foot from
the left corner
WC.745.00.02.11

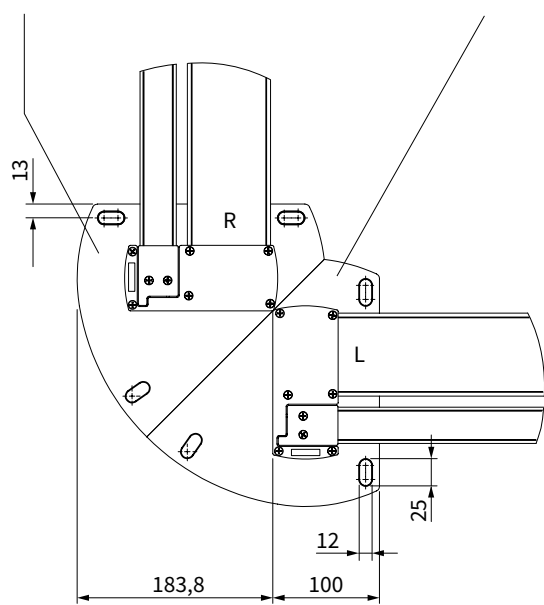

Sliding part at the inside

Mounting foot from
the left corner
WC.745.00.02.13

Mounting foot from
the right corner
WC.745.00.02.14

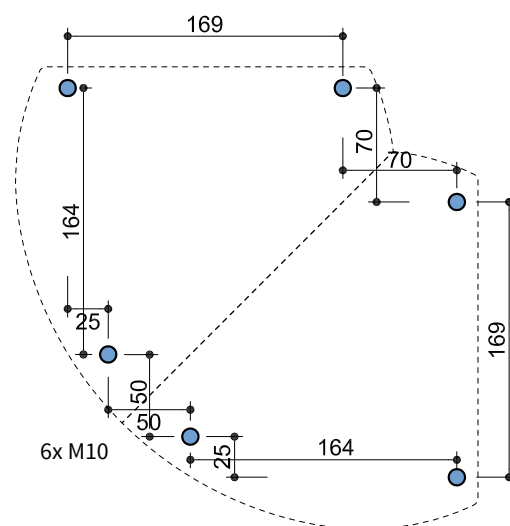
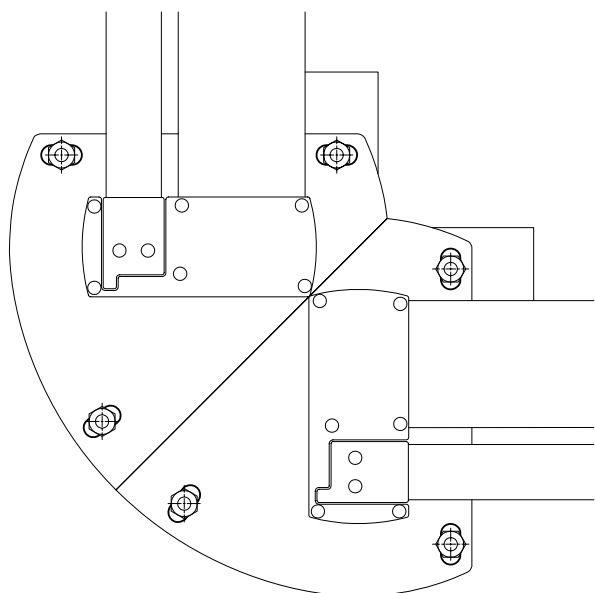
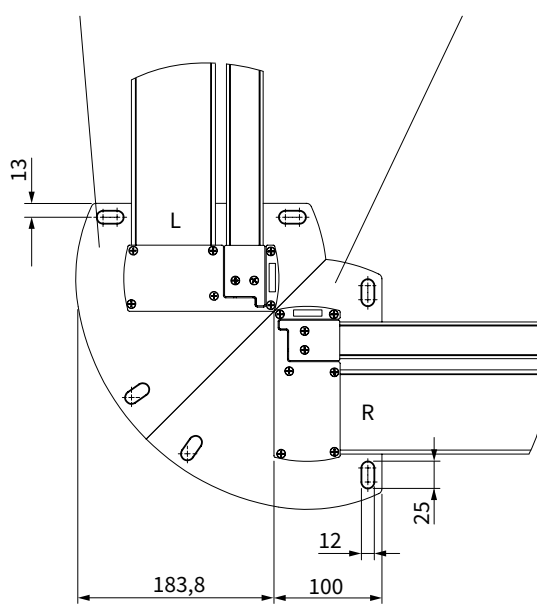

Position holes for mounting
footplates

3 - Balcony alignment

Sliding part at the inside

Balcony foot side wing, right, at the back WC.745.00.01.31

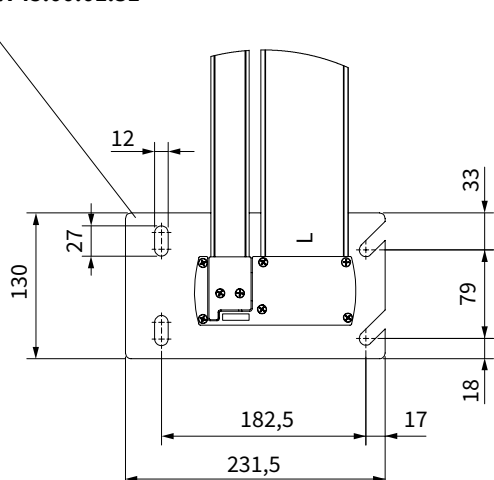

Balcony foot side sing, left, at the back WC.745.00.01.32

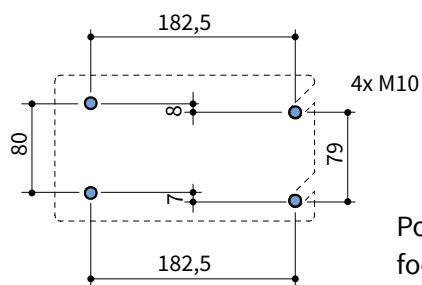
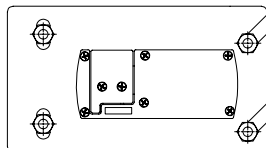
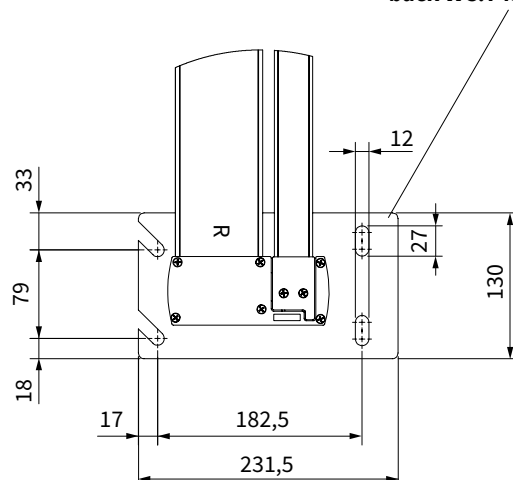

Position holes for mounting footplates

Sliding part at the inside

**Balcony foot, right,
at the front
WC.745.00.01.35**

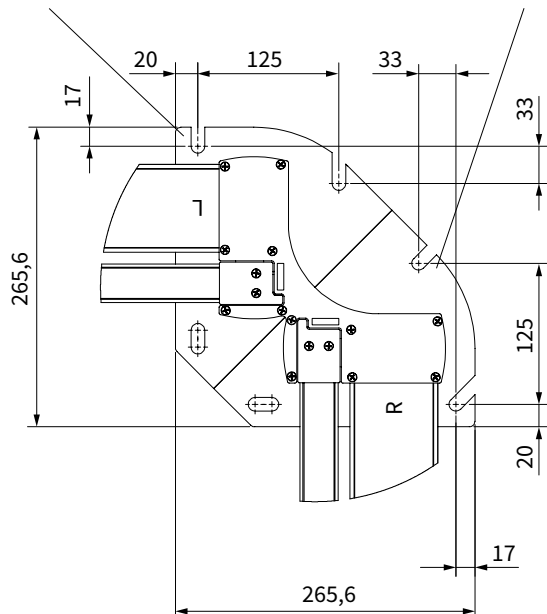

**Balcony foot side wing,
right, at the front
WC.745.00.01.33**

**Balcony foot side wing,
left, at the front
WC.745.00.01.34**

**Balcony foot, left,
at the front
WC.745.00.01.36**

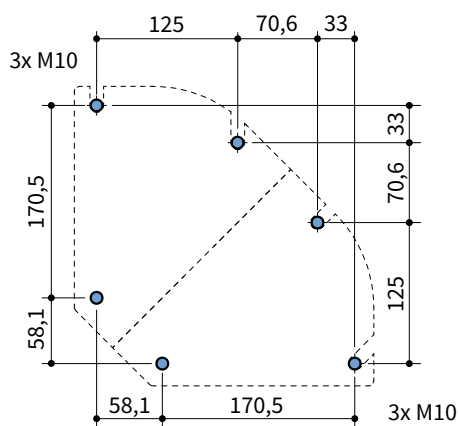
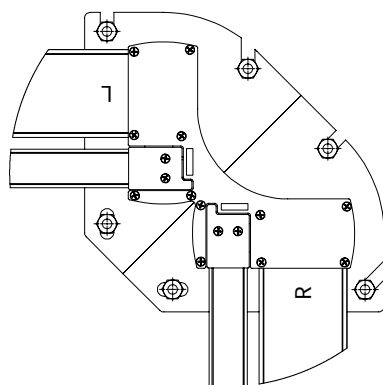
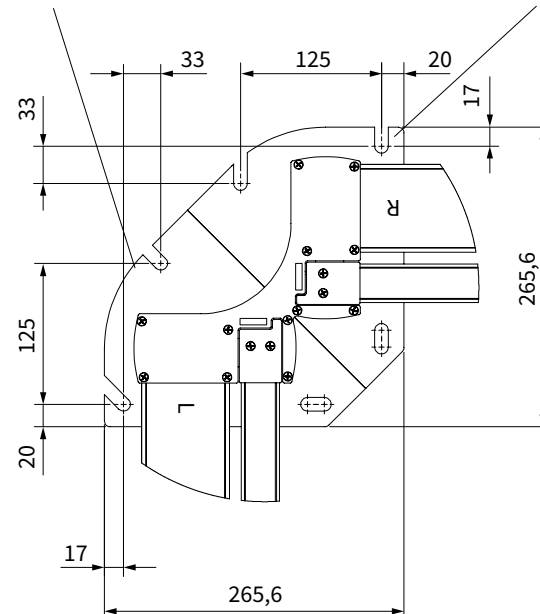

**Position holes for mounting
footplates**